

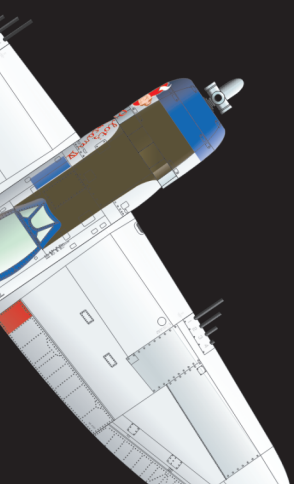

INSTRUCTION SHEET

DOTTIE MAE P-47D

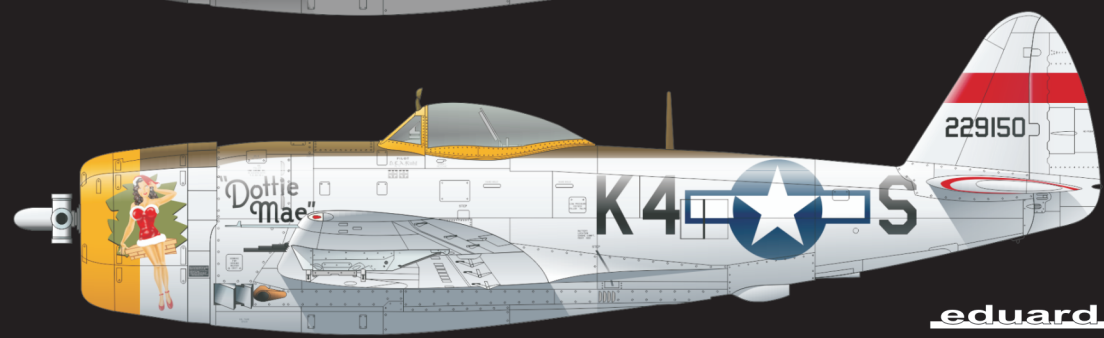

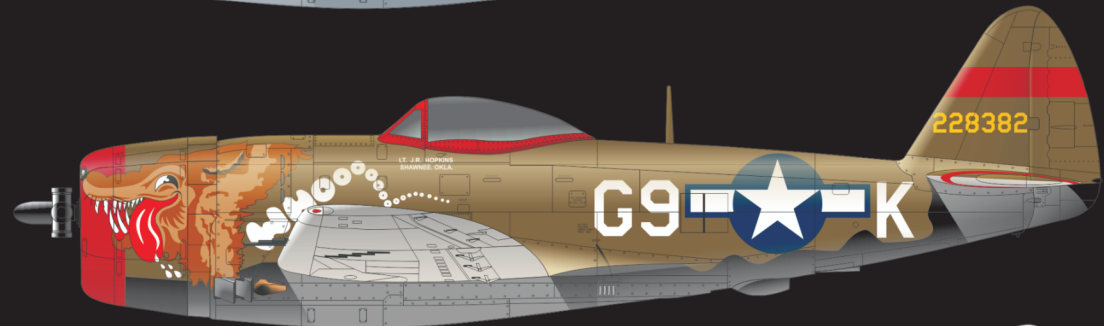
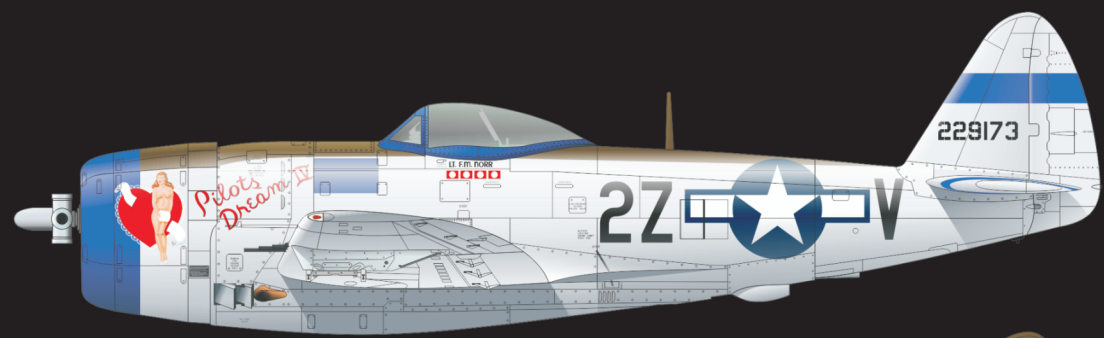

Carefully read instruction sheet before assembling. When you use glue or paint, do not use near open flame and use in well ventilated room. Keep out of reach of small children. Children must not be allowed to suck any part, or pull vinyl bag over the head.



Před započítím stavby si pečlivě prostudujte stavební návod. Při používání barev a lepidla pracujte v dobře větrané místnosti. Lepidla ani barvy nepoužívejte v blízkosti otevřeného ohně. Model není určen malým dětem, mohlo by dojít k požití drobných dílů.

INSTRUCTION SIGNS * INSTR. SYMBOLS * INSTRUKTION SINNBILDEN * SYMBOLES * 記号の説明



OPTIONAL
VOLBA



BEND
OHNOUT



OPEN HOLE
VYVRTAT OTVOR



SYMMETRICAL ASSEMBLY
SYMETRICKÁ MONTÁŽ



REMOVE
ODŘÍZNOUT



REVERSE SIDE
OTOČIT



APPLY EDUARD MASK
AND PAINT
POUŽÍT EDUARD MASK
NABARVIT

PARTS



DÍLY



TEILE



PIÈCES



部品

A>

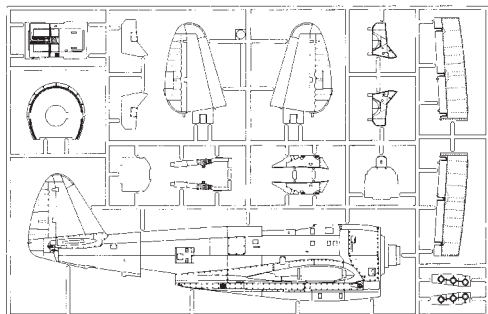

B>

PLASTIC PARTS

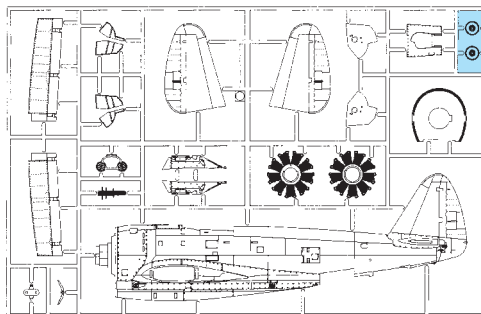

E>

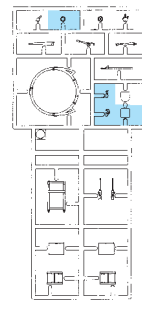

F>

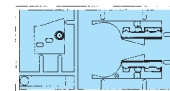

G>



J>



C>

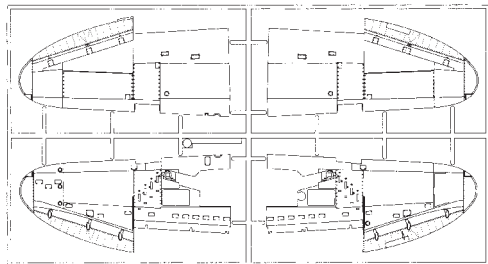

D>

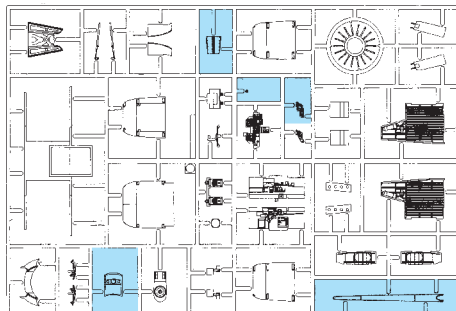

L>

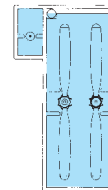

M>



N>



Q>

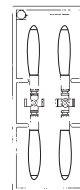

R> 2 pcs.

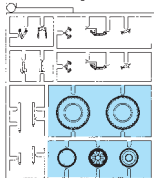

S>

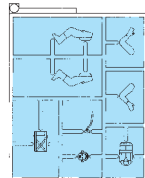

T>

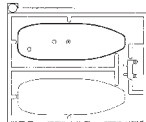

U> 2 pcs.

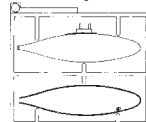

V> 2 pcs.

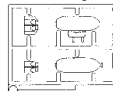

X>

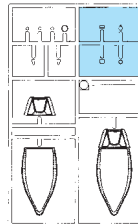

P-1>



P-2> 2 pcs.

eduard
MASK

FILM

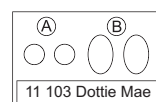

RP - RESIN PARTS

eduard
BRASSIN

R1 2 pcs.



R2 2 pcs.



R3

PE - PHOTO ETCHED DETAIL PARTS

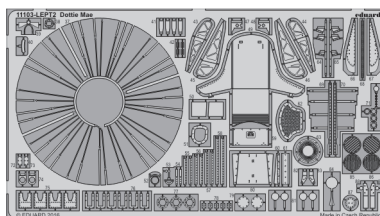
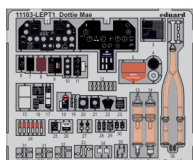

-Parts not for use. -Teile werden nicht verwendet. -Pièces à ne pas utiliser. -Tyto díly nepoužívejte při stavbě. - 使用しない部品

COLOURS



BARVY



FARBEN



PEINTURE



色

GSI Creos (GUNZE)		
AQUEOUS	Mr.COLOR	
H 2	C2	BLACK
H 3	C3	RED
H 5	C5	BLUE
H 8	C8	SILVER
H 12	C33	FLAT BLACK
H 18	C28	STEEL
H 37	C43	WOOD BROWN
H 47	C41	RED BROWN
H 52	C12	OLIVE DRAB
H 53	C13	NEUTRAL GRAY
H 76	C61	BURNT IRON

AQUEOUS	Mr.COLOR	
H 77	C137	TIRE BLACK
H 90	C47	CLEAR RED
H 92	C49	CLEAR ORANGE
H 93	C50	CLEAR BLUE
H 316	C316	WHITE
H 327	C327	RED
H 329	C329	YELLOW
	C351	ZINC-CHROMATE
	C352	CHROMATE YELLOW
Mr.COLOR SUPER METALLIC		
SM01		SUPER FINE SILVER

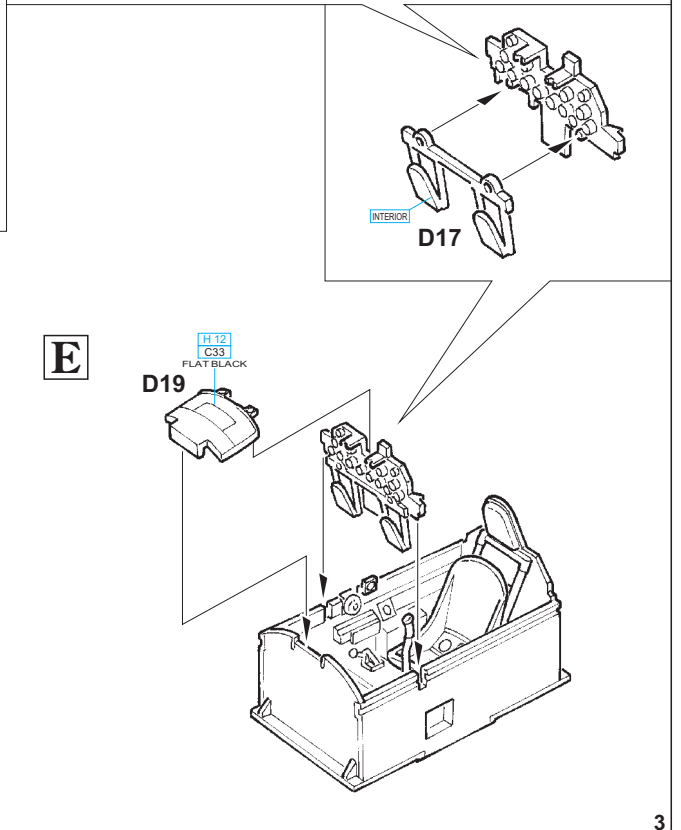
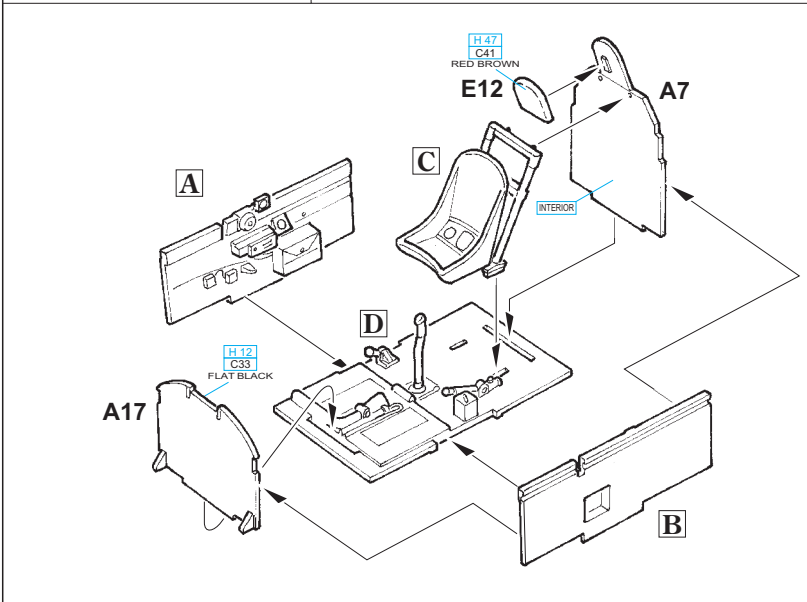
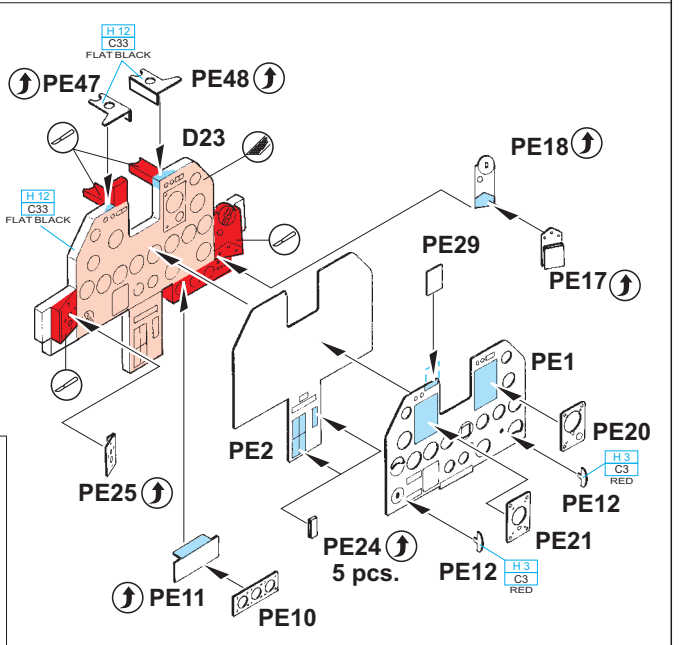
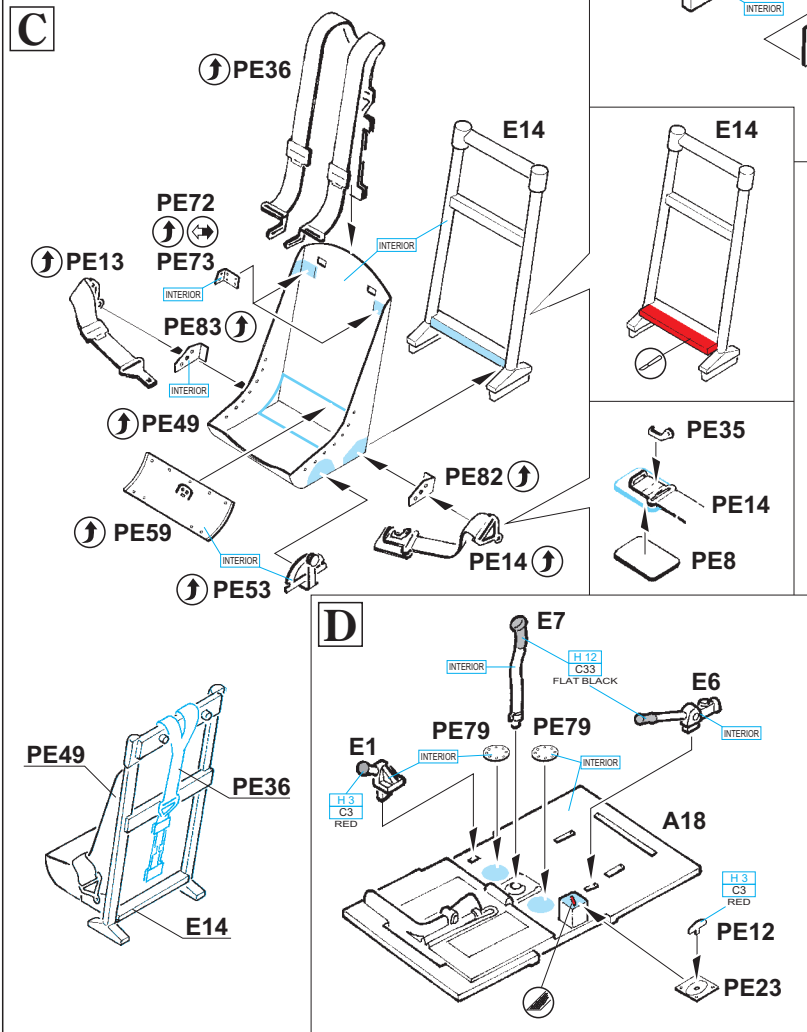
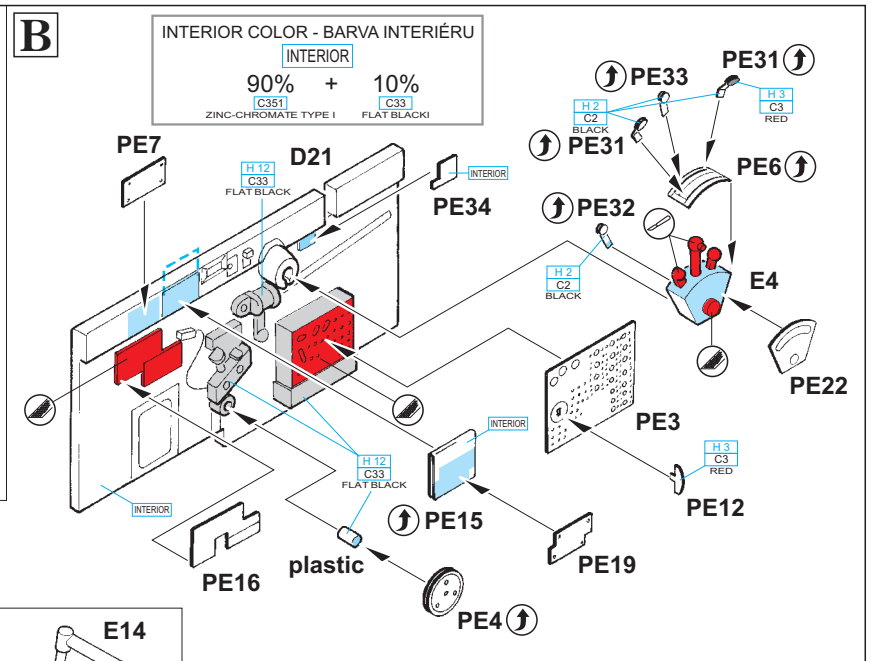
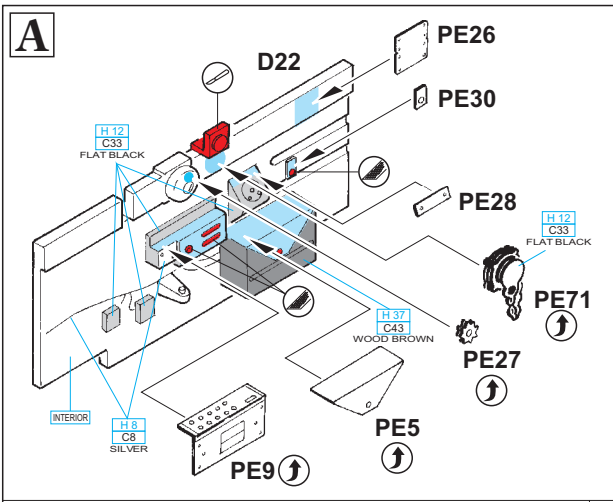

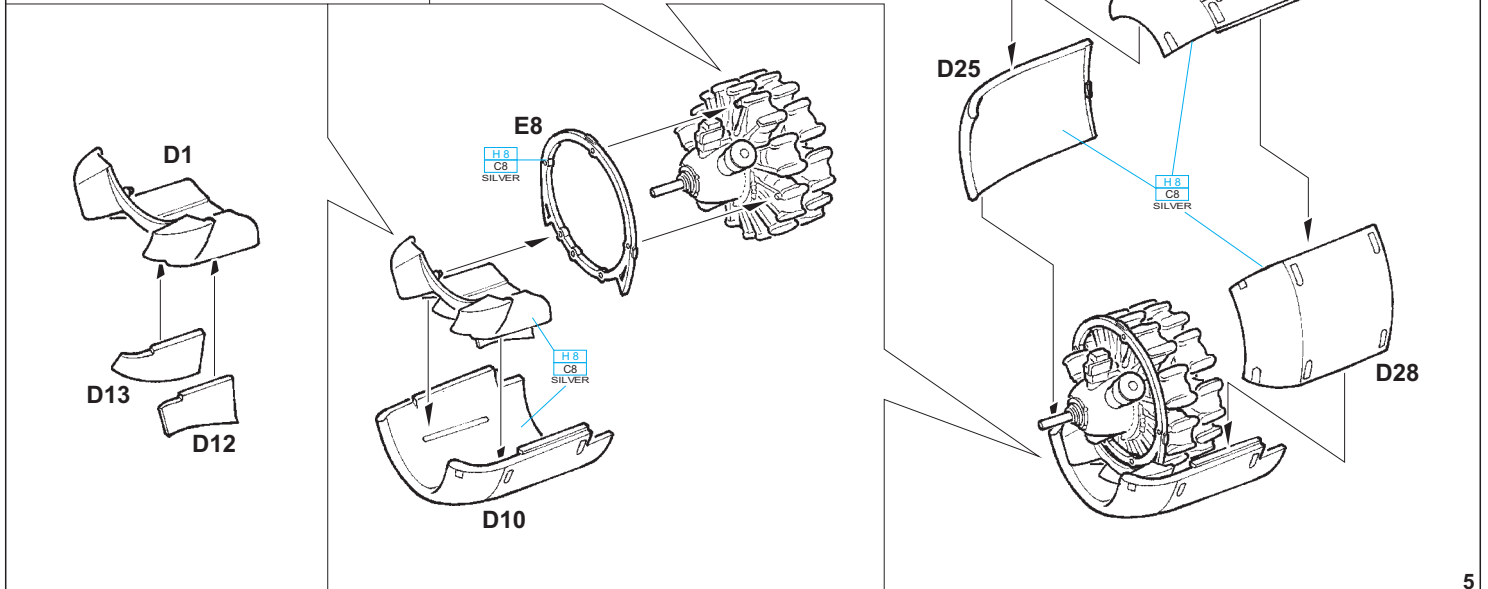
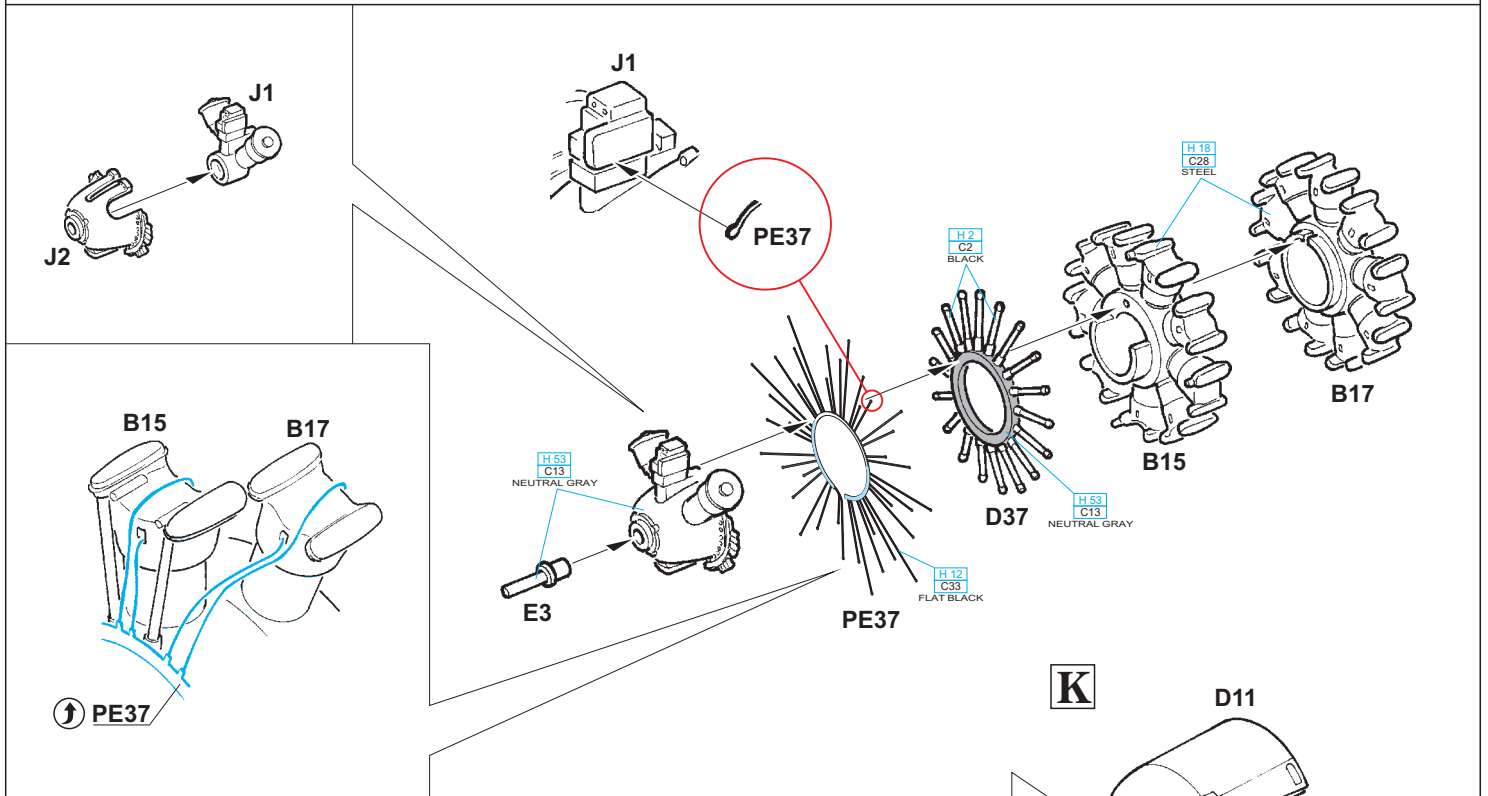
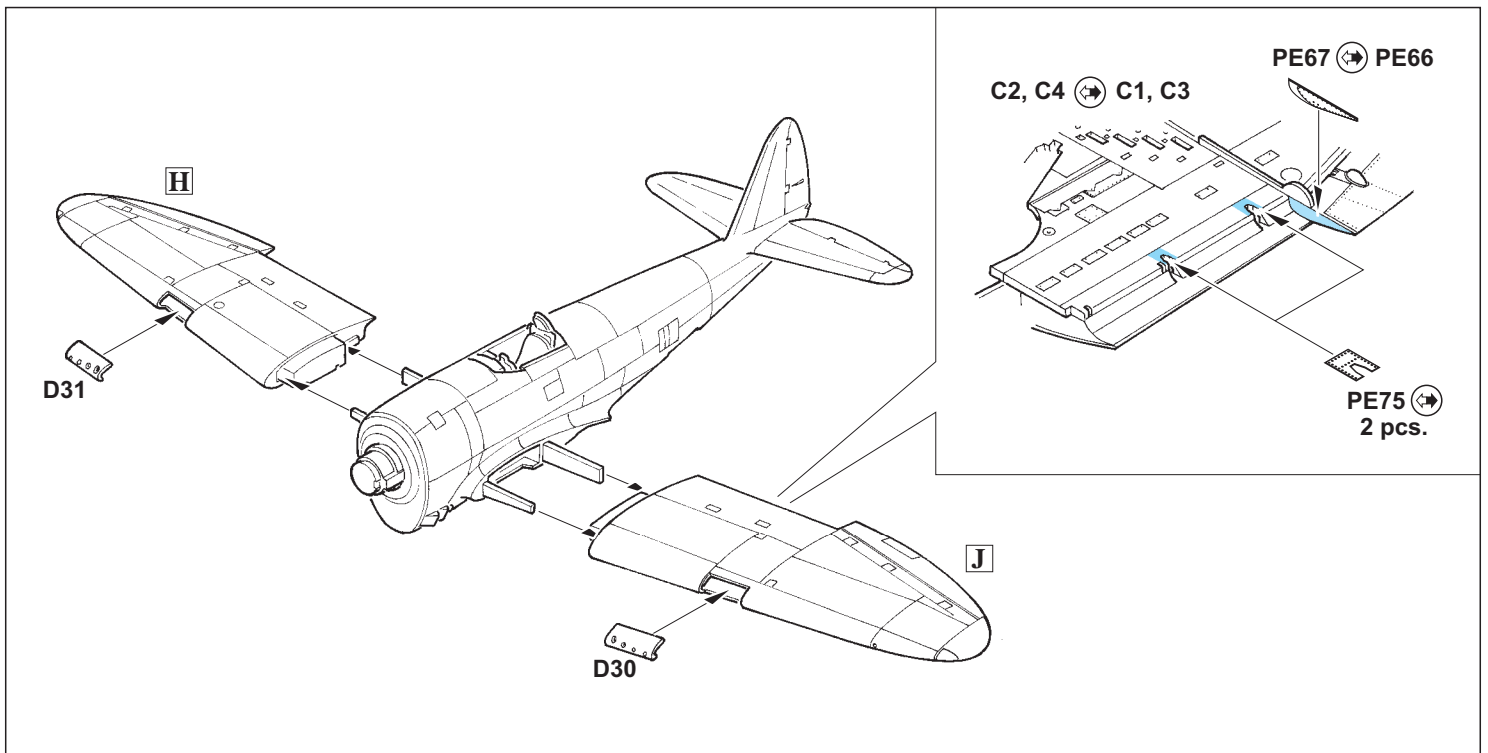

Open
A19

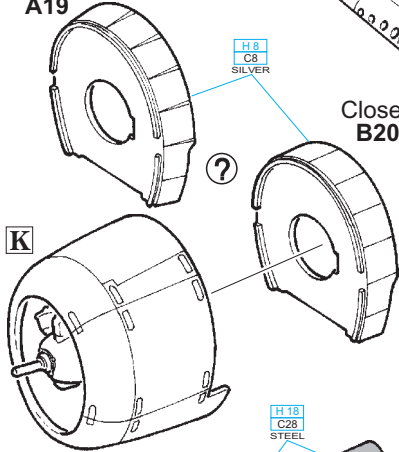

Closed
B20

PE85

H 8
C8
SILVER

PE62

H 18
C28
STEEL

B7

H 8
C8
SILVER

PE86

H 18
C28
STEEL

PE57, 58
PE55, 56

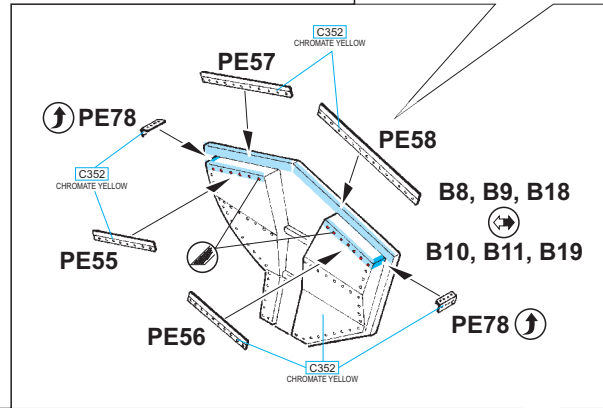

L **eduard**
BRASSIN 2 pcs.

RP1

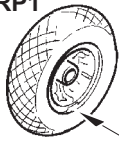

RP2

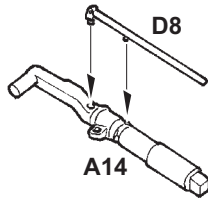

D8

A14

L

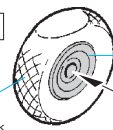

H 77
C137
TIRE BLACK

R2

H 18
C28
STEEL

R1

H 18
C28
STEEL

A14

H 8
C8
SILVER

H 52
C12
OLIVE DRAB

MARKING B ONLY

D40

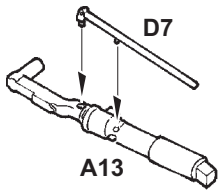

D7

A13

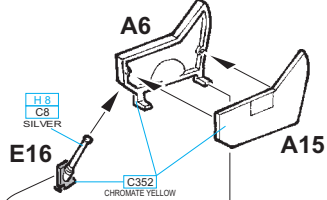

A6

A15

H 8
C8
SILVER

E16

C352
CHROMATE YELLOW

A13

H 18
C28
STEEL

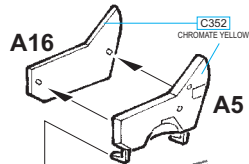

A16

C352
CHROMATE YELLOW

A5

H 8
C8
SILVER

E15

C352
CHROMATE YELLOW

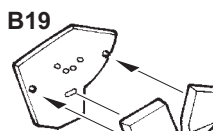

B19

H 77
C137
TIRE BLACK

L

B10

R1

H 18
C28
STEEL

A13

H 18
C28
STEEL

R2

D39

MARKING B ONLY

H 52
C12
OLIVE DRAB

M

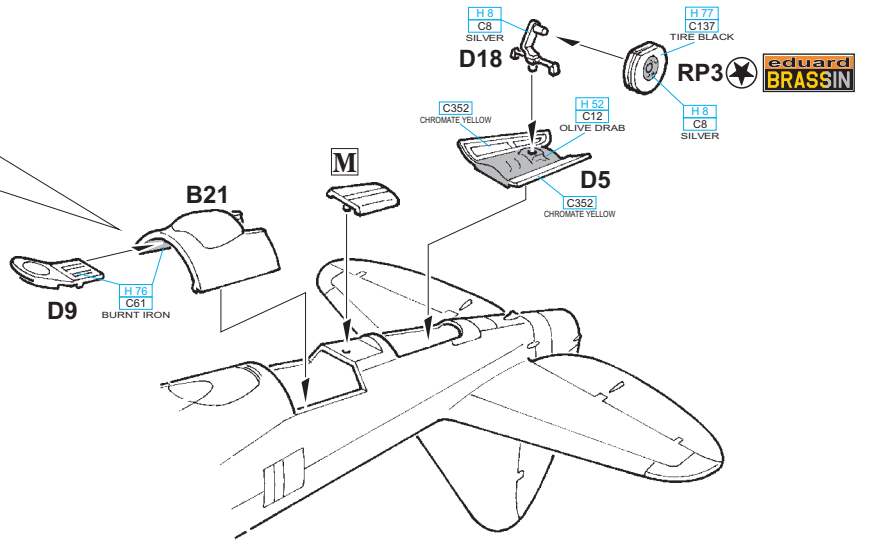
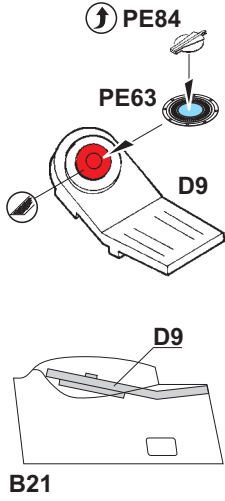
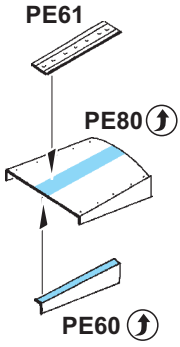

N

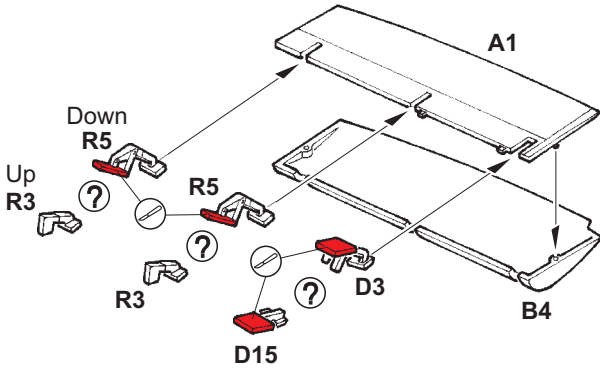

O

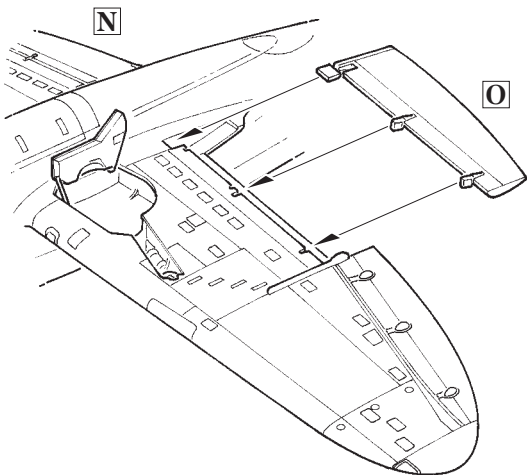
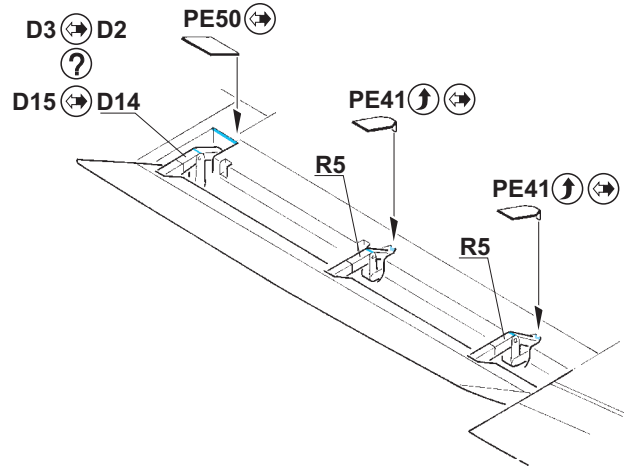
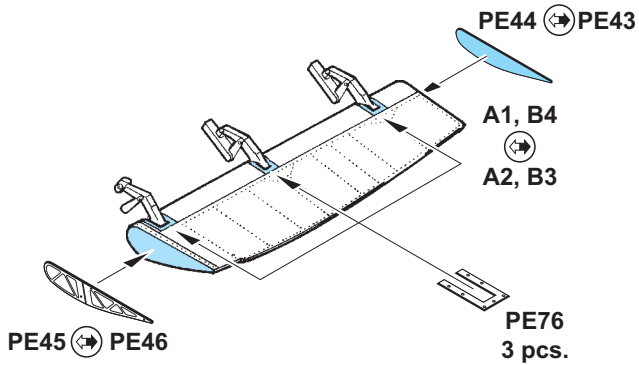
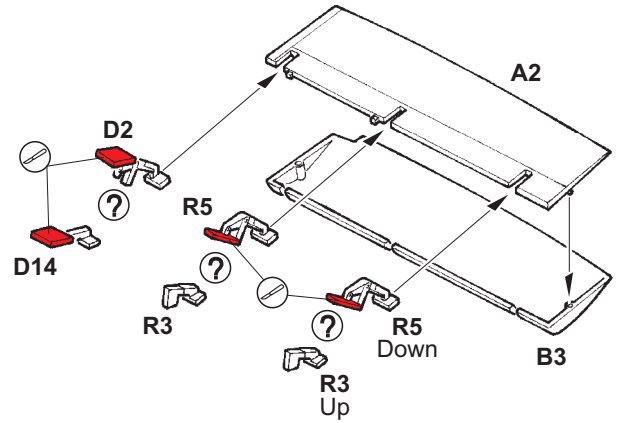

?

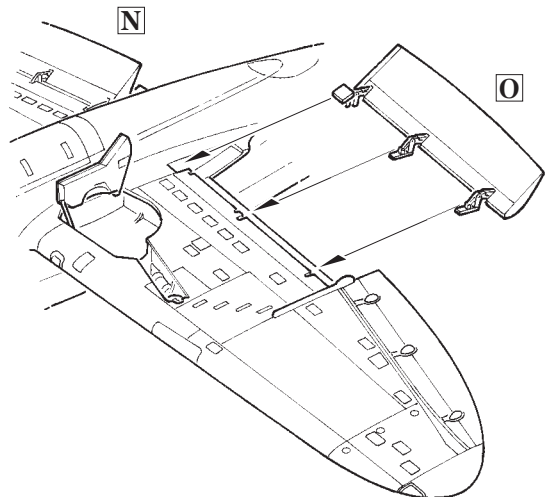

P

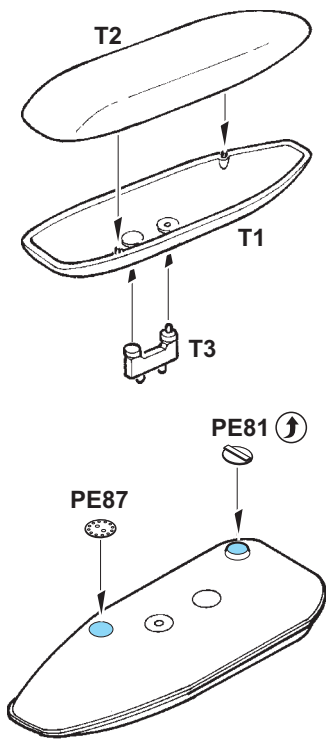

Q 2 pcs.

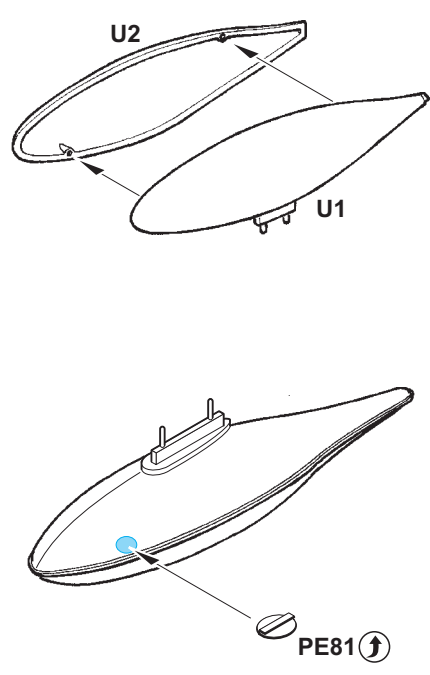

R 2 pcs.

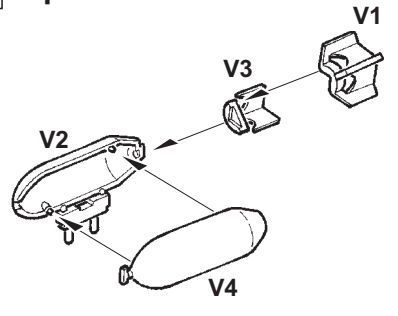

S

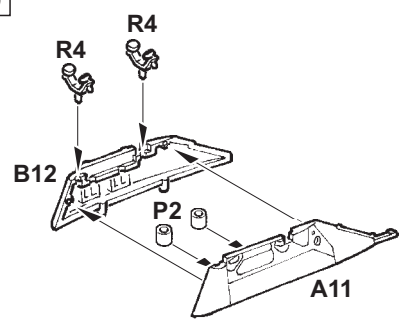

T

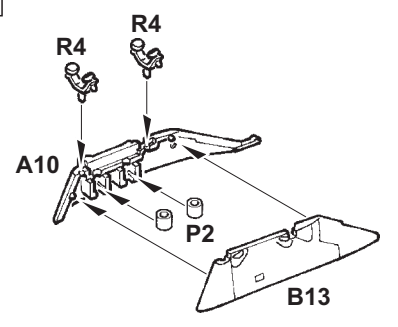

MARKING B ONLY

H 53 C13 NEUTRAL GRAY
H 8 C8 SILVER

H 52 C12 OLIVE DRAB

H 52 C12 OLIVE DRAB

H 8 C8 SILVER
H 53 C13 NEUTRAL GRAY

MARKING B ONLY

PE51

PE38

U

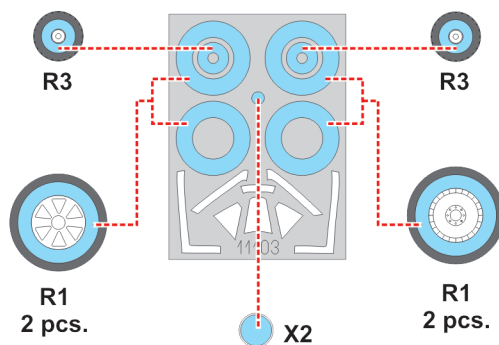
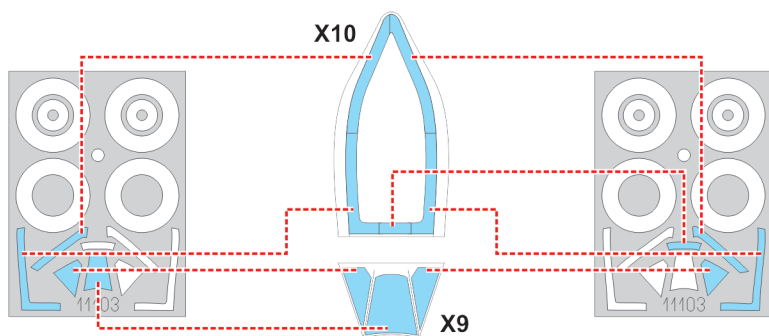
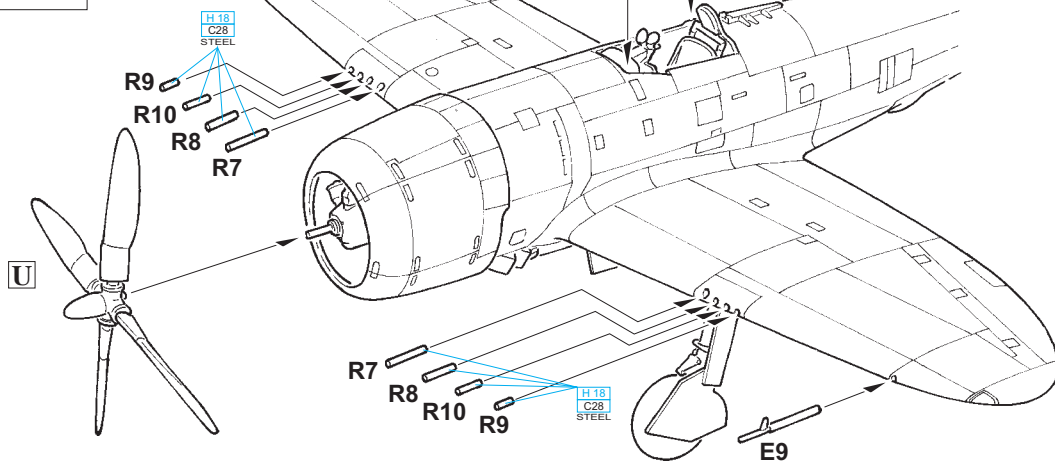
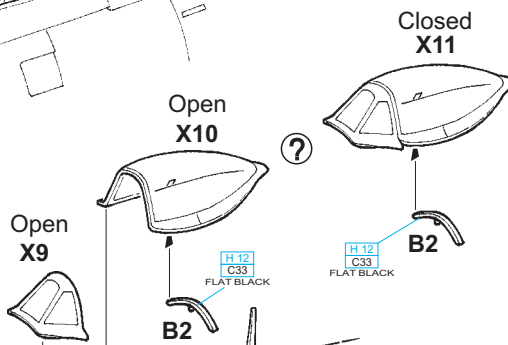
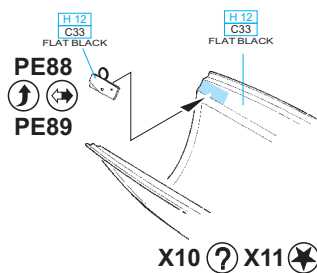
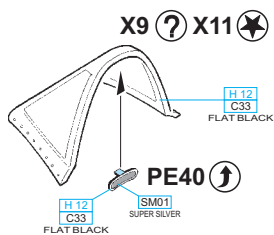
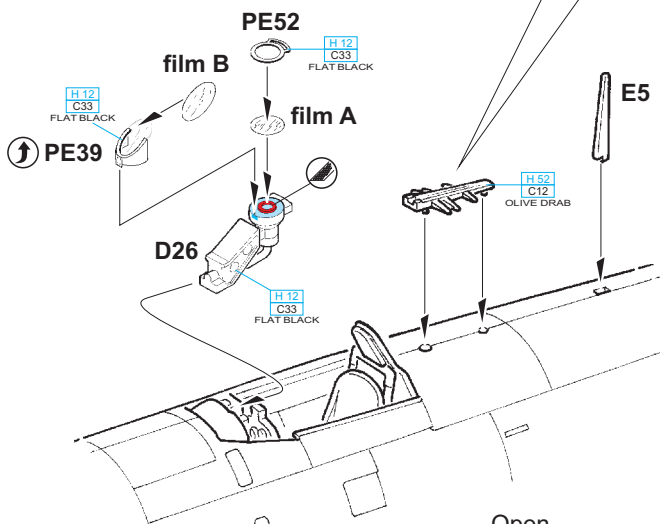
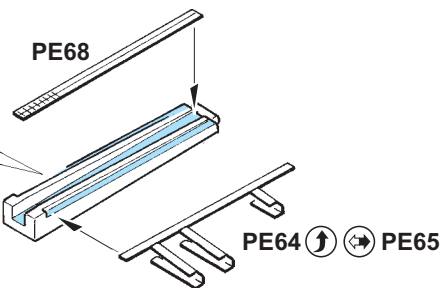
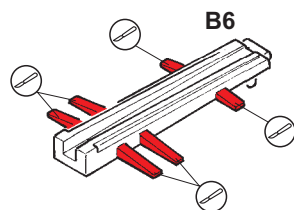
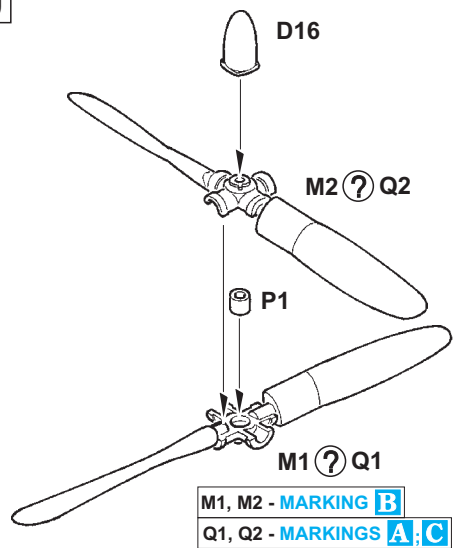

A P-47D-28-RA, Lt. Larry A. Kuhl, 511th FS, 405th FG, 9th AF, Saint Dizier, prosinec 1944

P-47D Thunderbolt obdržela 511th Fighter Squadron ke konci roku 1944 a byl přidělen poručík Larrymu Kuhlovi. Ten letoun pojmenoval po své tehdejší manželce Dottie Mae. Kresbu slečny inspirovanou Vargasovým novým kalendářem pak na motorovém krytu ztvárnil S/Sgt Samuel L. Kirschenbaum. Tečku za operačním nasazením letounu udělal dne 8. května 1945 poručík Mohr, když při nízkém letu nad hladinou rakouského jezera Traunsee zachytil vrtulí o hladinu. Stroj se zřítil do jezera, pilot se naštěstí zachránil. Na dně jezera letoun strávil desítky let, ale 13. června 2005 byl vyzdvížen a následně převezen do USA, kde prochází rekonstrukcí. Stroj létal bez kamuflážního nátěru, pouze hřbet trupu byl nastříkán olivovou barvou, která měla zabránit oslnění pilota během letu. U 511th Fighter Squadron letoun obdržel žluté rozpoznávací pruhy na ocasních plochách, na motorovém krytu a žluté rámování překrytu kabiny. Během služby byly pruhy na ocasních plochách přetřeny červenou barvou.



BLACK	H12 C33
OLIVE DRAB	H52 C12
YELLOW	H329 C329
RED	H327 C327
SILVER	SM01

B P-47D-26-RA, Lt. James R. Hopkins, 509th FS, 405th FG, 9th AF, Ophoven, Belgium, březen 1945

Vlčí hlavu namaloval na tento letoun Sgt. Eli Gutierrez. Inspiroval jej název vysokoškolského týmu amerického fotbalu, jehož členem byl pilot stroje, James R. Hopkins. Tento Thunderbolt nesl pro Bubbletopy méně obvyklý kamuflážní nátěr, kdy horní plochy byly kamuflérovány Olive Drab a spodní Neutral Gray. Letadlo bylo podle zvyku 405th Fighter Group označeno pruhy červené barvy na ocasních plochách a na motorovém krytu. Červené rámování překrytu kabiny nosily letouny 509th Fighter Squadron.



BLACK	H12 C33	YELLOW	H329 C329
OLIVE DRAB	H52 C12	GRAY	H53 C13
RED	H327 C327	SILVER	SM01

C P-47D-28-RA, Lt. Francis Norr, 510th FS, 405th FG, 9th AF, Saint Dizier, France, leden 1945

Thunderbolty verze D-28 byly prvními stroji vyrobenými v továrně v Evansville s kapkovitou kabinou a vybavenými vrtulí Curtiss Electric o průměru 13'1" s asymetrickými vrtulovými listy. Stroj pojmenovaný Pilot's Dream IV, který v řadách 405th Fighter Group létal bez kamuflážního nátěru (pouze hřbet trupu byl nastříkán olivovou barvou proti oslnění), pilotoval poručík Francis „Buzz“ Norr, který během Bitvy o Ardeny sestřelil čtyři Focke Wulfy Fw 190. Stroj nesl modré pruhy na ocasních plochách, na motorovém krytu, modře bylo natřeno též rámování překrytu kabiny. Toto zbarvení používala na svých letounech 510th Fighter Squadron. Na spodku trupu a na spodní ploše křídla ještě zůstaly černobílé pruhy použité pro snazší identifikaci spojeneckých letadel během vyloštění v Normandii.



BLACK	H12 C33	WHITE	H316 C316
OLIVE DRAB	H52 C12	BLUE	H5 C5
		SILVER	SM01