

648 1023 B-17F guns

for Eduard / HKM kit - pro stavebnici Eduard / HKM

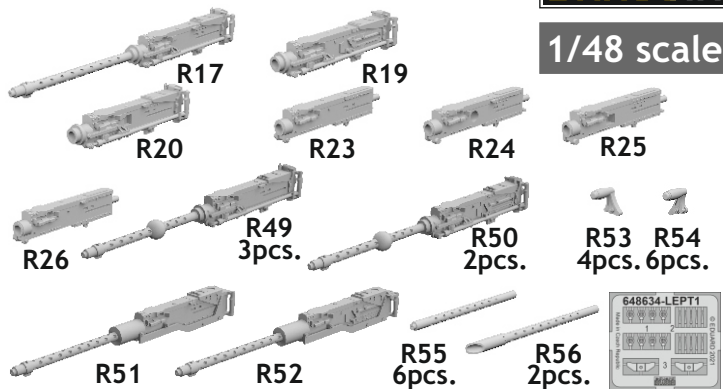

1/48 scale



COLOURS

GSI Creos (GUNZE)			Mr.METAL COLOR	
AQUEOUS	Mr.COLOR			
[H 2]	[C 2]	BLACK		
[H 8]	[C 8]	SILVER		
[H 12]	[C33]	FLAT BLACK		
[H 37]	[C 43]	WOOD BROWN		
	[C 92]	SEMI GLOSS BLACK		

This product contains metal and resin detail parts for upgrading scale plastic models. When selecting this set make sure that it is for the kit mentioned in product name as these sets are made specifically for that kit. When upgrading the model some cutting or corrections may be necessary for parts to fit accurately. **WARNING!** This set contains small and sharp parts. Work carefully in a ventilated and well-lit room. Safety glasses are recommended. This product is not suitable for children below 14 years of age.

Tento výrobek obsahuje leptané a odlévané detaily pro úpravu a vylepšení plastického modelu. Při výběru sady kovových detailů zkontrolujte, zda je určena pro model, který chcete upravit. Model, pro který je sada určena, je uveden u názvu výrobku. Pro přesnou aplikaci kovových a odlévaných dílů může být zapotřebí upravit díly upravovaného modelu. **POZOR!** Sada obsahuje malé ostré díly. Pracujte ve větrané a dobře osvětlené místnosti. Doporučujeme použití ochranných brýlí. Tento výrobek není vhodný pro děti mladší 14 let.

eduard

435 21 Obrnice 170
Czech Republic

www.eduard.com
24,95



648 1023

B-17F guns

1/48

for Eduard / HKM kit - pro stavebnici Eduard / HKM

BRASSIN

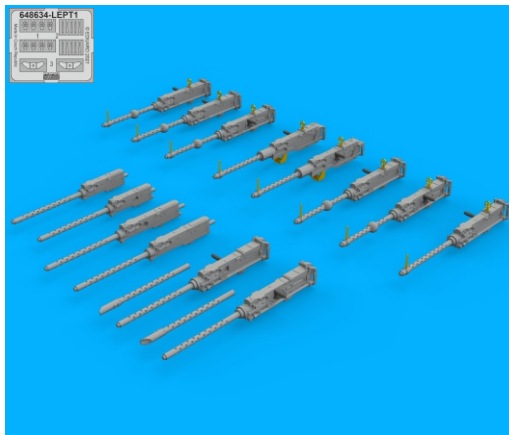

BRASSIN

eduard



BEST BRASS RESIN AROUND!

WAIST WINDOW GUN ASSEMBLY

A RIGHT SIDE

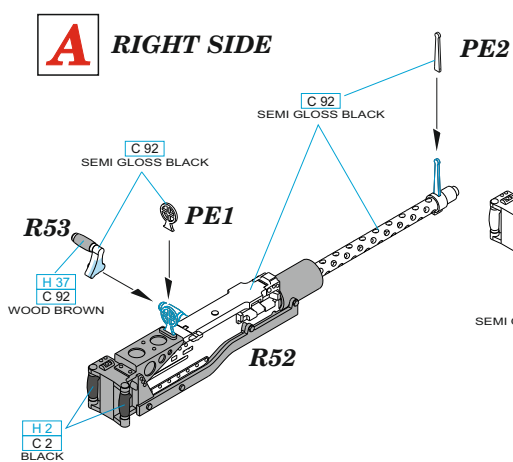

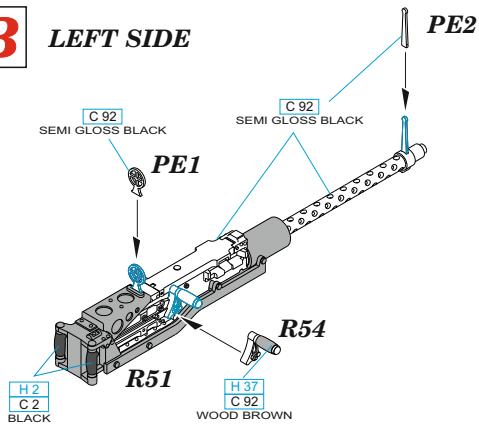

B LEFT SIDE

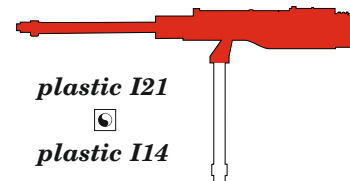

=



- REMOVE ODSTRANIT
- GRIND OBROUSIT
- DRILL HOLE VRTAT OTVOR
- SYMMETRICAL ASSEMBLY SYMETRICKA MONTAZ
- SCRIBE THE PANEL AND HOLES RYTI
- REVERSE SIDE OTOCIT
- BEND OHNOUT
- OPTION VOLBA
- REPLACE NAHRADIT

 =  $\varnothing - 1,3mm$

RADIO COMPARTMENT GUN ASSEMBLY

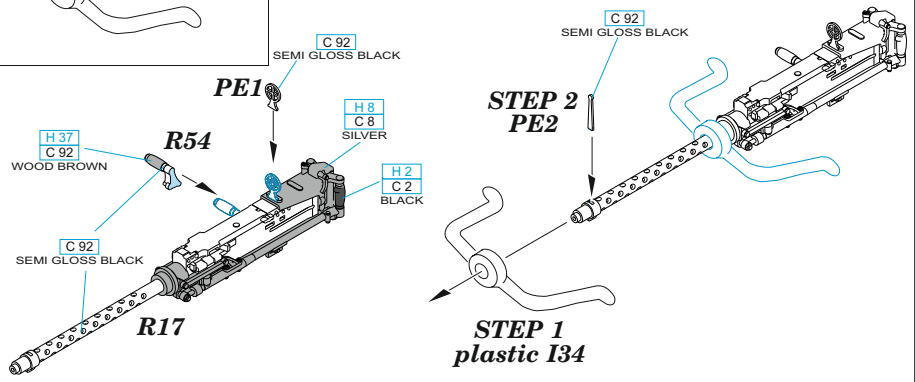
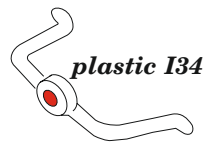

BALL TURRET GUNS ASSEMBLY

plastic V2+V17  *plastic V1+V18*

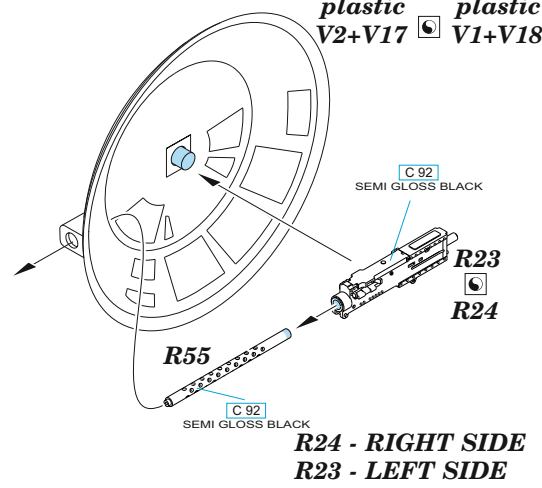

CHEYENNE TAIL TURRET GUNS ASSEMBLY

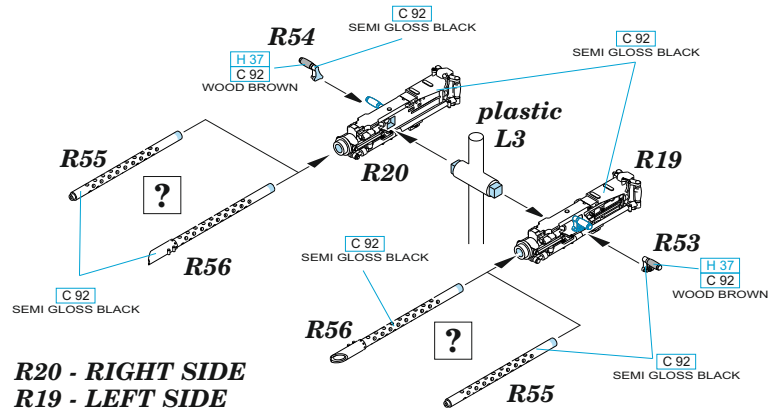

TOP TURRET GUNS ASSEMBLY

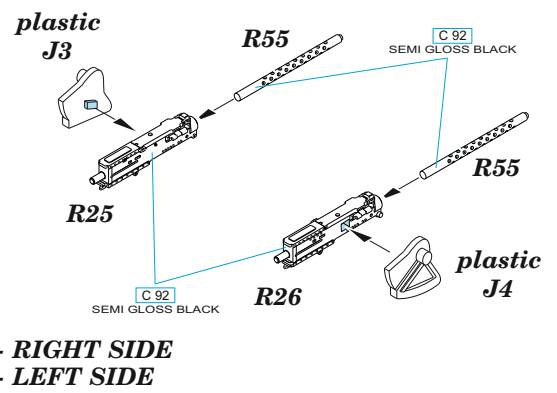

CHEEK GUN ASSEMBLY

C

LEFT SIDE

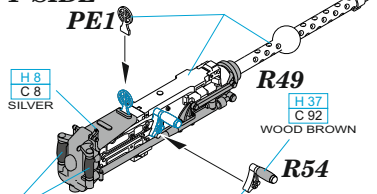

STEP 2
PE2

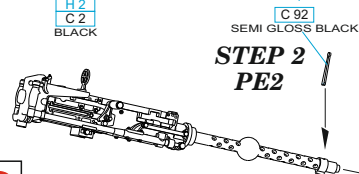

STEP 1
plastic P1

D

RIGHT SIDE

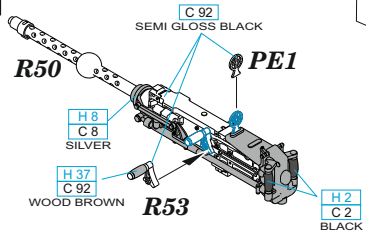

STEP 2
PE2

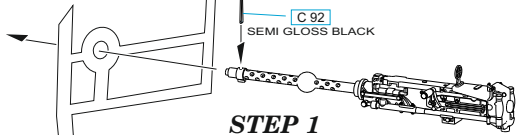

STEP 1
plastic P2 ? plastic X12

= $\varnothing - 1,3mm$

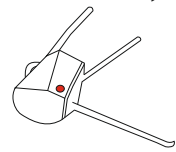

NOSE GUNS

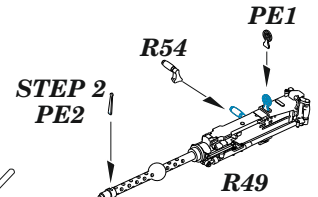

STEP 2
PE2

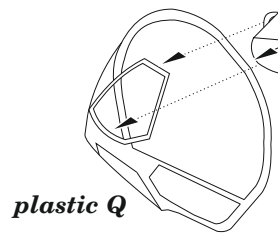

STEP 1
plastic P7

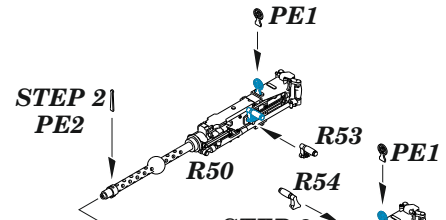

STEP 2
PE2

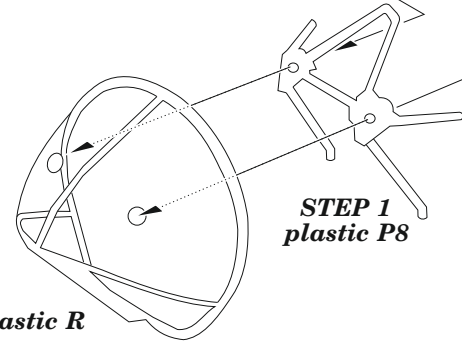

STEP 1
plastic P8