

PROTIPACK



Me 410 Schnellbomber

ATTENTION * UPOZORNĚNÍ * ACHTUNG * ATTENTION * 注意



Carefully read instruction sheet before assembling. When you use glue or paint, do not use near open flame and use in well ventilated room. Keep out of reach of small children. Children must not be allowed to suck any part, or pull vinyl bag over the head.



Před započítím stavby si pečlivě prostudujte stavební návod. Při používání barev a lepidel pracujte v dobře větrané místnosti. Lepidla ani barvy nepoužívejte v blízkosti otevřeného ohně. Model není určen malým dětem, mohlo by dojít k požití drobných dílů.



lire soigneusement la fiche d'instructions avant d'assembler. Ne pas utiliser de colle ou de peinture à proximité d'une flamme nue, et aérer la pièce de temps en temps. Garder hors de portée des enfants en bas âge. Ne pas laisser les enfants mettre en bouche ou sucer les pièces, ou passer un sachet vinyl sur la tête.



Von dem Zusammensetzen die Bauanleitung gut durchlesen. Kleber und Farbe nicht nahe von offenem Feuer verwenden und das Fenster von Zeit zu Zeit Belüftung öffnen. Bausatz von kleinen Kindern fernhalten. Verhüten Sie, daß Kinder irgendwelche Bauteile in den Mund nehmen oder Plastiktüten über den Kopf ziehen.



組み立てる前に必ず説明書をお読み下さい。接着剤や塗料をご使用の際は、窓を開けて十分な換気をおこない、火のそばでは使用しないで下さい。小さな子供の手の届かない所に必ず保管してください。部品や破片を噛んだり、なめたり、飲んだりすると大変危険です。又、部品を取り出した後のビニール袋は、小さな子供が頭から被ったりすると窒息する恐れがありますので、破り捨てして下さい。

INSTRUKTION SIGNS * INSTR. SYMBOLY * INSTRUKTION SINNBILDEN * SYMBOLES * 記号の説明



OPTIONAL
FACULTATIF
NACH BELIEBEN
VOLBA
選択する



BEND
PLIER SIL VOUS PLAIT
BITTE BIEGEN
OHNOUT
折る



OPEN HOLE
FAIRE UN TROU
OFFNEN
VYVRTAT OTVOR
穴を開ける



SYMETRICAL ASSEMBLY
MONTAGE SYMÉTRIQUE
SYMMETRISCHE AUFBAU
SYMETRICKÁ MONTÁŽ
左右均等に組み立てる



NOTCH
L INCISION
DER EINSCHNITT
ZÁREZ
切る



REMOVE
RETIRER
ENTFERNEN
ODRÍZNOUT
移す



APPLY EXPRESS MASK
AND PAINT BEFORE
GLUING
POUŽÍT EXPRESS MASK
NABARVIT PŘED SLEPENÍM

PP - PLASTIC PARTS

<A>

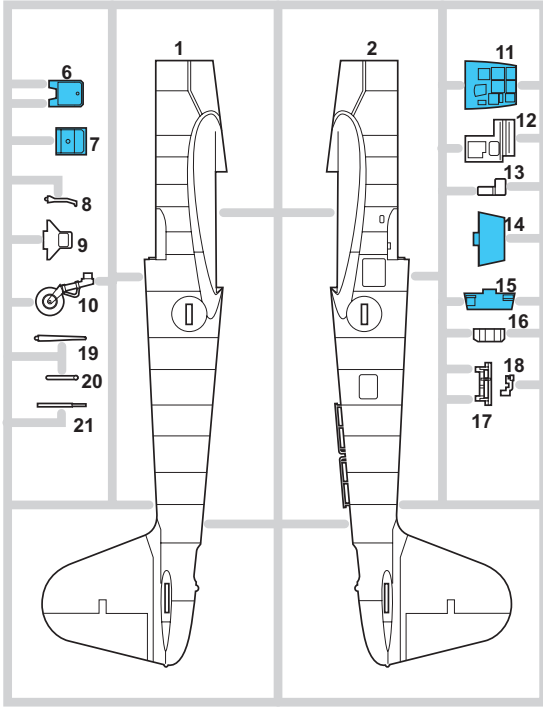

<A>

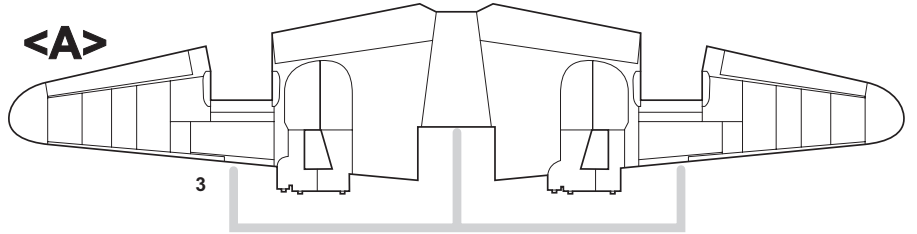

<A>

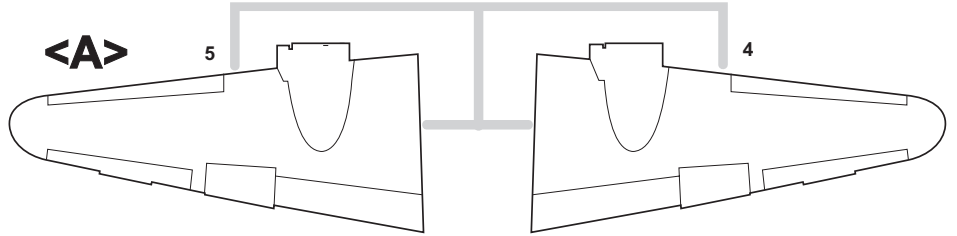

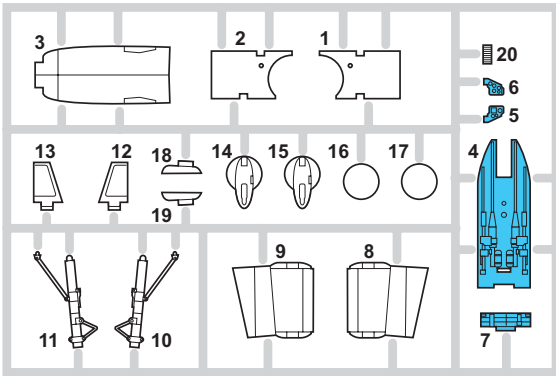

<C> 2 pcs.

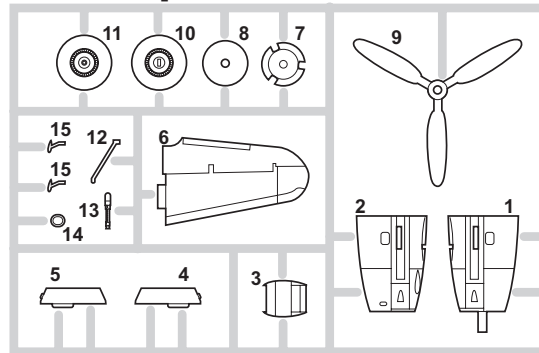

<D>

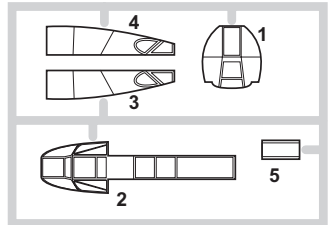

Parts not for use.
 Tyto díly nepoužívejte při stavbě.
 Teile werden nicht verwendet.
 Pièces à ne pas utiliser.
 使用しない部品

eduard
 Express Mask

VACUFORMED CANOPY

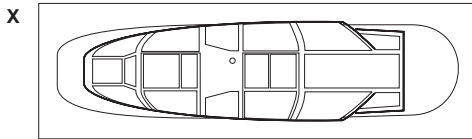

FILM

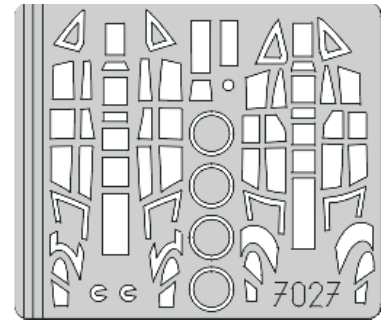

RP - RESIN PARTS

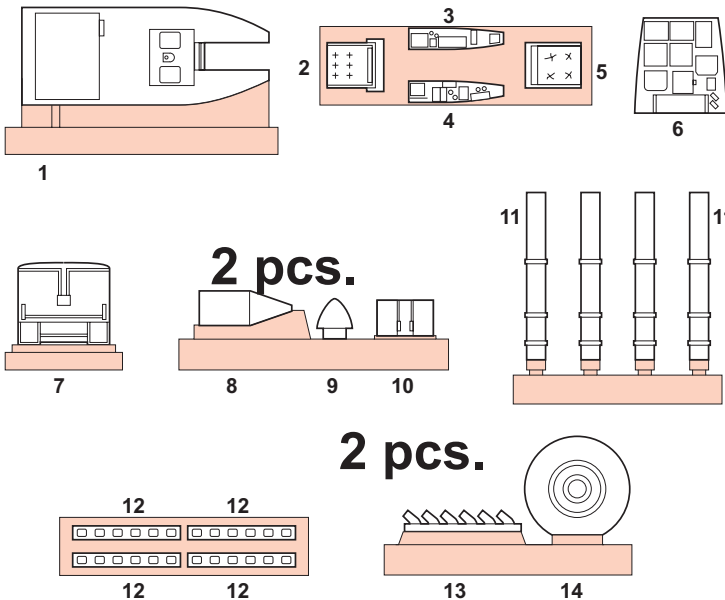

PE-PHOTO ETCHED PARTS

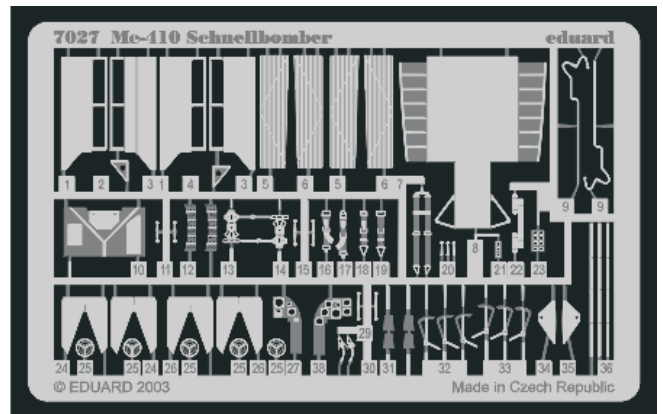

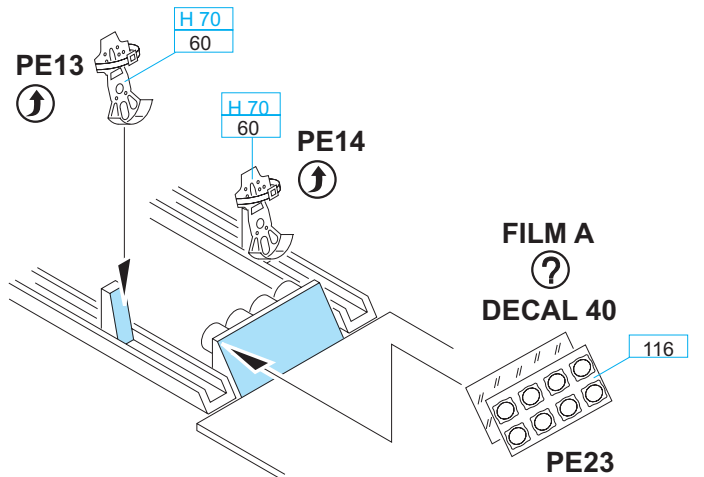
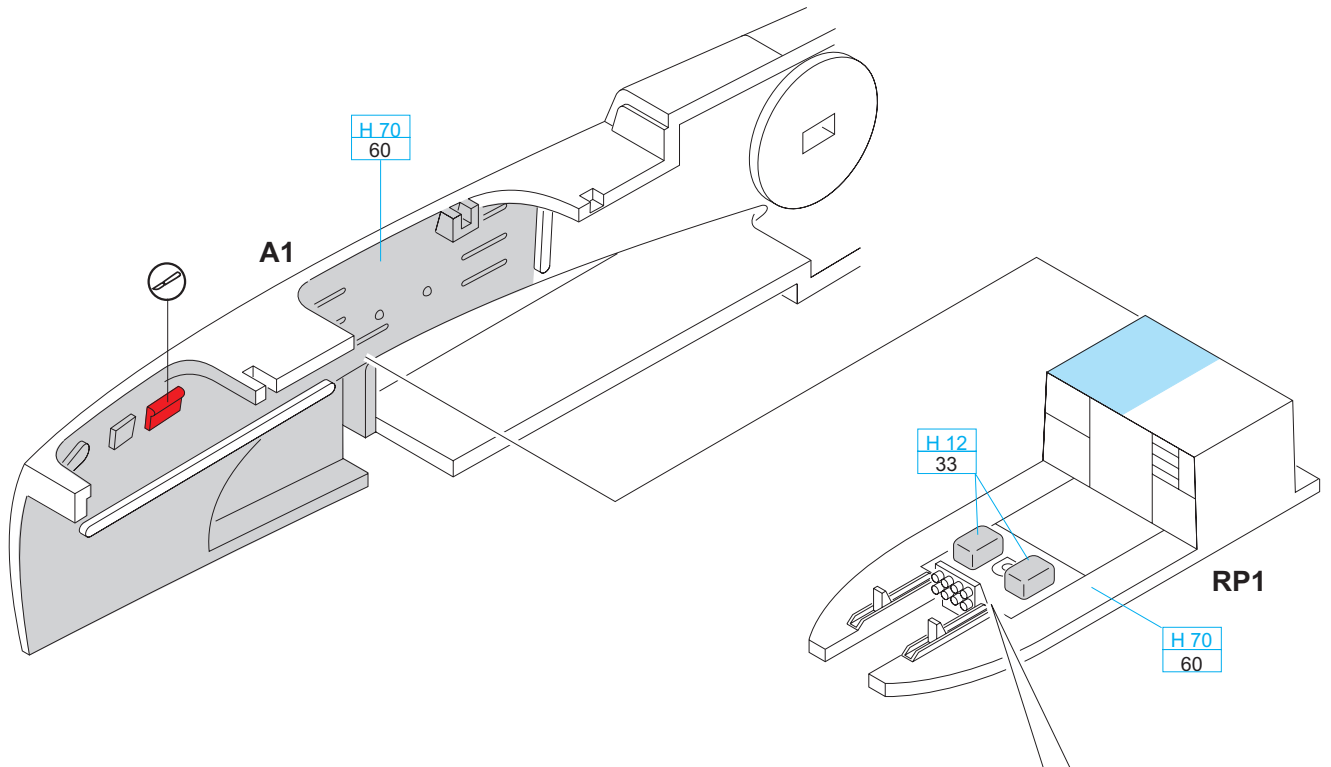
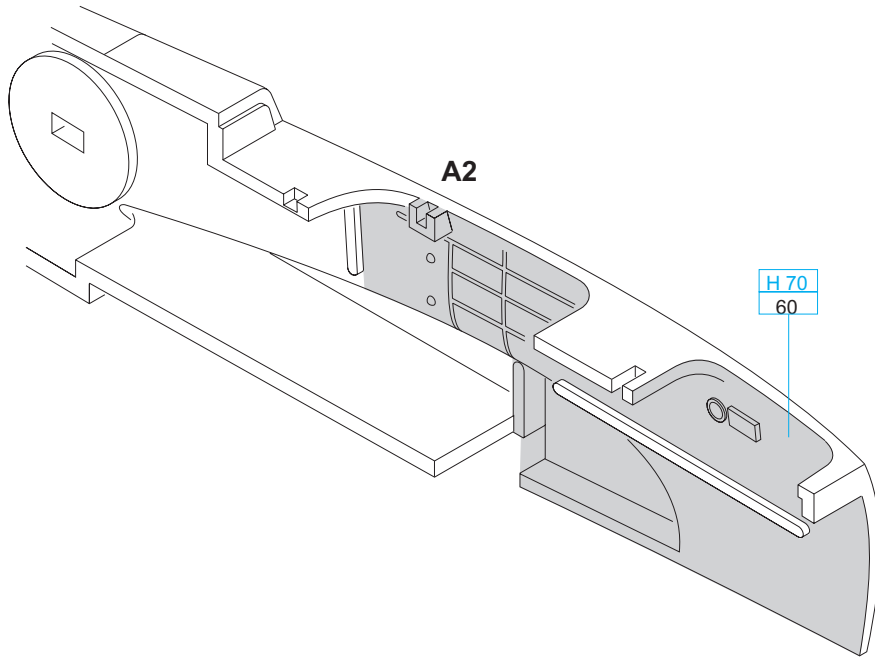

2

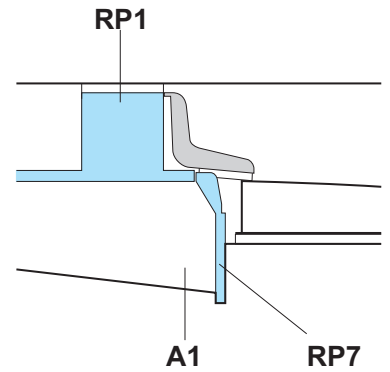
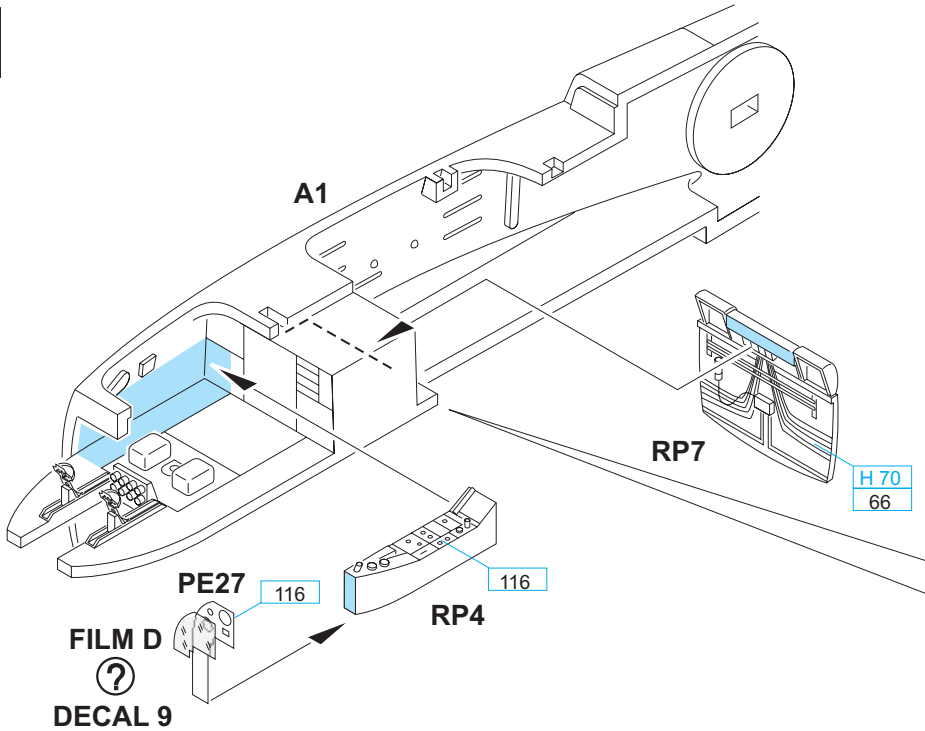

3

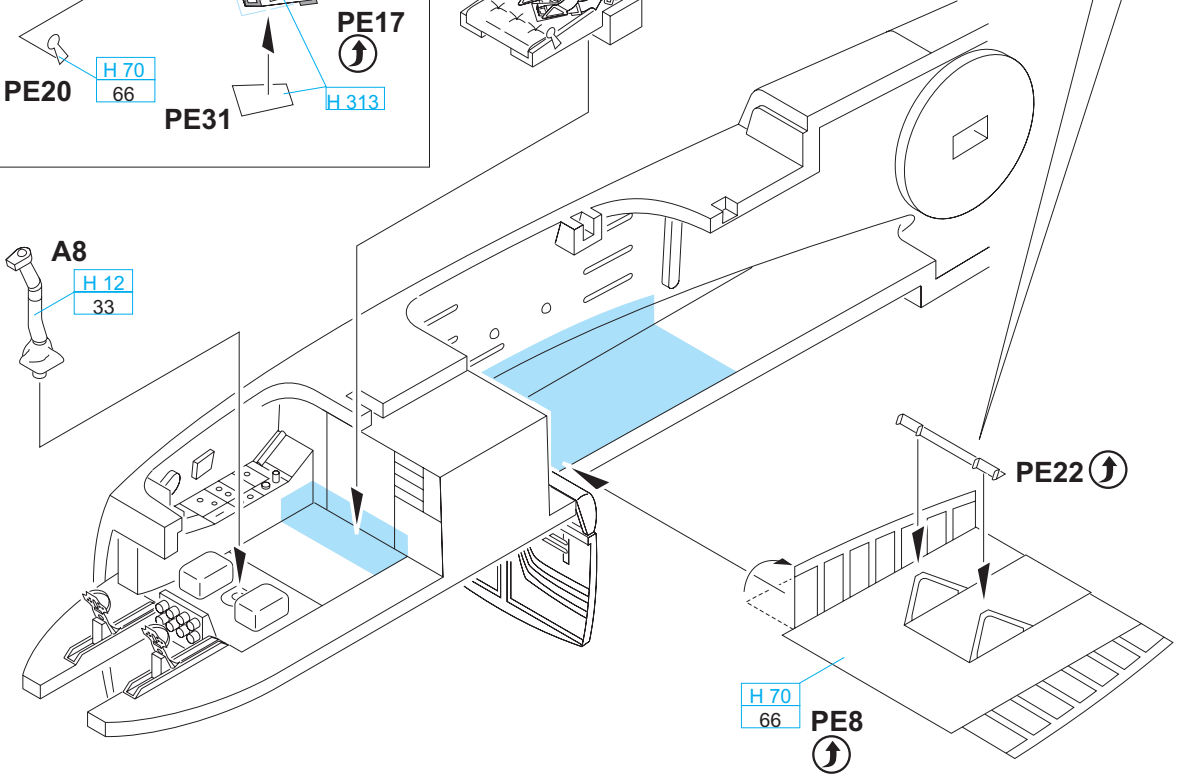
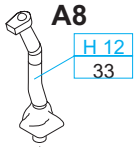
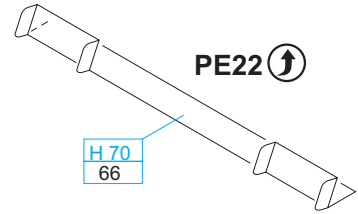
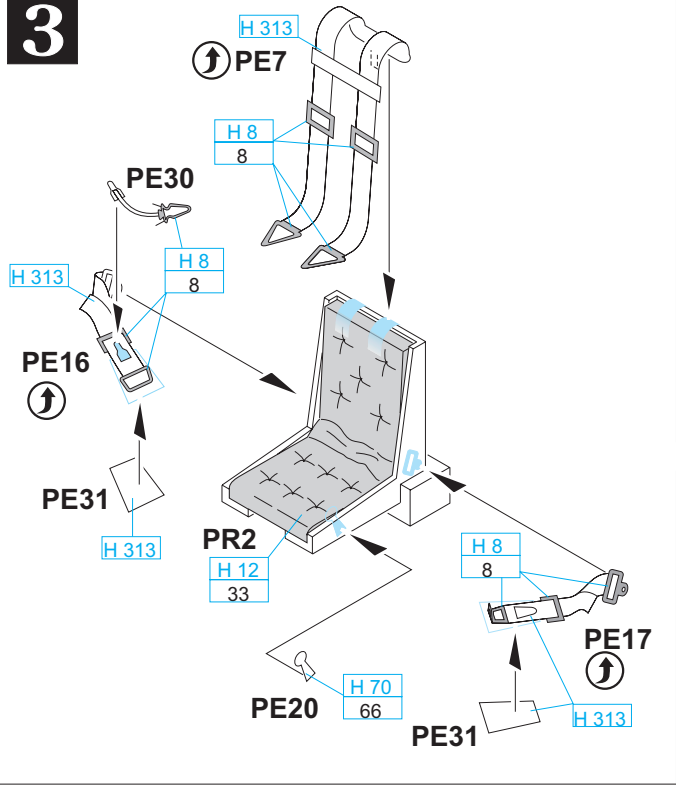

4

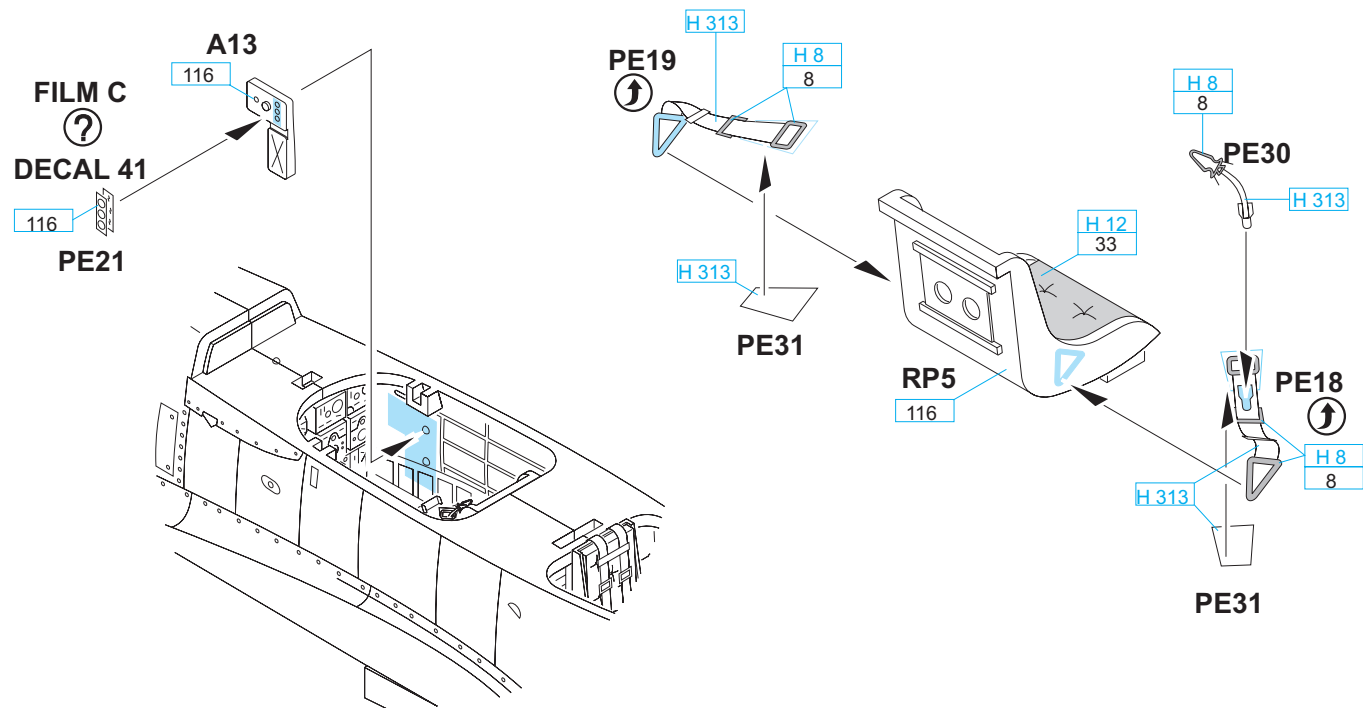
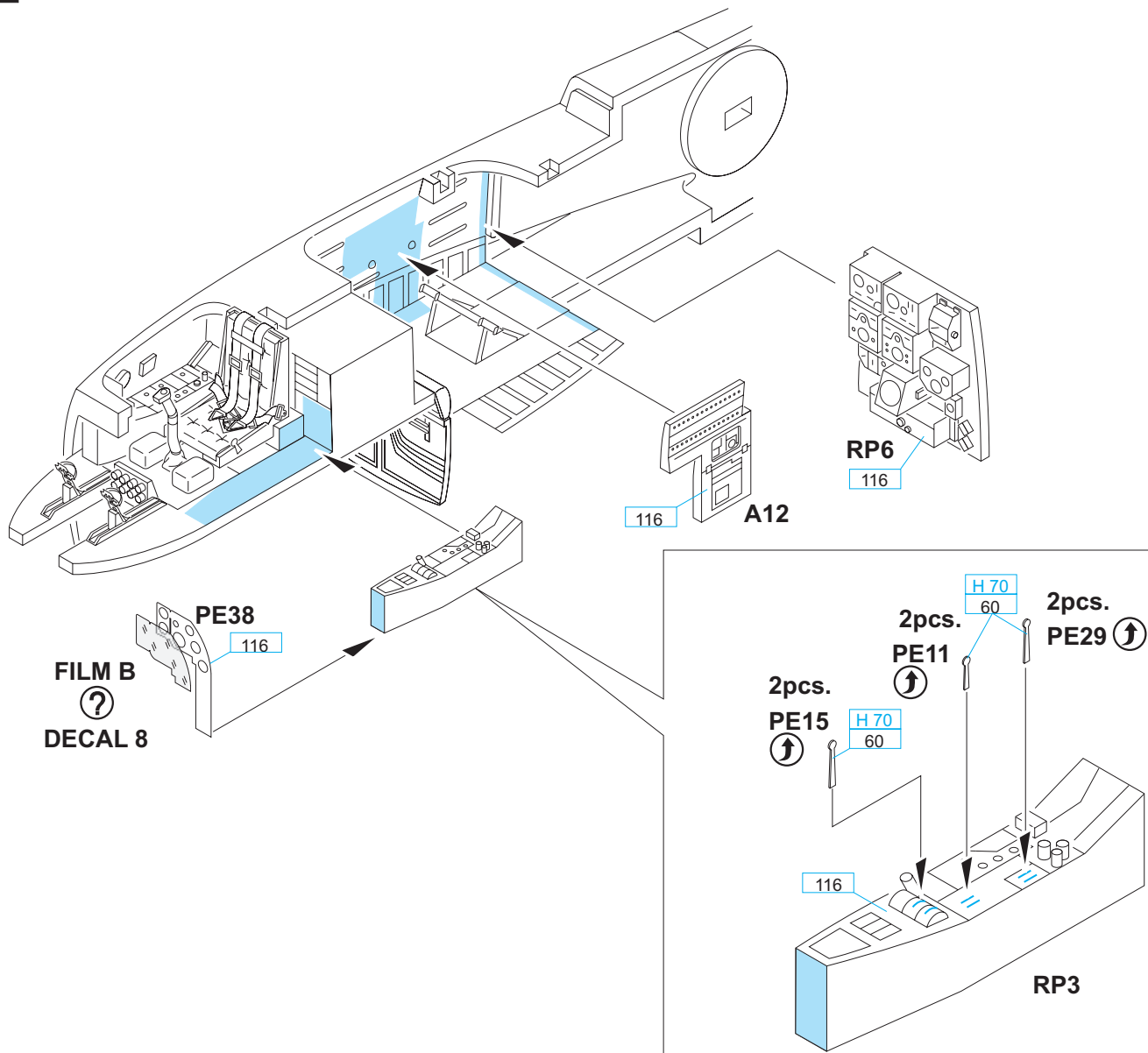

6

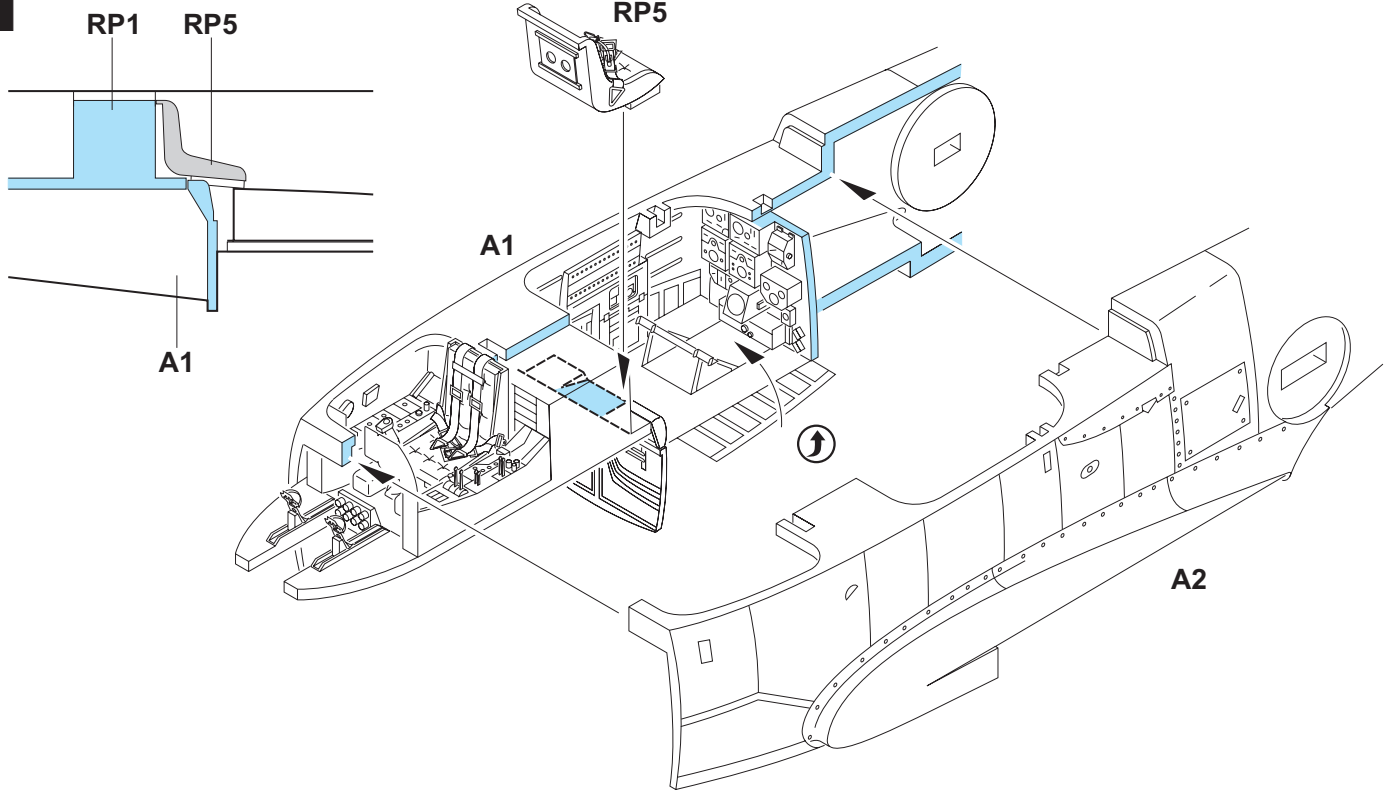

7

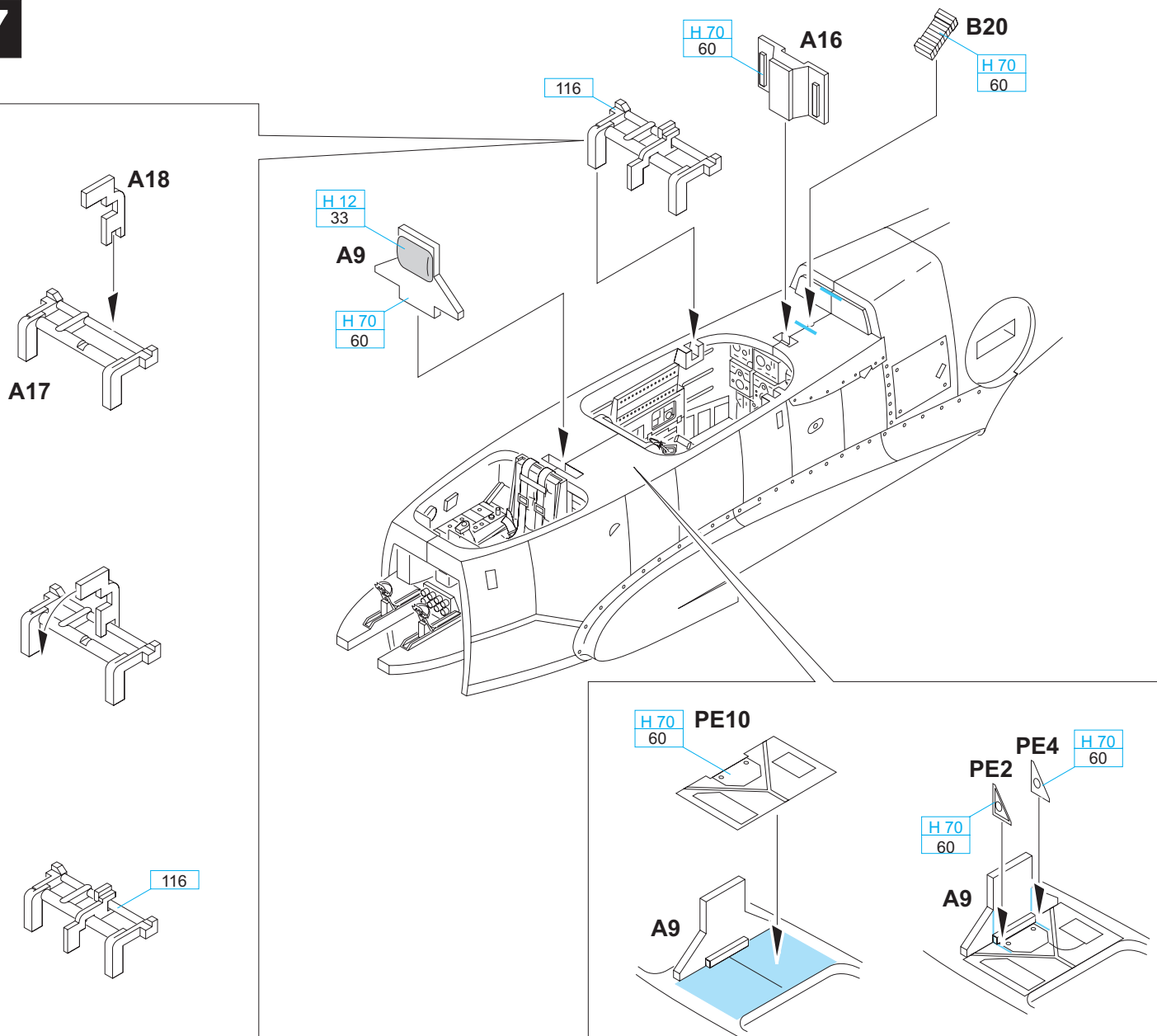

6

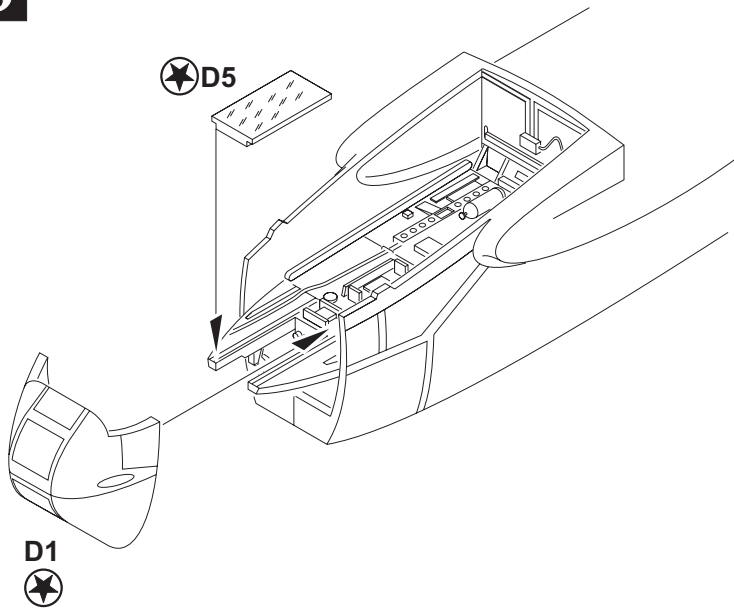

? OPEN

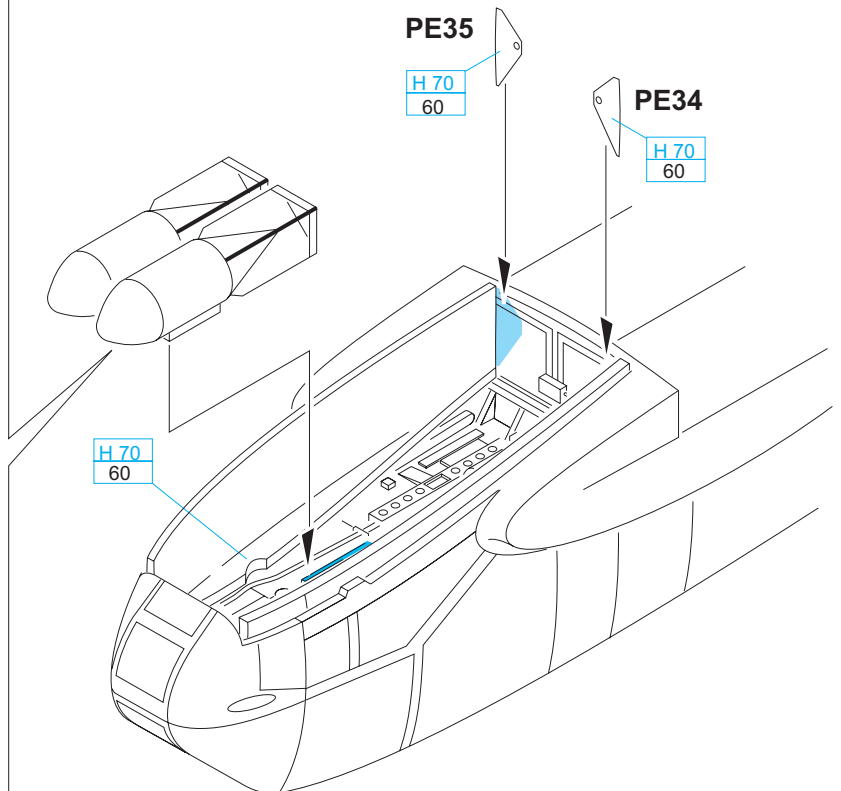
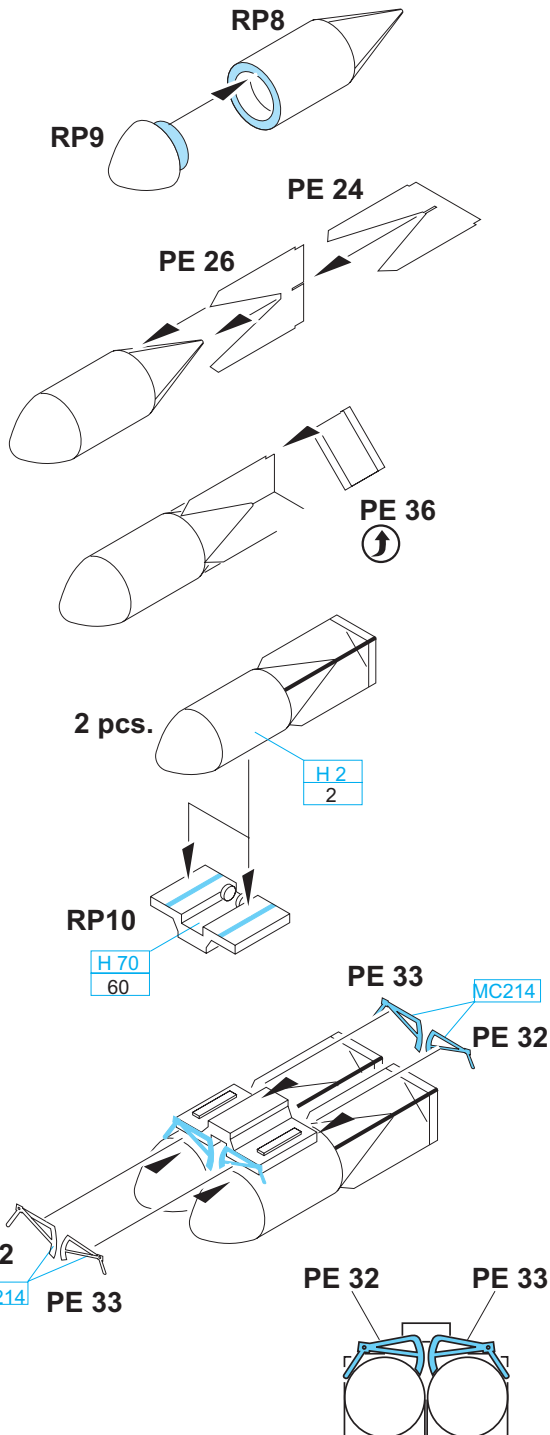
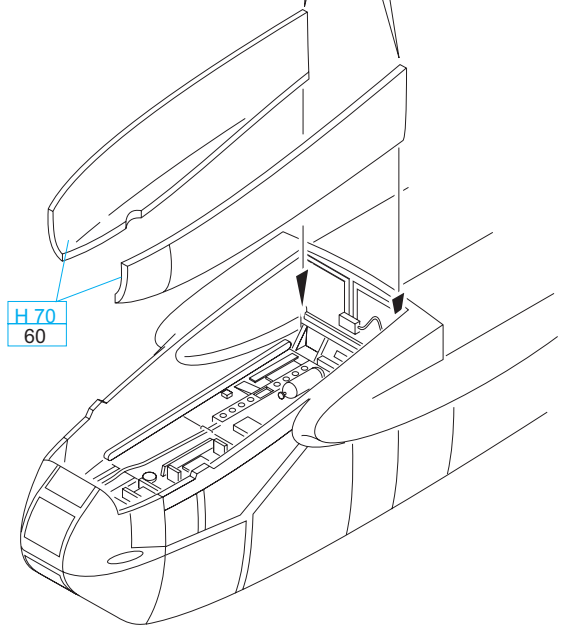
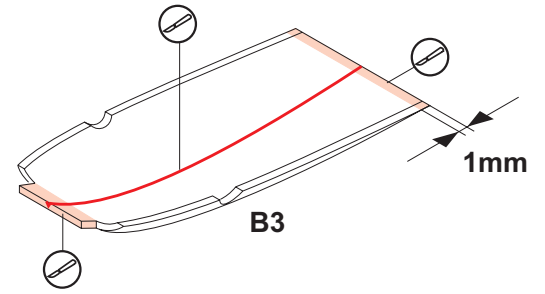

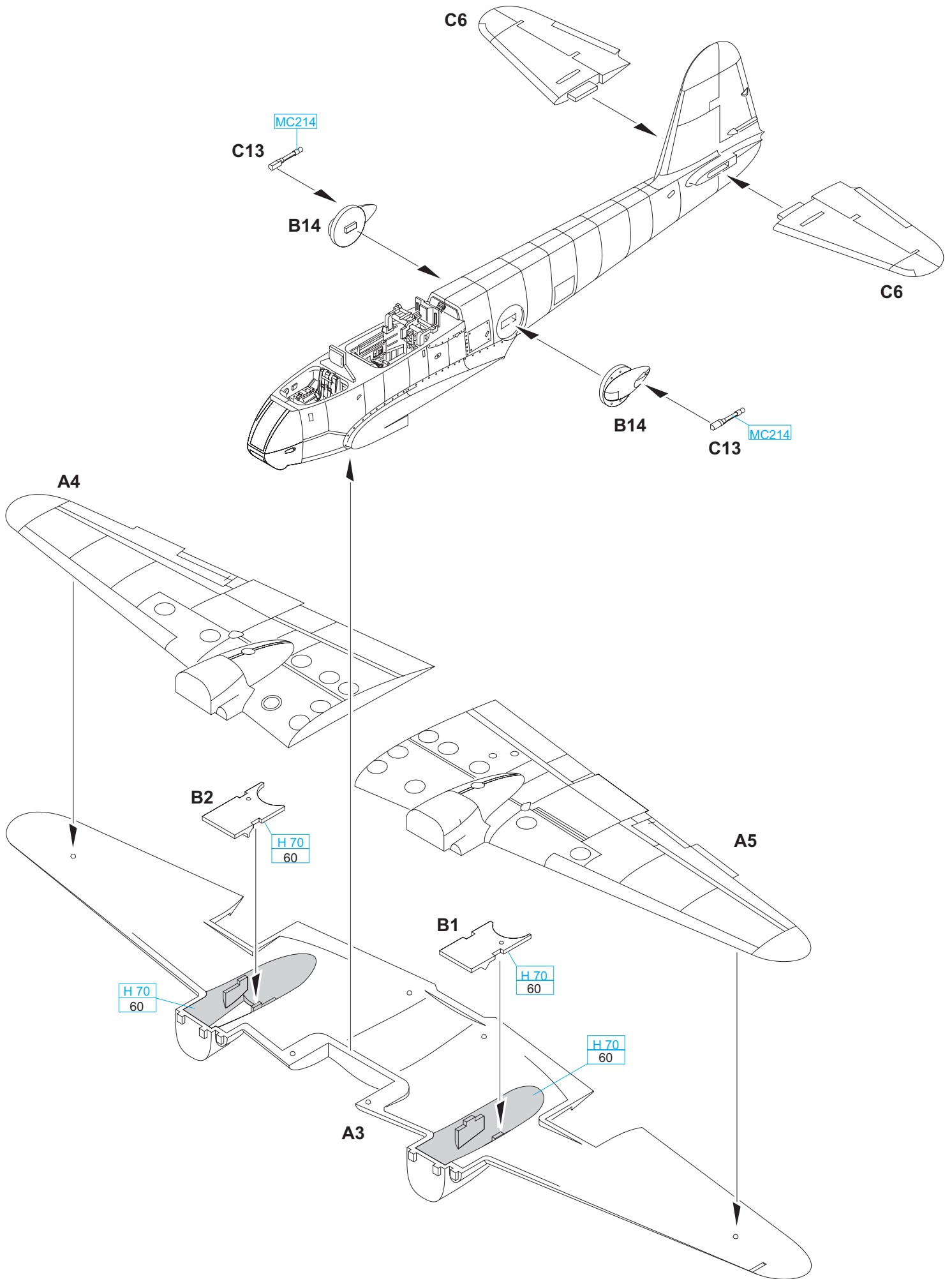

10

RP13

?

C4

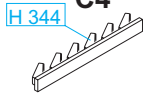

?

H 344

RP11

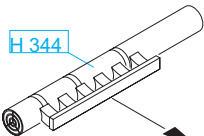

C1

2 pcs.

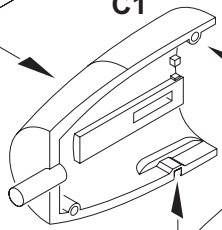

C2

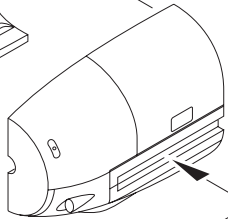

PE1

↑

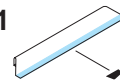

RP15

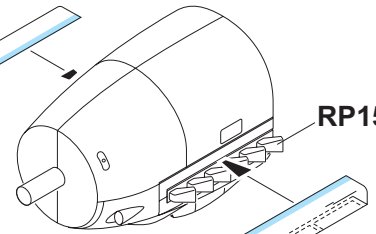

PE3

↑



4 pcs.

RP11

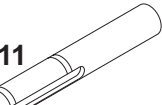

RP12

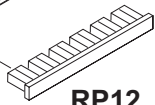

PE25



RP15-MARKING **A; B**

RP11-MARKING **C; D**

H 344

RP11

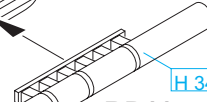

?

H 344

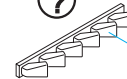

RP13

?

C5

PE12



C3

H 70
60

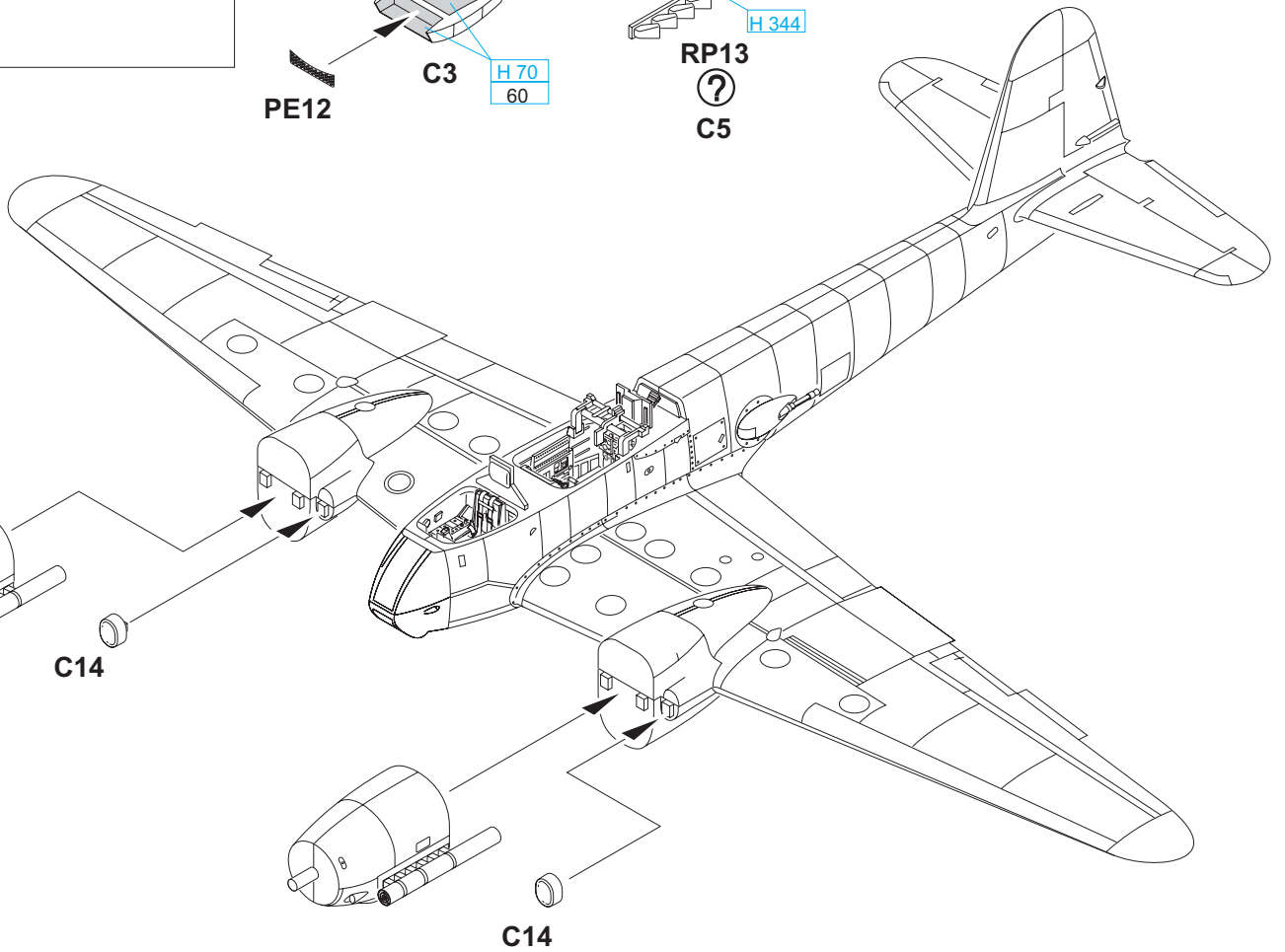

11

H 77

A10

H 47
41

H 70
60

H 70
60

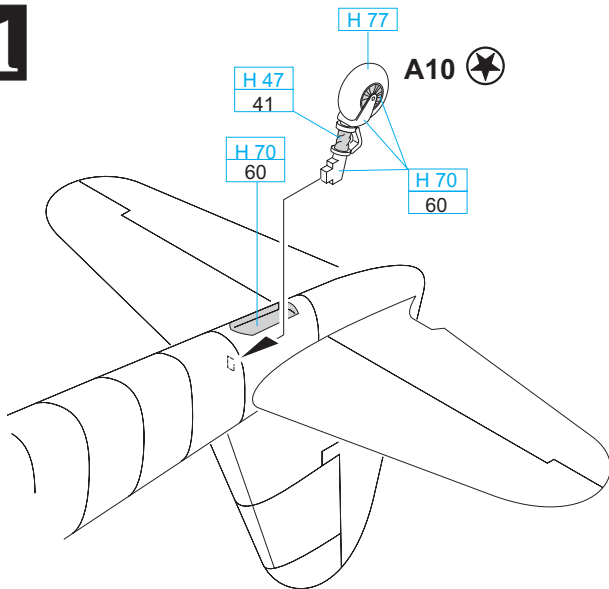

H 70
60

B18

B19

H 70
60

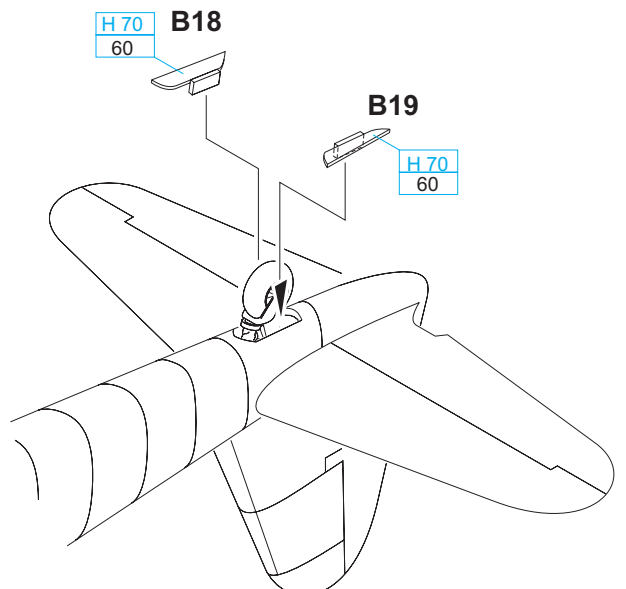

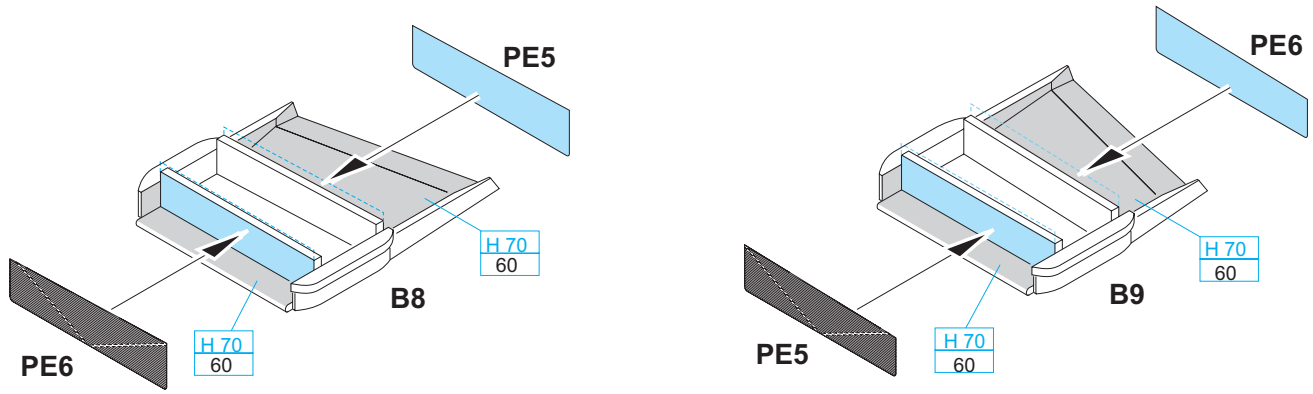
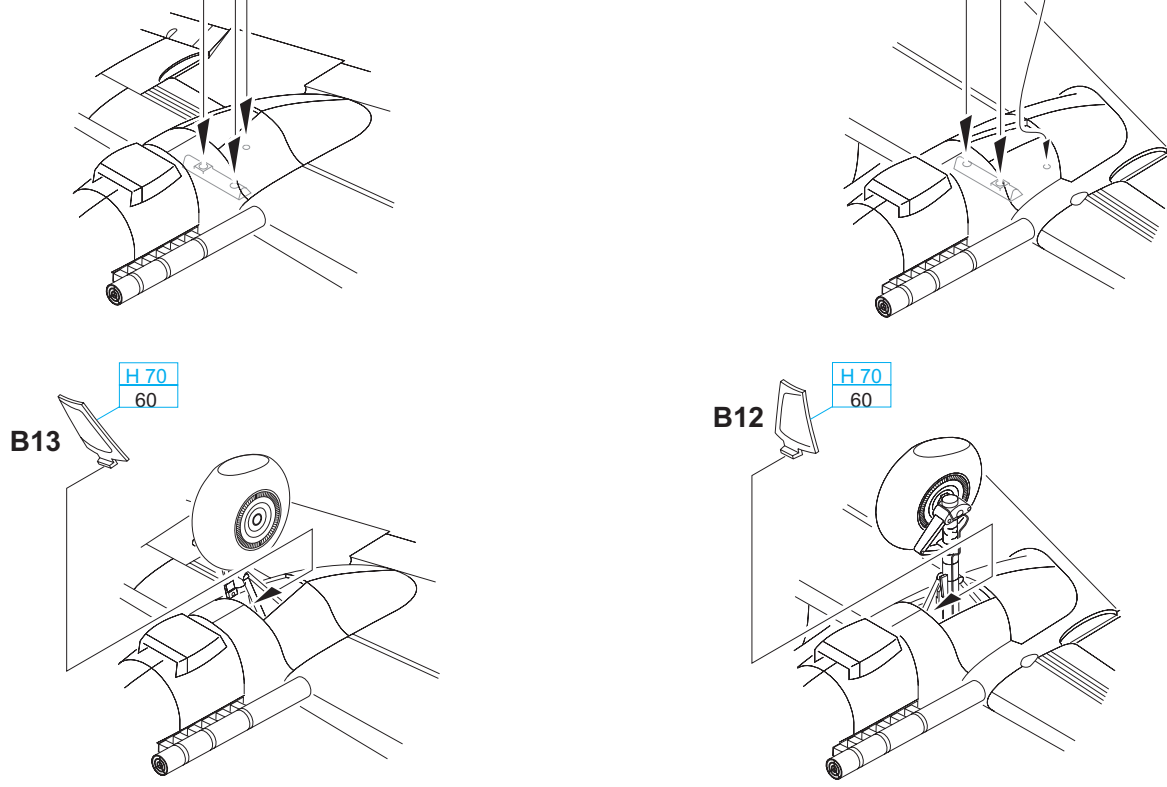
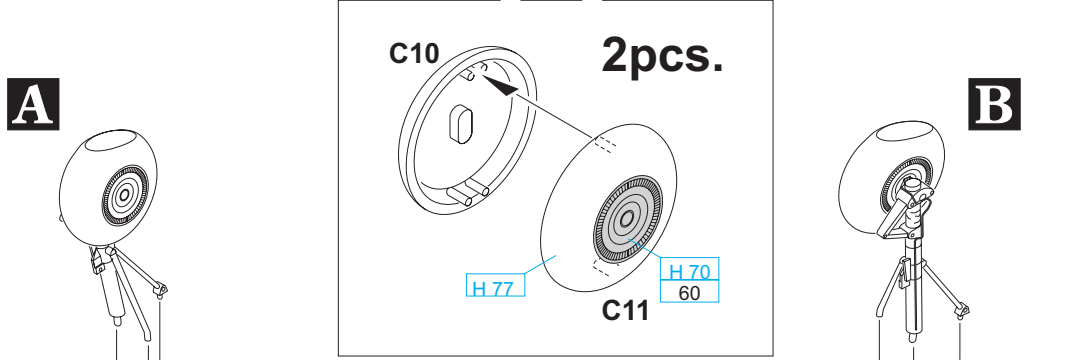
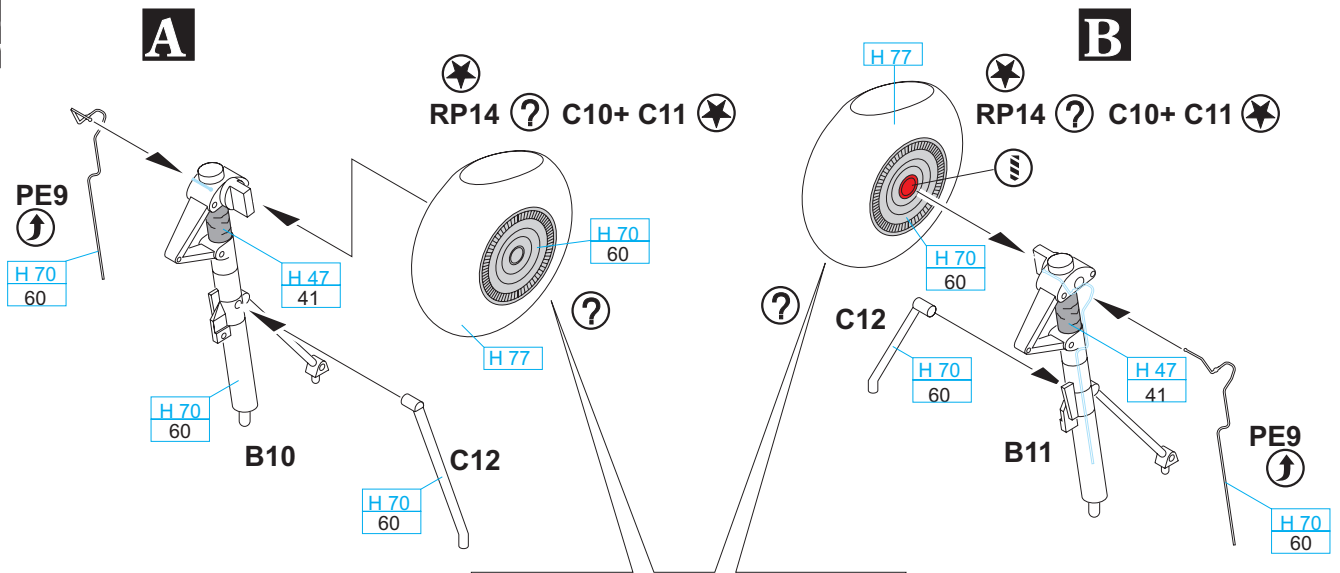

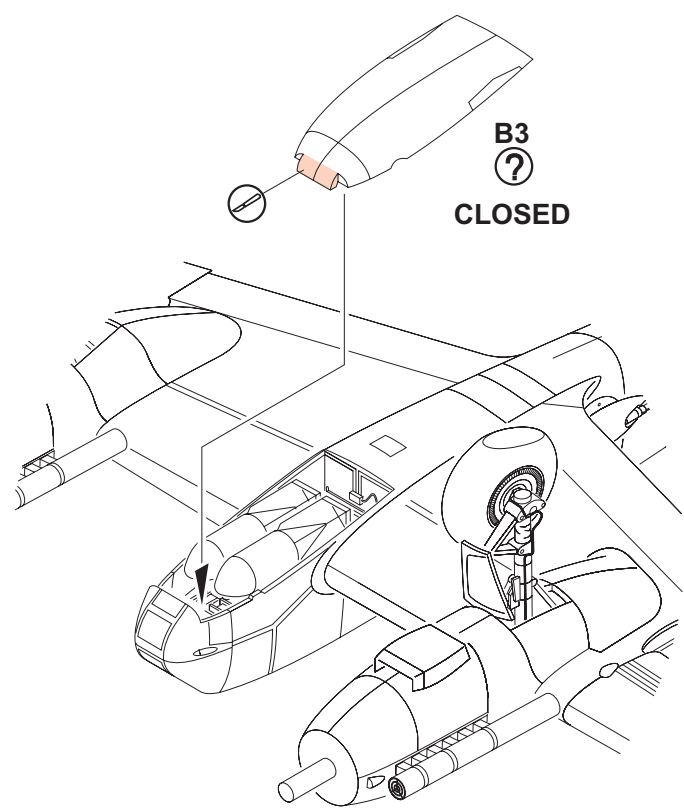
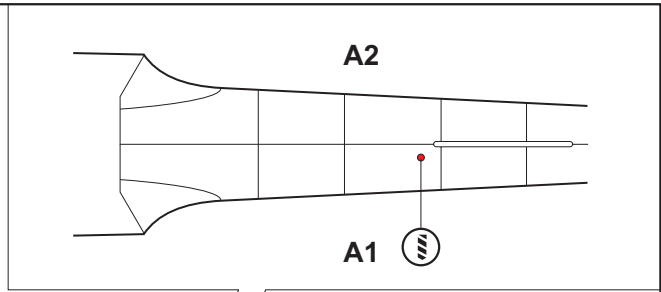
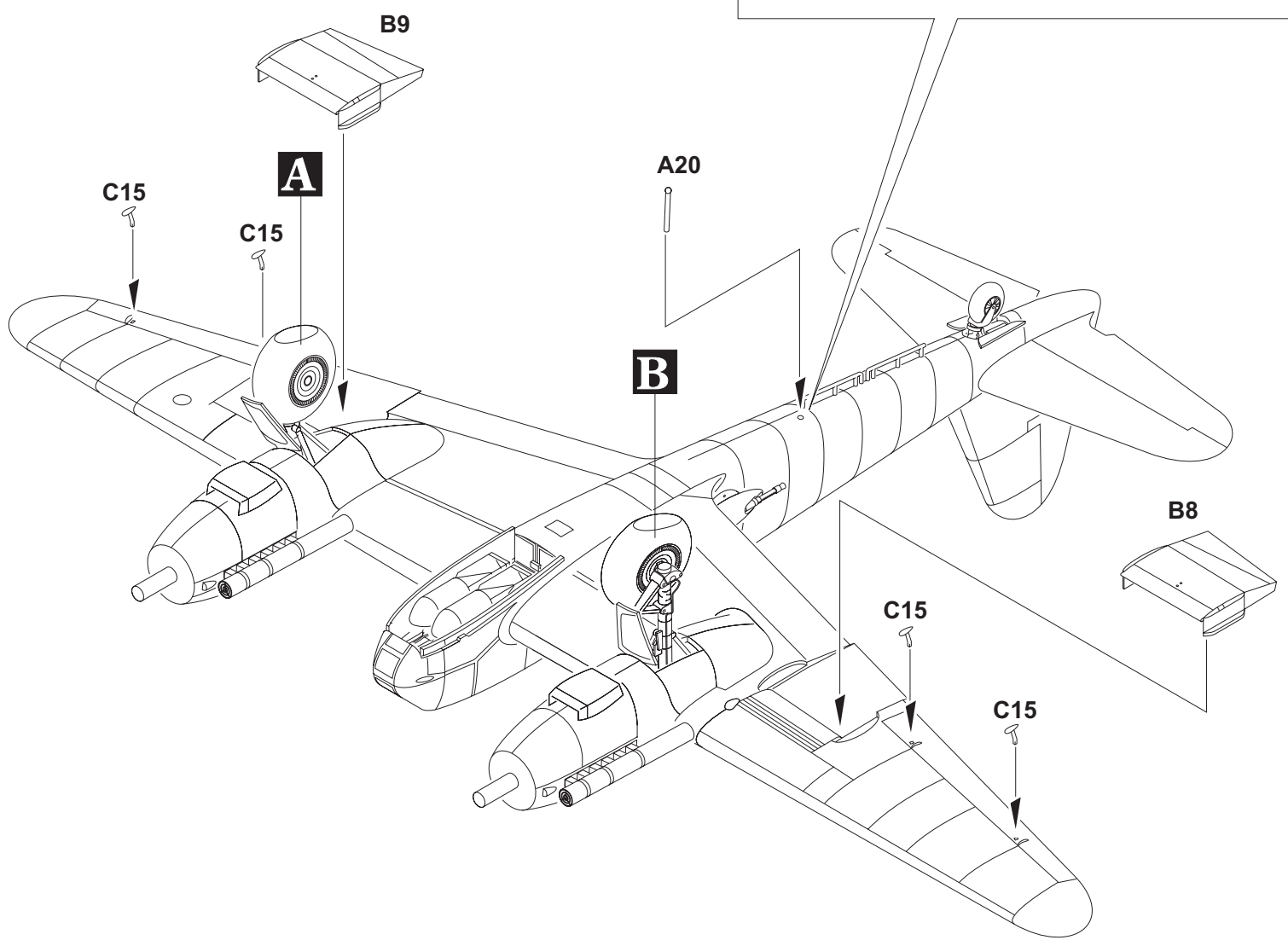

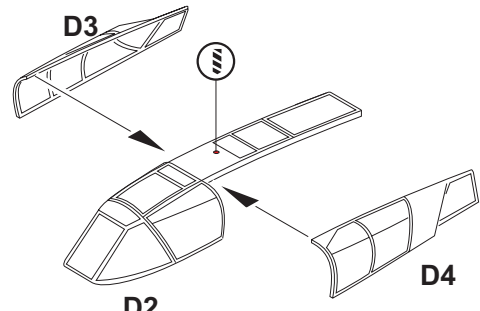
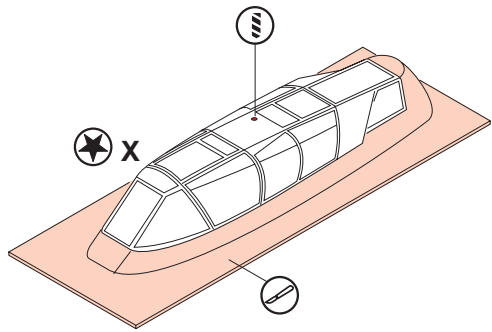

D2
 ⚙ XS 216
 DO NOT INCLUDED

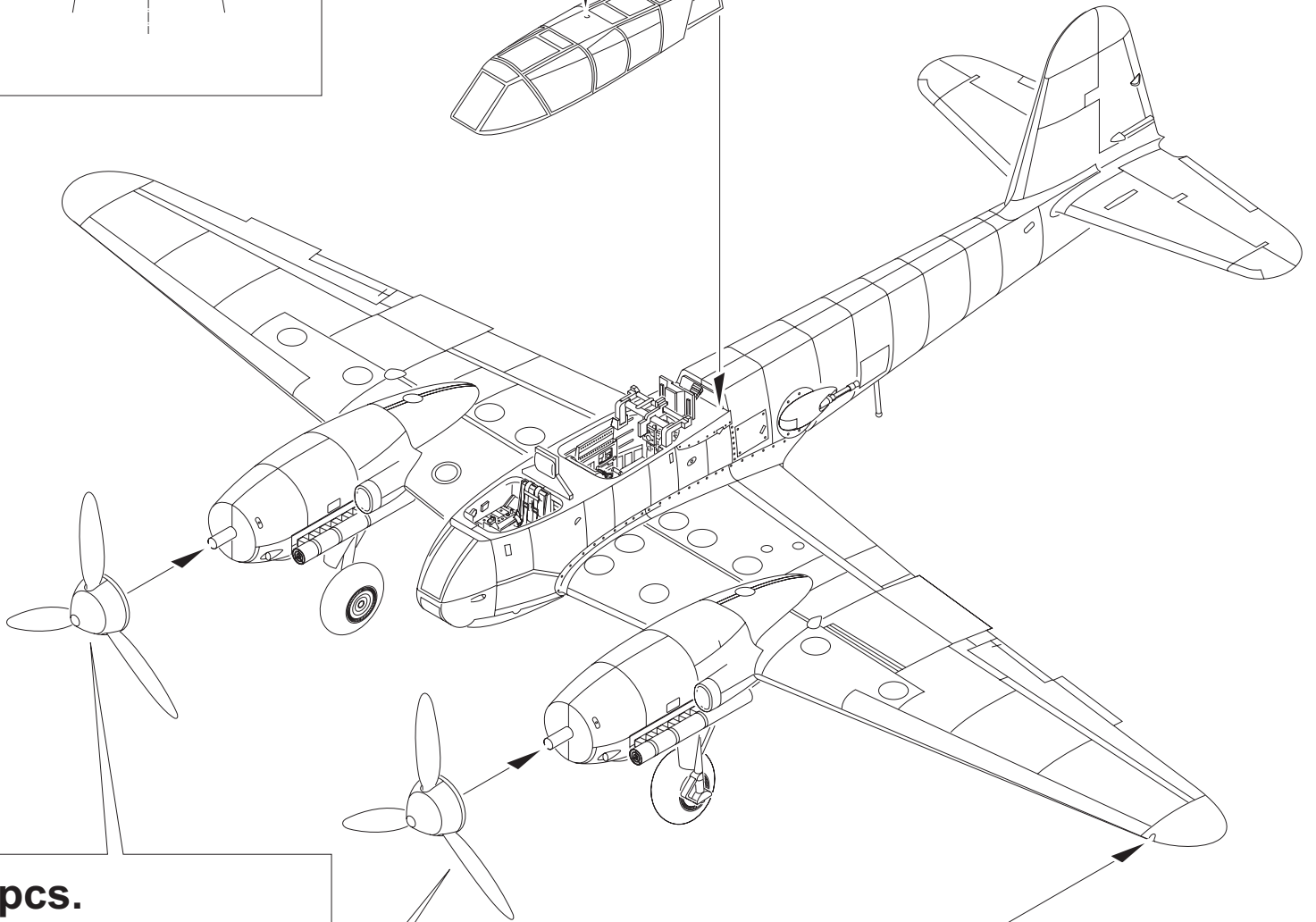
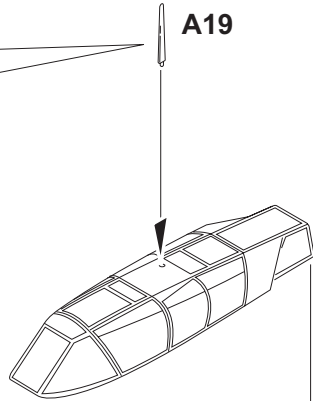
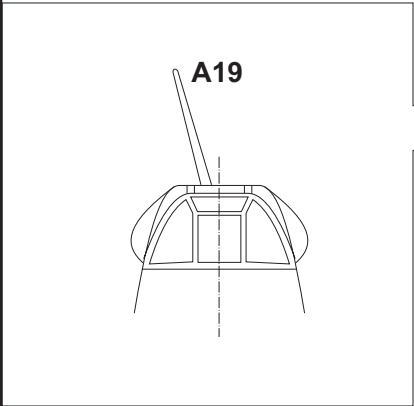

2pcs.

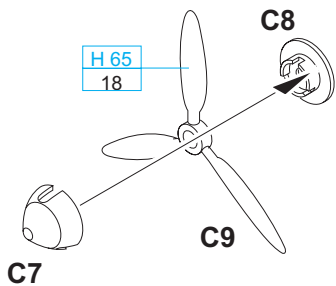

A21

GUNZE		APPROXIMATE COLOR MATCH					
AQUEOUS	Mr.COLOR			TAMIYA	HUMBROL	REVELL	TESTORS
H 2	2	BLACK / SCHWARZ / NOIR / ČERNÁ	RLM 22	X 1	21	7	1747
H 8	8	SILVER / SILBER / ARGENT / STŘÍBRNÁ		X 11	11	90	1546
H 11	62	WHITE / WEIß / BLANC / BÍLÁ	RLM 76	XF 2	34	5	1768
H 12	33	BLACK / SCHWARTZ / NOIR / ČERNÁ		XF 1	33	8	1749
H 47	71	RED BROWN / ROTBRAUN / ROUGE BRUN / ČERVENOHNĚDÁ		XF 64	111	85	1793
H 64	17	DARK GREEN / DUNKELGRÜN / VERT FONCÉ / TMAVĚ ZELENÁ	RLM 71		163	363	2081
H 65	18	BLACK GREEN / SCHWARZGRÜN / VERT FONCÉ / TMAVĚ ZELENÁ	RLM 70	XF 27	91	67	
H 67	115	LIGHT BLUE / HELLBLAU / BLEU MER / SVĚTLE MODRÁ	RLM 65	XF 23		55	2078
H 68	36	GREY GREEN / GRÜNGRAU / / ŠEDOZELENÁ	RLM 74	XF 62	32		2084
H 69	37	GRAY / GRAU / FONCÉ / ŠEDÁ	RLM 75		125		1723
H 70	60	GRAY / GRAU / FONCÉ / ŠEDÁ	RLM 02		141		1723
H 77		BLACK / SCHWARTZ / NOIR / ČERNÁ		XF 1	182	8	2040
H 90	47	CLEAR RED / ROT / ROUGE / ČERVENÁ		X 27	1321	731	
H 94	138	CLEAR GREEN / GRÜN / VERT / ZELENÁ		XF 25	1325		
H 313		TAN / HELL BRAUN / BRUN CLAIR / TŘÍSLOVÁ		XF 55	94	314	1576
H 344		RUST / ROST / ROUILLE / REZ		XF 52	113		
H 417	117	HELLGRAU / HELLGRAU / GRIS CLAIR / SVĚTLE ŠEDÁ	RLM 76		175		
	116	BLACK GREY / SCHWARZGRAU / GRIS FONCÉ / TMAVĚ ŠEDÁ	RLM 66		32	9	
Mr.METAL COLOR							
MC214		DARK IRON / DUNKEL EISEN / GRIS MÉTAL / KOV. ČERNÁ		X 10	53		1795

COMING NEXT

7029 - Me 410 Hornise

LOOK FOR XS 559 Me 410 CAMOUFLAGE SCHEME MASK

A Me 410 A-1 of 1./KG 51 Edelweiss France 1944

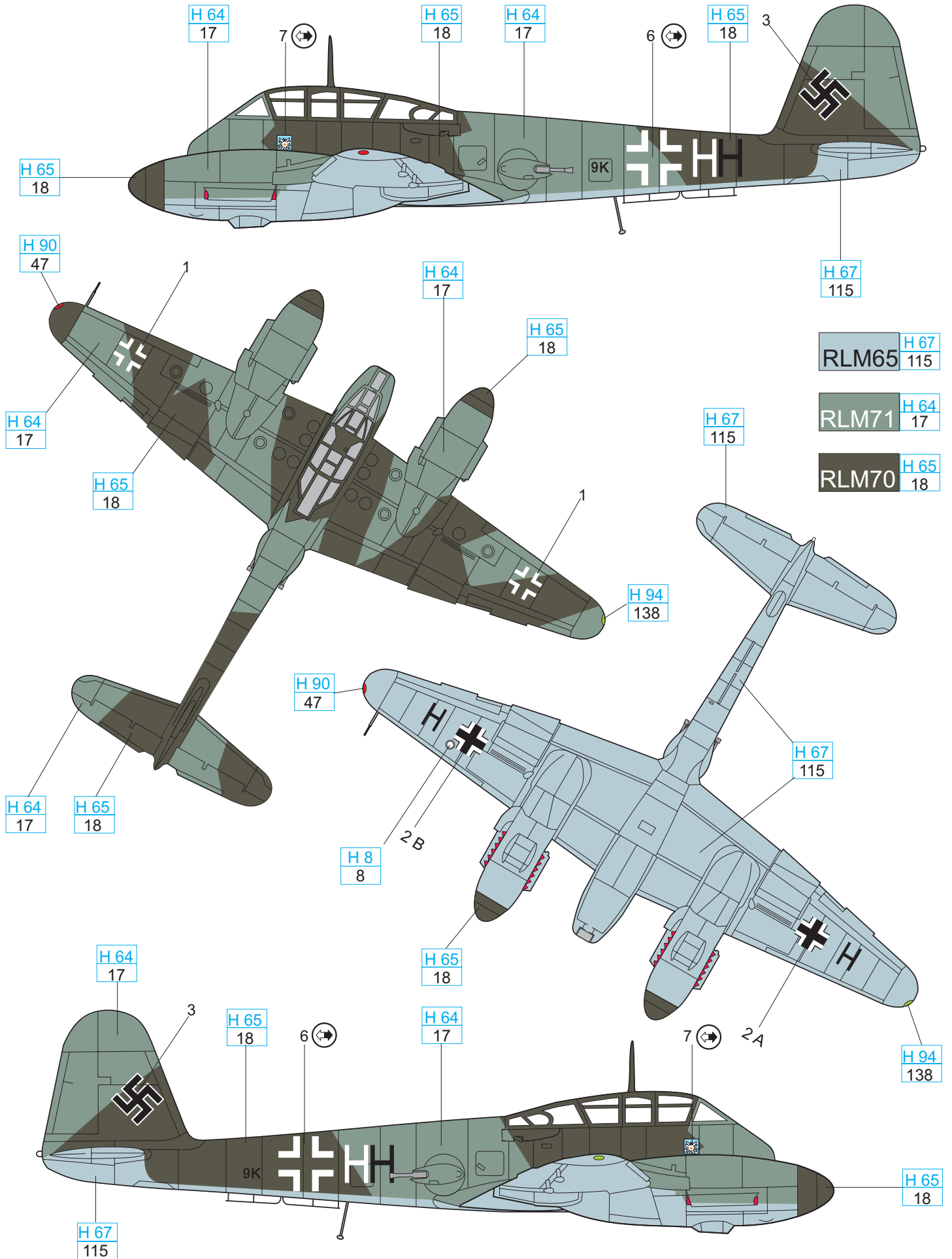

B Me 410 A-1 of 1./KG 51 Edelweiss France 1944

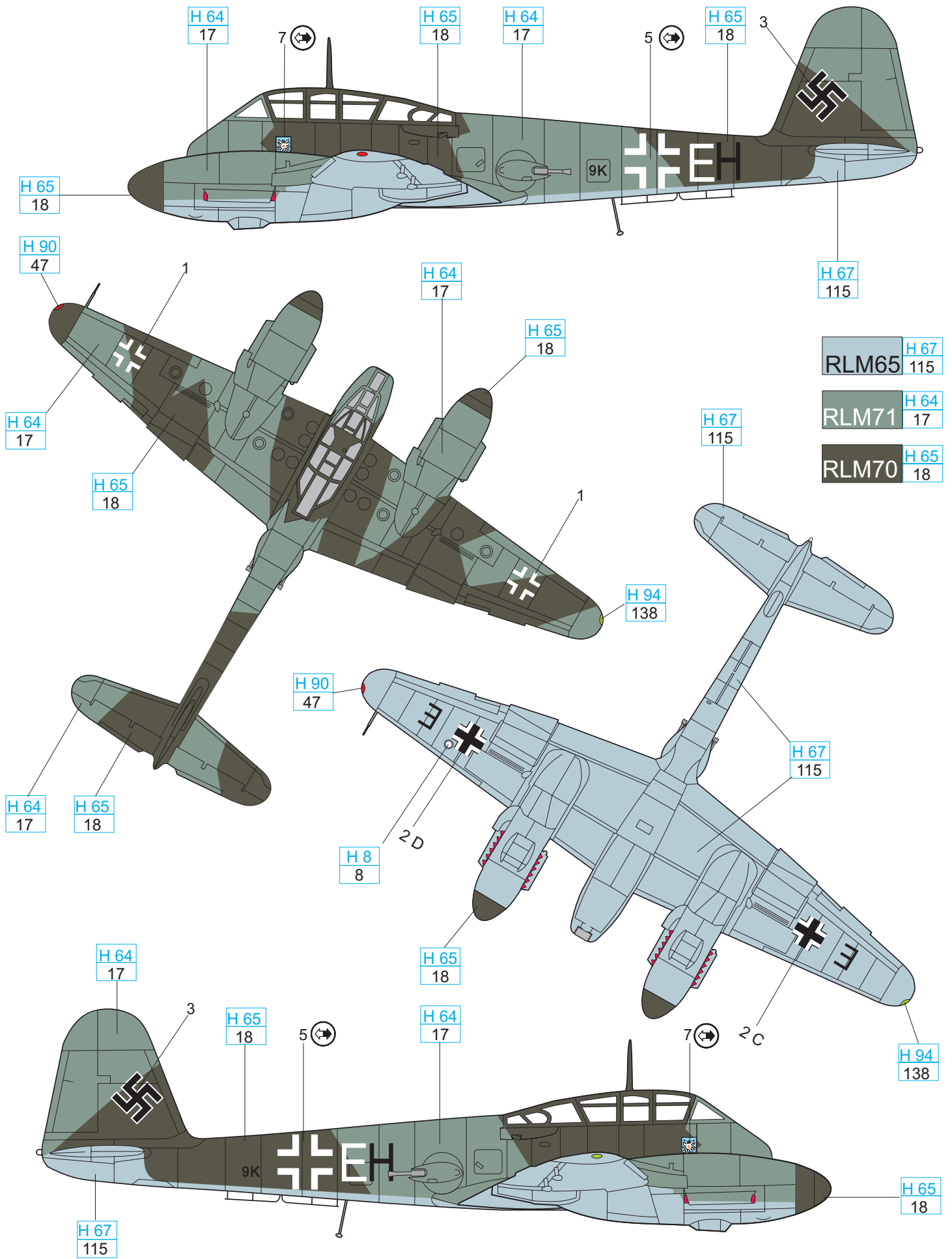

RLM65	H 67 115
RLM71	H 64 17
RLM70	H 65 18

H 64 17
 H 65 18
 H 90 47
 H 64 17
 H 65 18
 H 64 17
 H 65 18
 H 94 138
 H 8 8
 H 64 17
 H 65 18
 H 64 17
 H 65 18
 H 67 115
 H 94 138
 H 65 18

C Me 410 B-1/ of 14./KG 2. France 1944

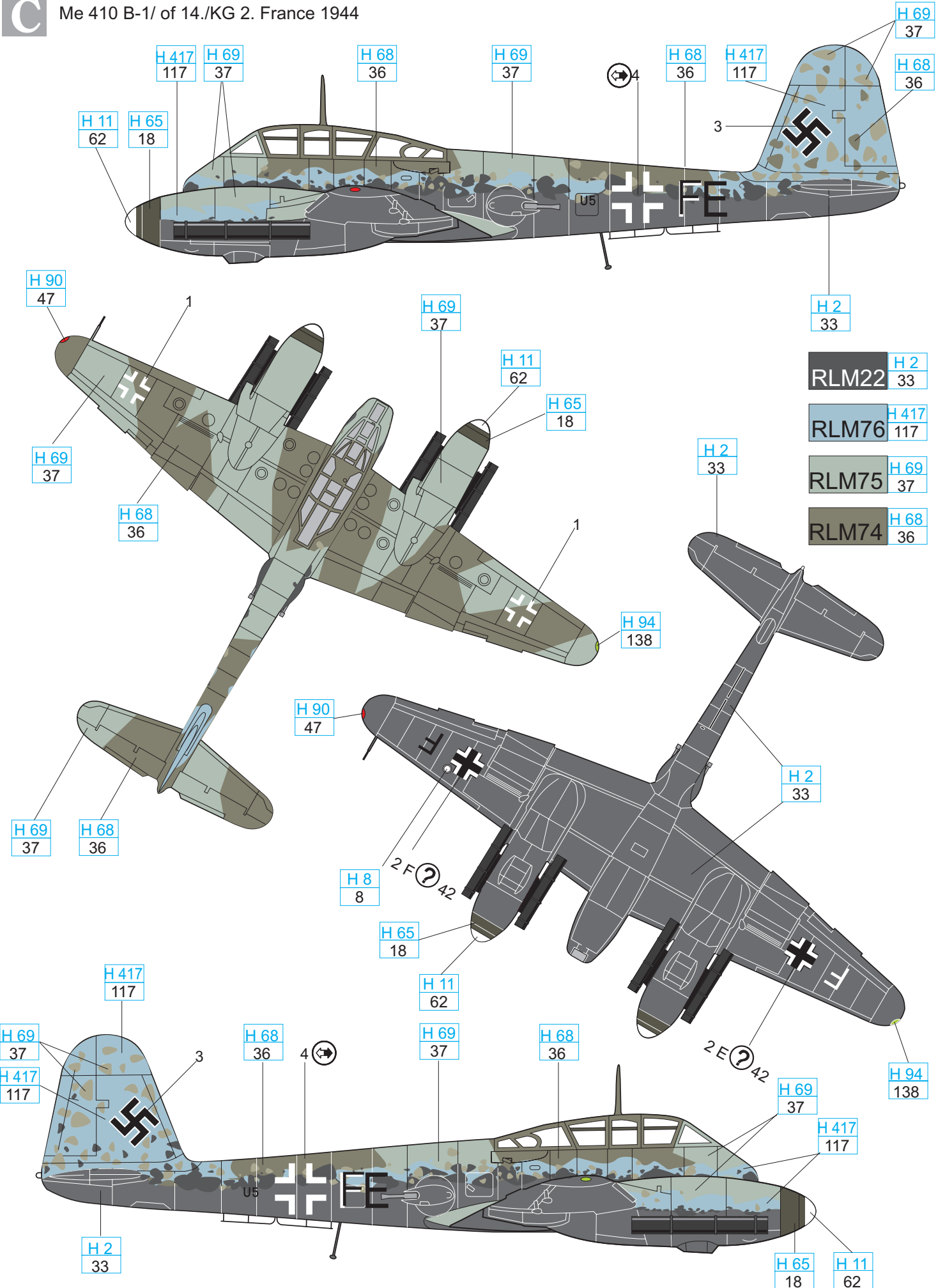

- | | |
|-------|--------------|
| RLM22 | H 2
33 |
| RLM76 | H 417
117 |
| RLM75 | H 69
37 |
| RLM74 | H 68
36 |

eduard
Express Mask

7027

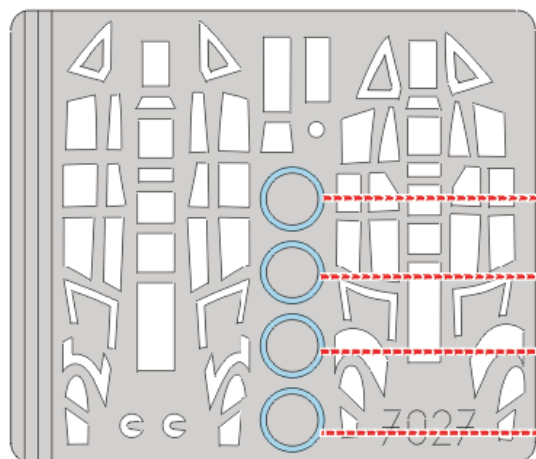
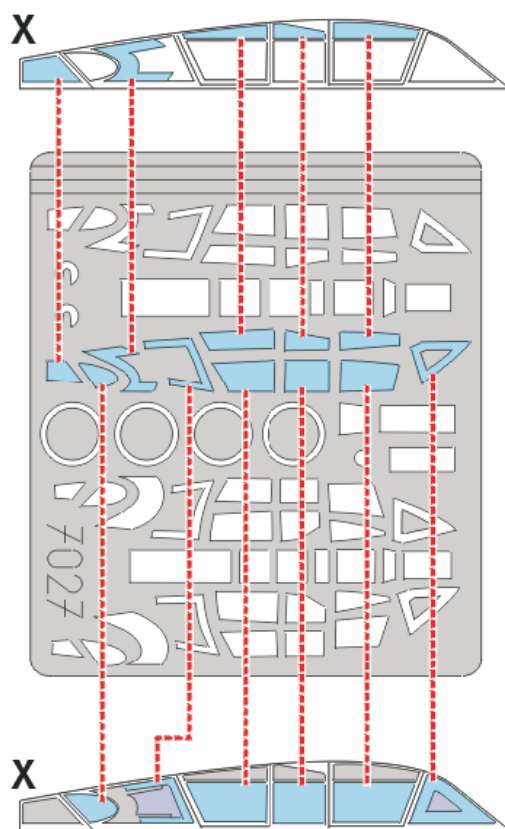
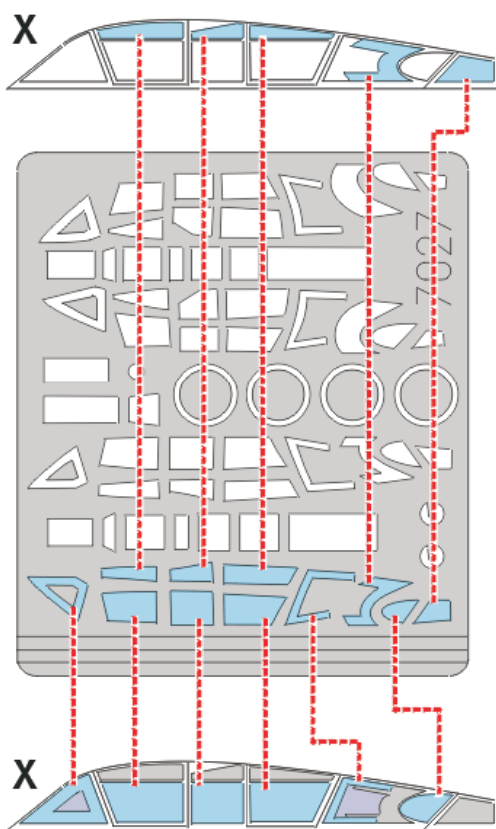
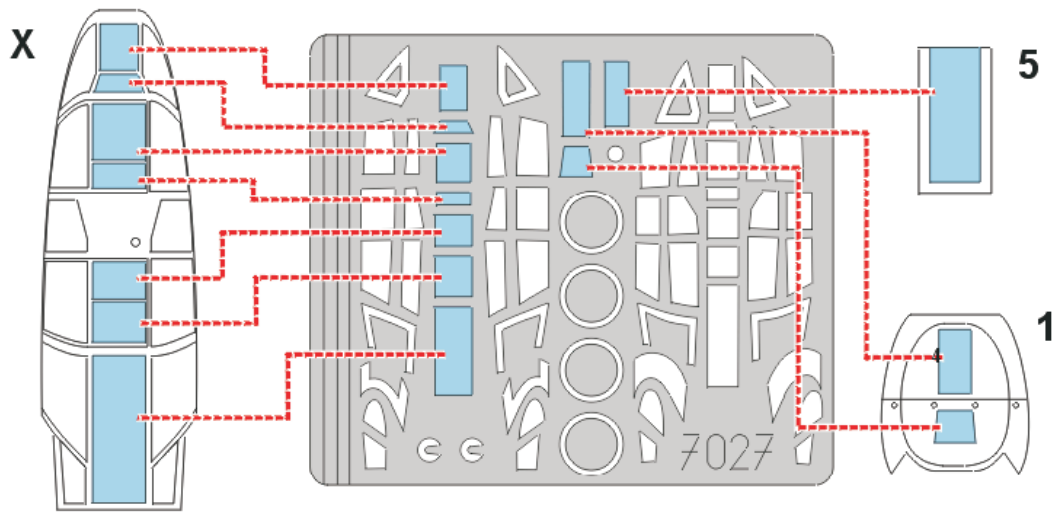
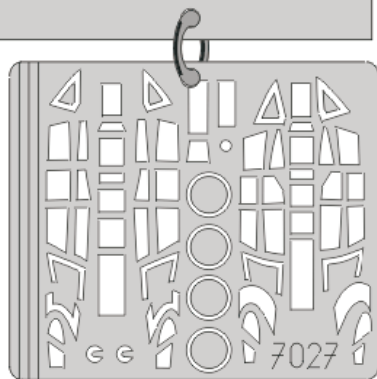

2pcs.

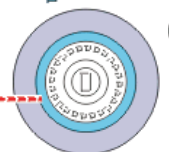

C10

2pcs.

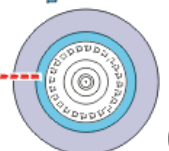

C11

2pcs.

RP16



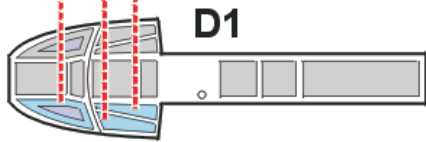
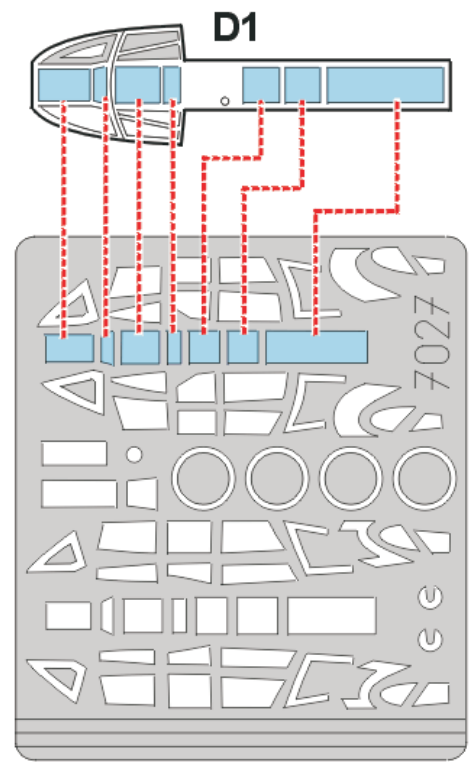
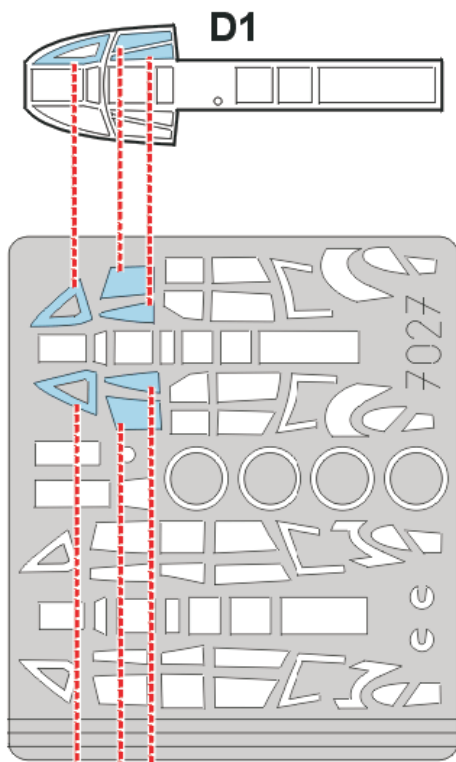

LIQUID MASK ■

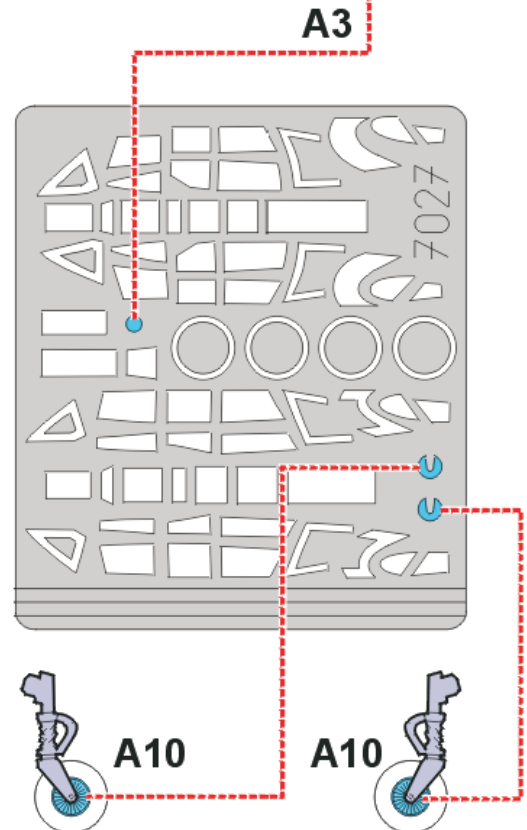
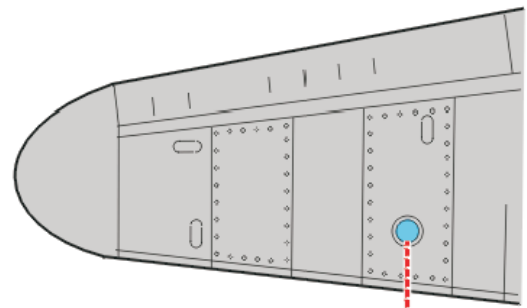
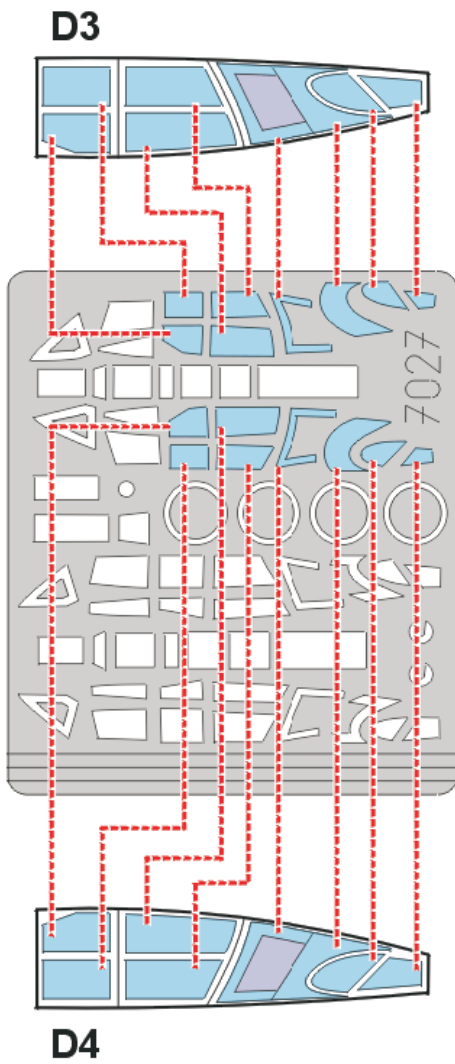

Me410 - Stencil Data

Inner side of left engine

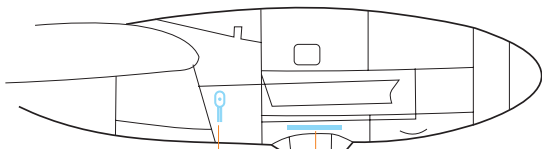

16

18

Inner side of right engine

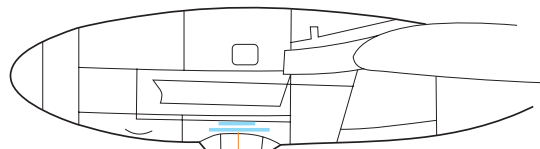

27

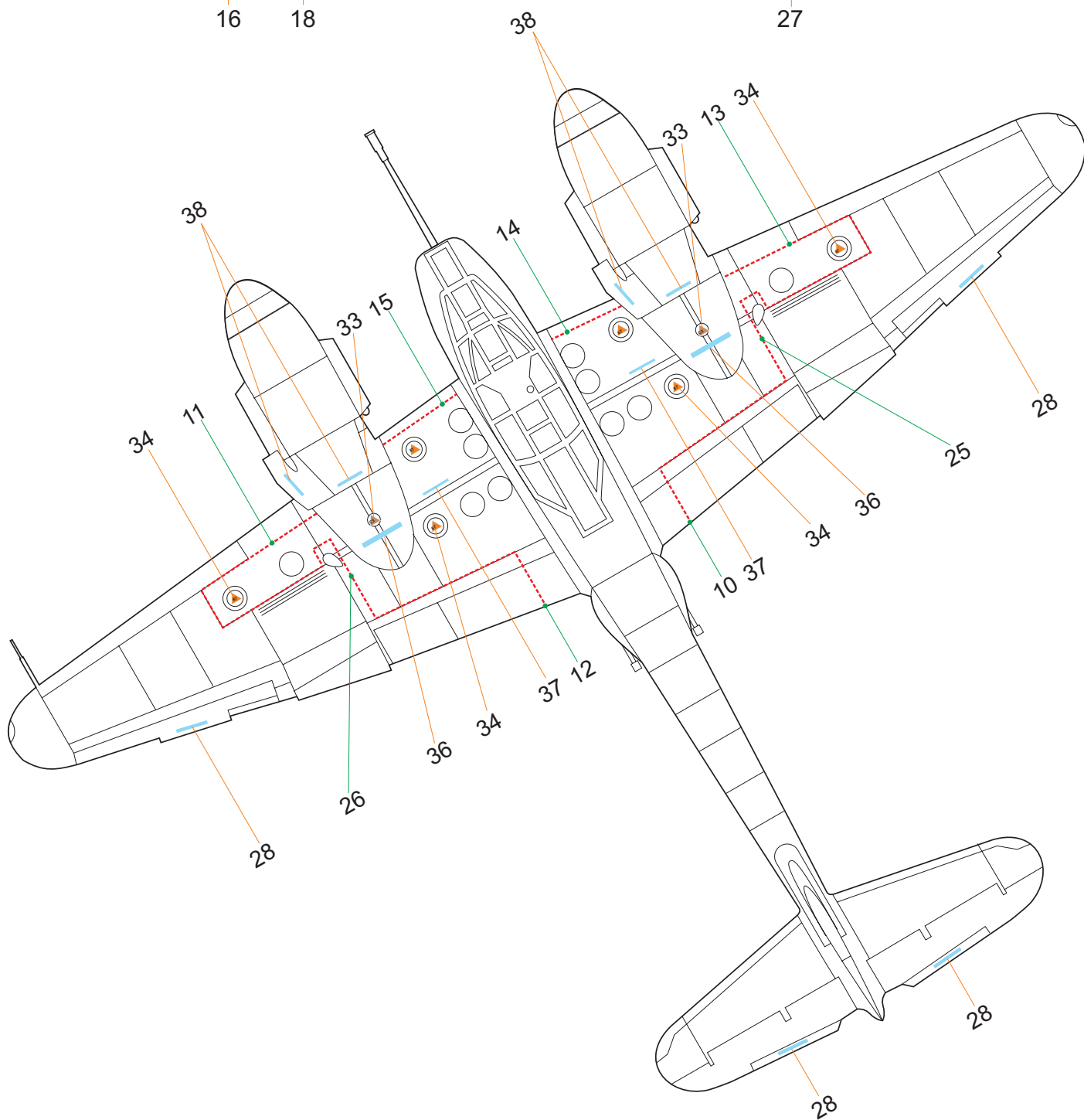

38

33

15

14

33

13

34

34

11

25

28

10

37

34

36

37

12

36

34

26

28

28

28

Me410 - Stencil Data

