

Roland C.II

eduard

GERMAN WWI RECONNAISSANCE AND BOMBER BIPLANE

1/48 SCALE PLASTIC KIT

ProfIPACK
edition

#8043



INTRO

When the new Roland C.II biplane reached the front lines in March 1916, they were the smallest, fastest and best climbing class "C" aircraft in German service. Although the Roland had the same 160 HP Mercedes D.III engine like other class "C" (armed, double seat, single engine biplanes) aircraft, its revolutionary streamlined design proved to be about 30 km/h faster than the others. This meant that the Roland was equal in speed with Nieuport 11s or Sopwith Pups, the best allied fighters at the time. Rolands served as long range reconnaissance, bomber and artillery observation aircraft in the front line for more than a year, until mid 1917. In late 1916 the Roland was successfully employed in a night bomber role. It was always a respectable opponent, for example the British ace Capt. Ball, who had shot down 17 Roland C.II's, said that the Roland was the best German fighting aircraft in 1916. The German pilots, however, were not so keen, and there were a lot of criticisms to the in-effective rudder, which limited the Roland's usage in dog-fights, and lack of the forward and downward vision which made landings very hazardous. Beyond these bars, the Roland C.II served to the late 1917, and still remains to be one of the best known World War One combat aircraft.

ÚVODEM

Když v březnu 1916 přišly k frontovým jednotkám nové dvouplošníky Roland C.II, byly to nejmenší, nejrychlejší a nejlépe stoupající stroje kategorie "C"(ozbrojené, dvousedadlové, jednomotorové dvouplošníky). Ačkoli byl Roland C.II poháněn stejným motorem Mercedes D.III o výkonu 160 k, jeho revoluční, aerodynamická konstrukce mu dovolila dosáhnout až o 30 km/h vyšší maximální rychlost než ostatním typům této kategorie. To znamená, že dosahoval srovnatelné maximální rychlosti jako Nieuport 11 nebo Sopwith Pup, dvě nejlepší spojenecké stíhačky té doby. Rolandy byly používány jako dálkové průzkumné, bombardovací a dělostřelecké pozorovací stroje, a na podzim 1916 byly úspěšně použity také jako noční bombardéry. Roland C.II byl vždy nebezpečný protivník, a například britské eso Capt.Albert Ball, který v roce 1916 sestřelil 17 Rolandů, považoval Roland C.II za tehdejší nejlepší německý bojový stroj. Ovšem, jak už to bývá, němečtí piloti nebyli až tak nadšeni. Na Rolandy se snažela vlna kritiky pro nedostatečnou účinnost malých ocasních ploch, což snižovalo jejich hodnotu v soubojích, a na nedostatečný výhled dopředu a dolů, což činilo přistání s Rolandem vždy nebezpečným manévrem. Přes tyto výhrady sloužil Roland C.II v první linii dlouho do roku 1917, a až do dnešních dnů zůstává jedním z nejnámějších bojových letadel První světové války.

ATTENTION



UPOZORNĚNÍ



ACHTUNG



ATTENTION



注意



Carefully read instruction sheet before assembling. When you use glue or paint, do not use near open flame and use in well ventilated room. Keep out of reach of small children. Children must not be allowed to suck any part, or pull vinyl bag over the head.



Před započítím stavby si pečlivě prostudujte stavební návod. Při používání barev a lepidel pracujte v době větrané místnosti. Lepidla ani barvy nepoužívejte v blízkosti otevřeného ohně. Model není určen malým dětem, mohlo by dojít k požití drobných dílů.

INSTRUCTION SIGNS * INSTR. SYMBOL * INSTRUKTION SINNBILDEN * SYMBOLES * 記号の説明

OPTIONAL
VOLBABEND
OHNOUTOPEN HOLE
VYVRTAT OTVORSYMETRICAL ASSEMBLY
SYMETRICKÁ MONTÁŽREMOVE
ODRÍZNOUTREVERSE SIDE
OTOČIT

PARTS



DÍLY



TEILE



PIÈCES



部品

PLASTIC PARTS

A>

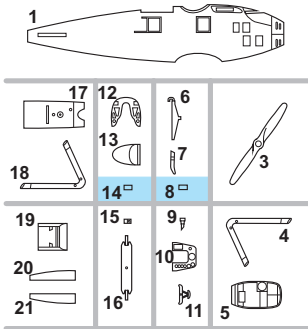

B>

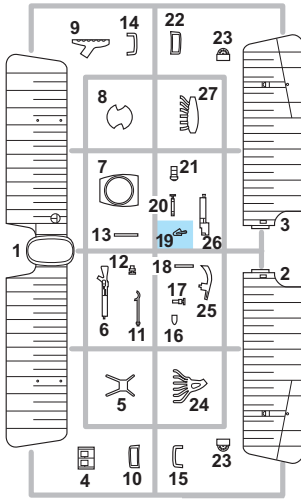

C>

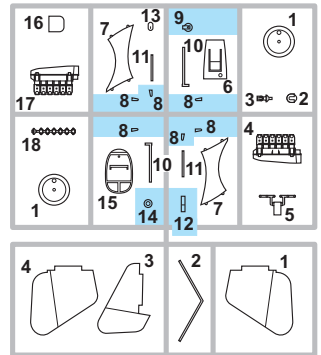

F>

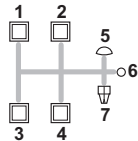
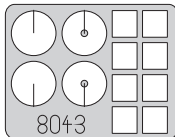
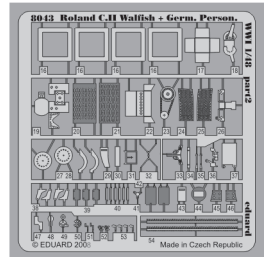
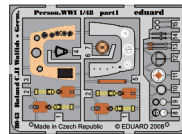
eduard
MASKPE - PHOTO ETCHED
DETAIL PARTS

-Parts not for use. -Teile werden nicht verwendet. -Pièces à ne pas utiliser. -Tyto díly nepoužívejte při stavbě. - 使用しない部品

COLOURS



BARVY



FARBEN



PEINTURE



色

GSI Colors (GUNZE)		
AQUEOUS	Mr. COLOR	
[R11]	C8	SILVER
[R111]	C62	WHITE
[R1R2]	C33	BLACK
[R1R2]	C43	WOOD BROWN
[R1R2]	C40	VIOLET
[R1R2]	C41	RED BROWN
[R1R2]	C13	GRAY
[R1R2]	C303	GREEN
[R1R2]	C338	LIGHT GRAY

AQUEOUS	Mr. COLOR	
[R1R2]	[C117]	RUST
[R1R2]	[C123]	LIGHT GRAY
[R1R2]	[C123]	DARK GREEN
Mr. METAL COLOR		
[R1R2]	[C121]	DARK IRON
[R1R2]	[C121B]	ALUMINIUM
[R1R2]	[C121C]	BRASS
Mr. COLOR SUPER METALLIC		
[R1R2]	[C121]	SUPER FINE SILVER

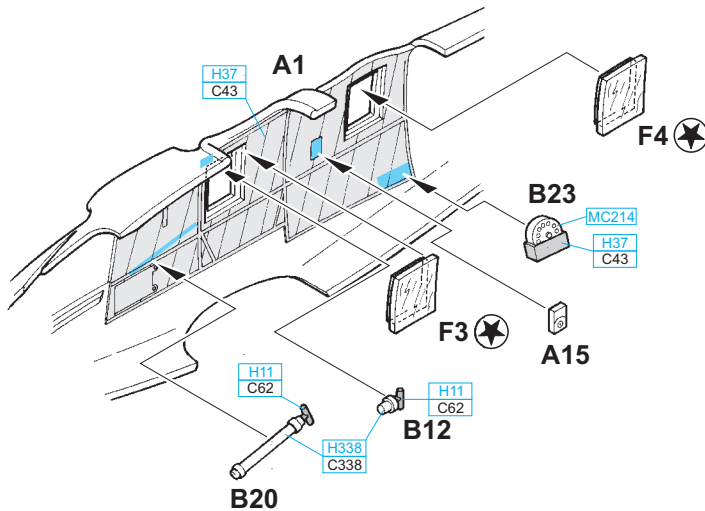
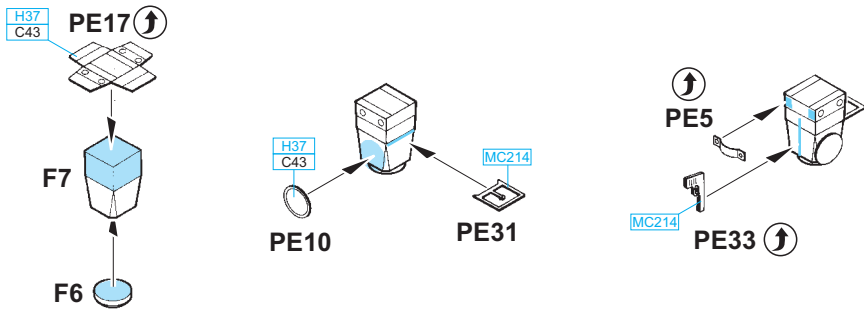
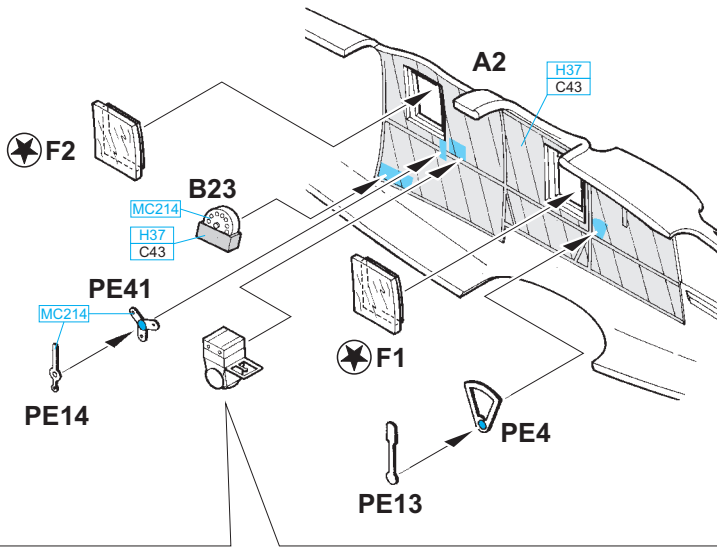

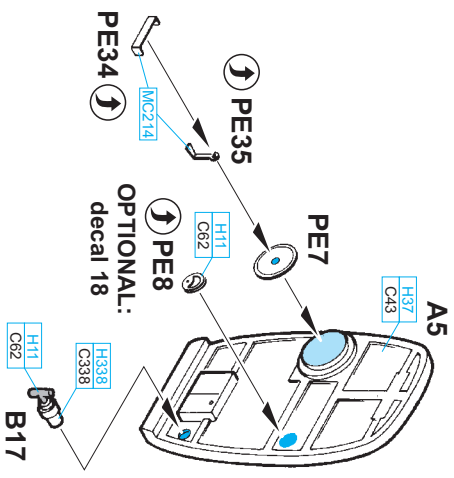
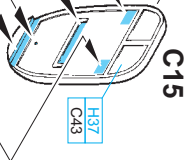
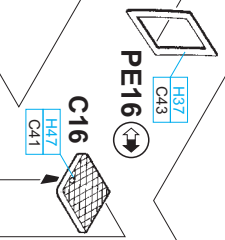
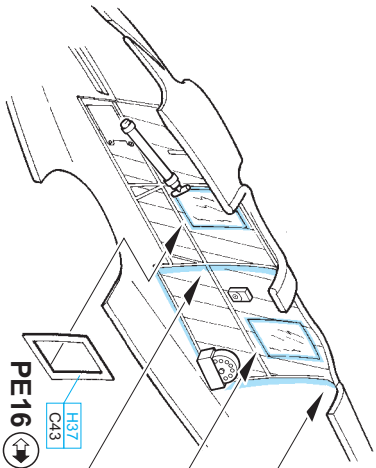

OPTIONAL:
decal 18

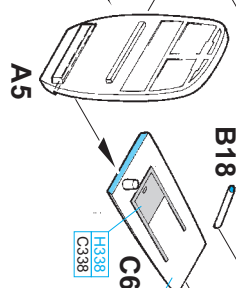

A 

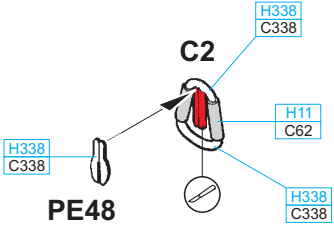

B

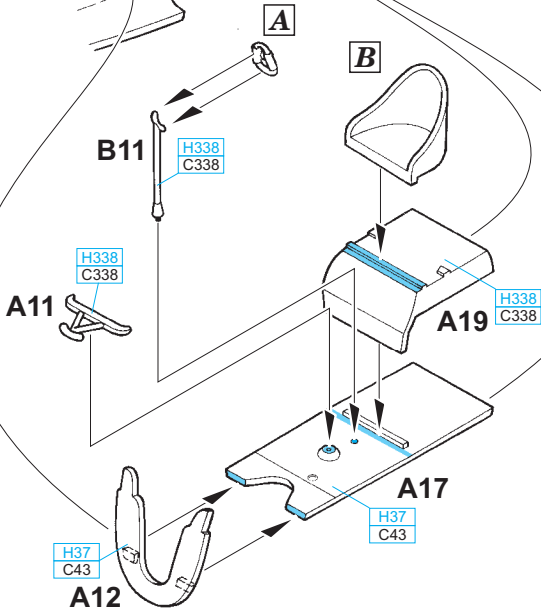
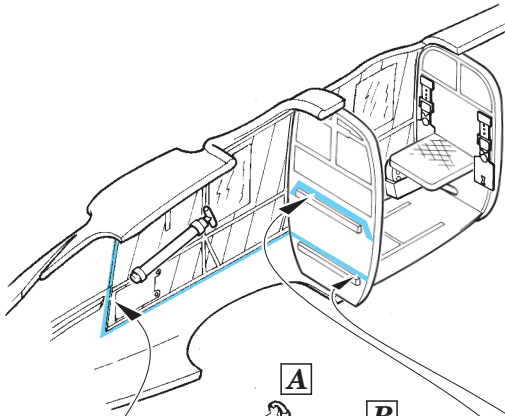
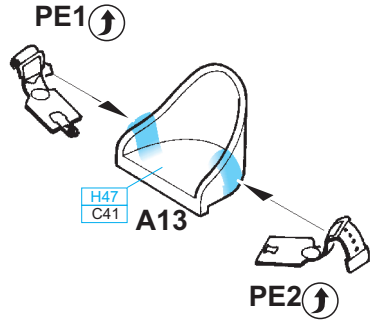

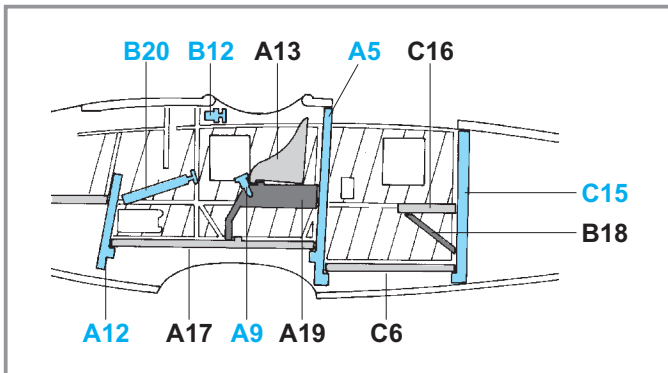
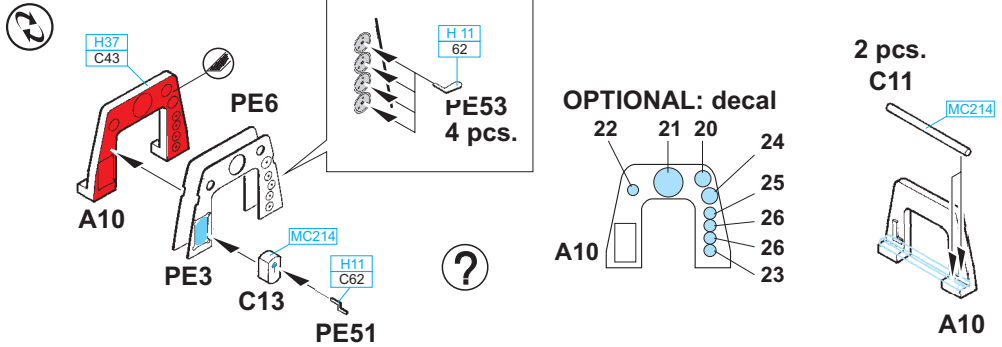
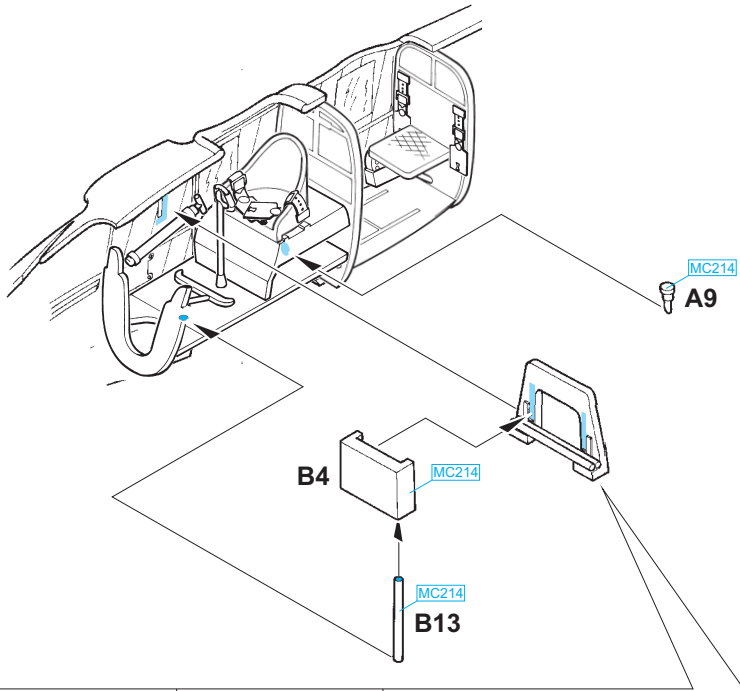

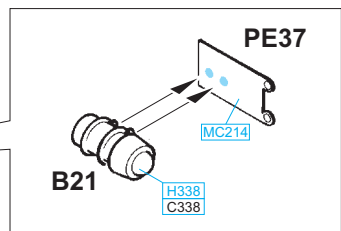
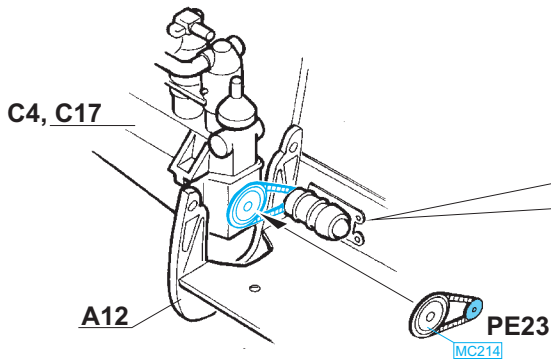
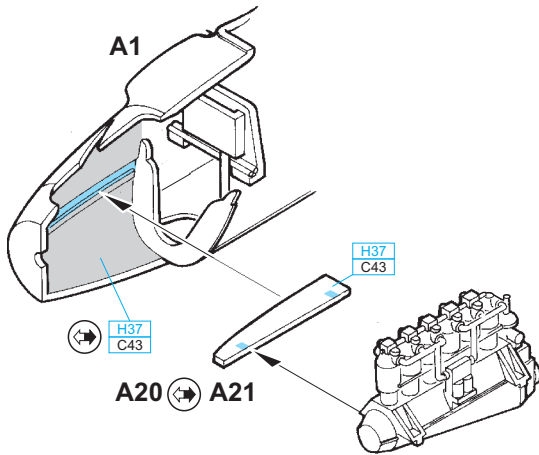
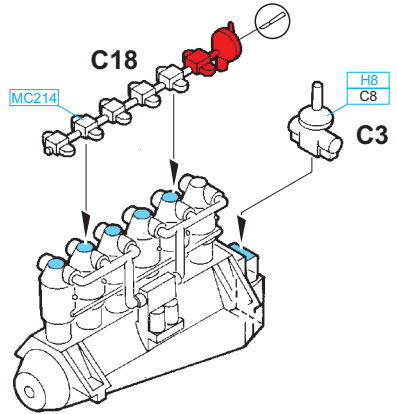
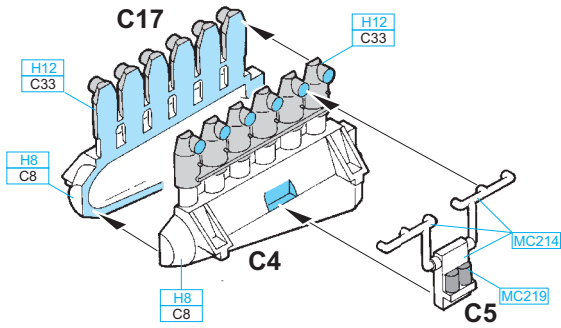

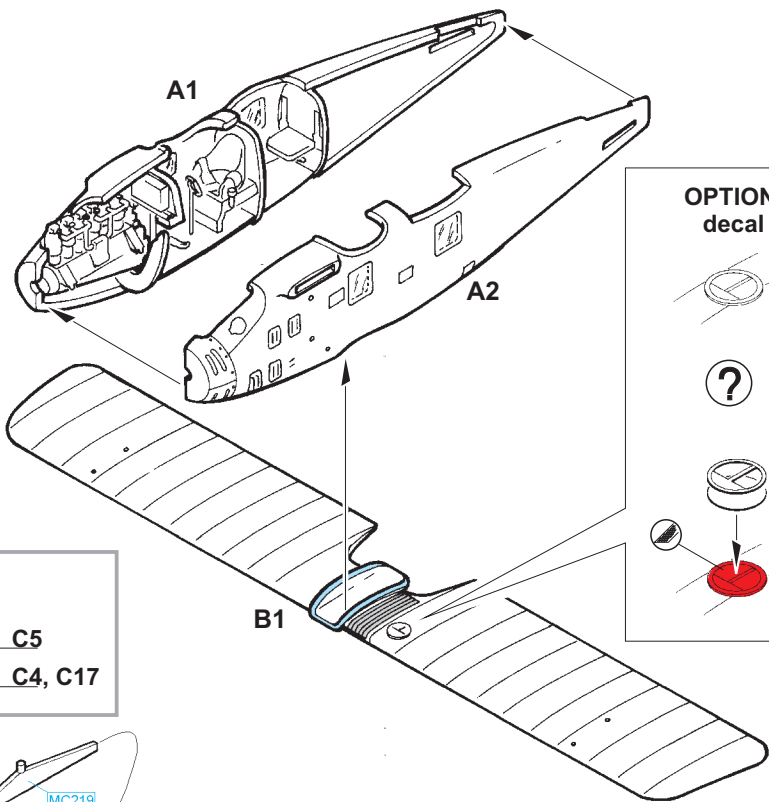

**OPTIONAL:
decal 17**

B1

?

PE12

PE11

B1

A6

C5

C4, C17

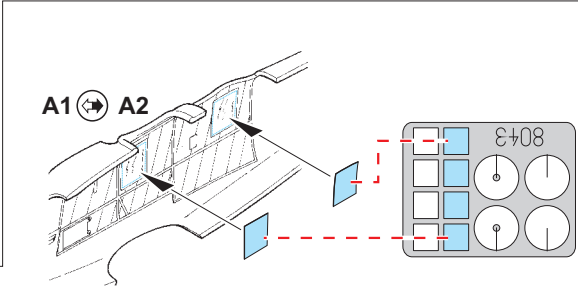
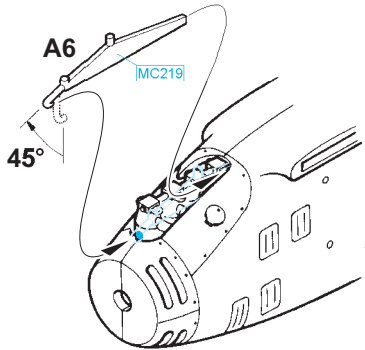

8043

C1 2 pcs.

C1 2 pcs.

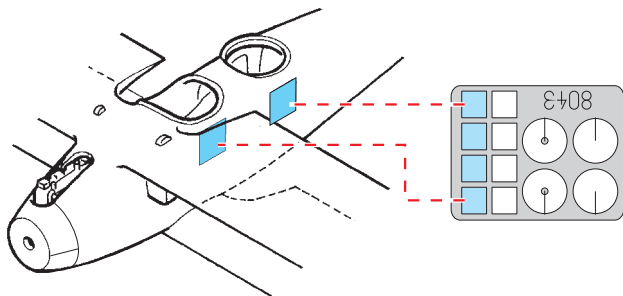

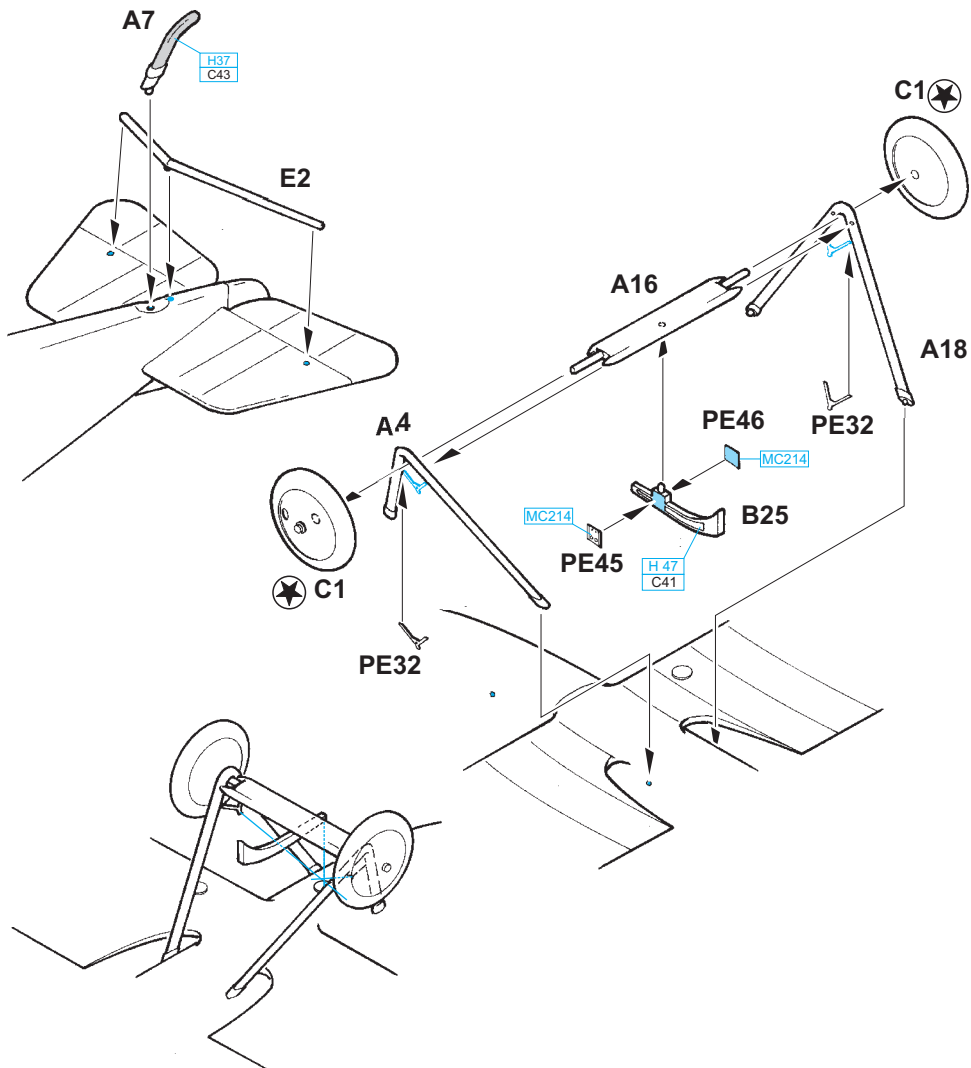

C MARKINGS **A**; **B**; **C** ONLY

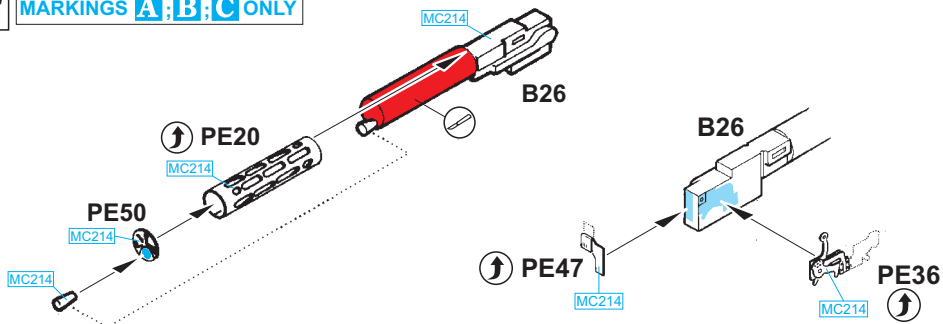

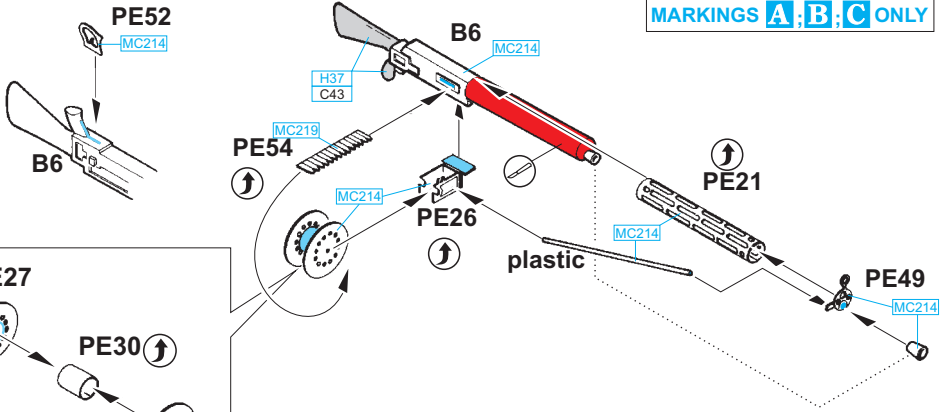
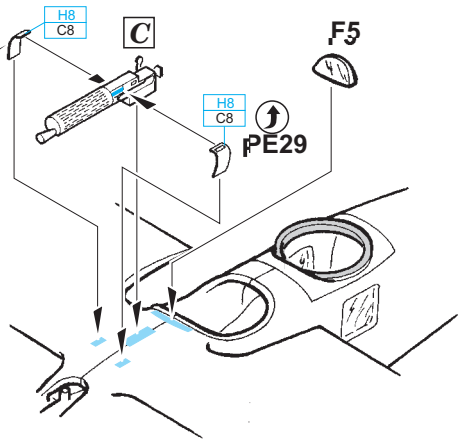
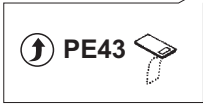
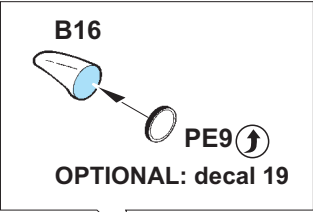
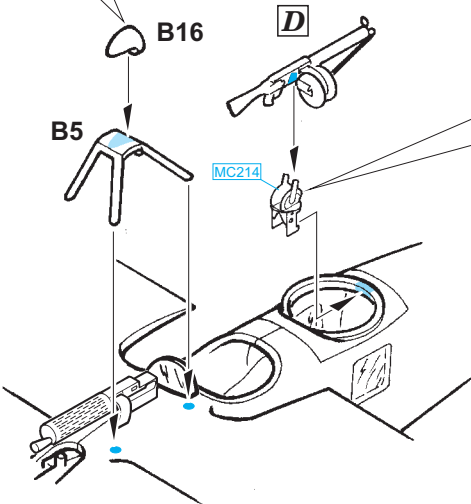
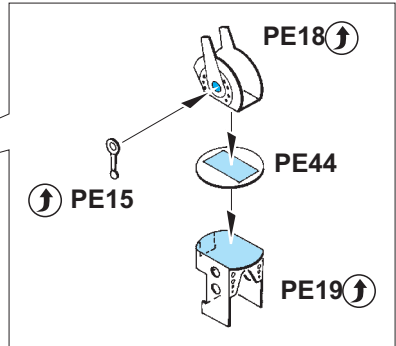
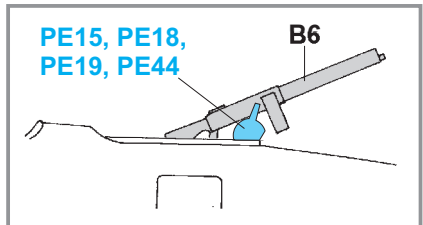
D**MARKINGS A; B; C ONLY****PE27****PE30** (up arrow)**PE27****PE43** (up arrow)**B16****PE9** (up arrow)**OPTIONAL: decal 19****B16****D****B5****MC214****PE18** (up arrow)**PE44****PE19** (up arrow)**PE15** (up arrow)**PE15, PE18, PE19, PE44****B6**

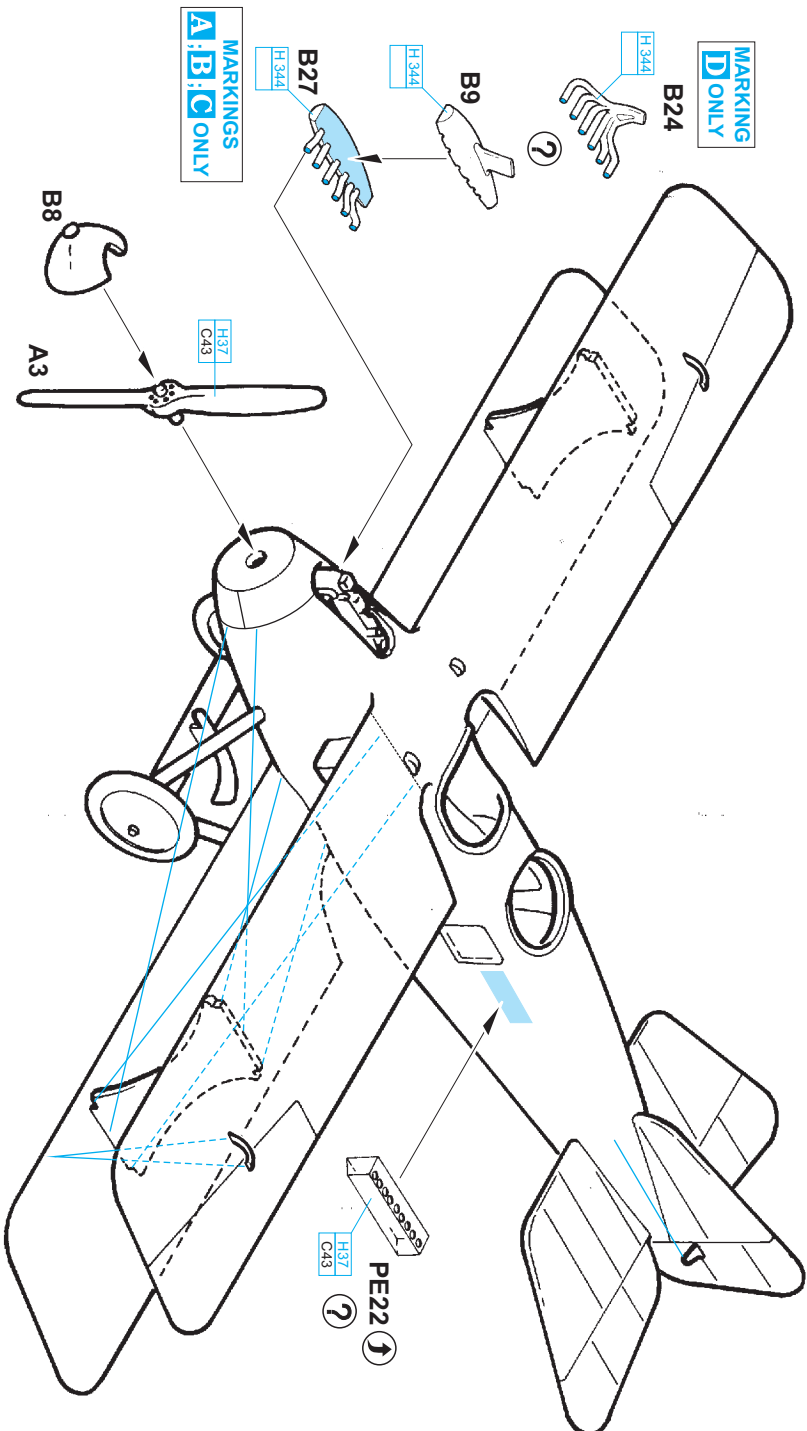

A flown by Lt. Seibert and Hptm. Pflieger, FFA 5b, Western Front, Fall 1916

The crew consisting of pilot Lt. Seibert and observer Hptm. Pflieger flew this aircraft over the Western Front in the fall of 1916. These aviators were members of Feldfliegerabteilung Nr.5b. The fuselage carried a fish scale motif complete with mouth and eyes on the nose of the aircraft.

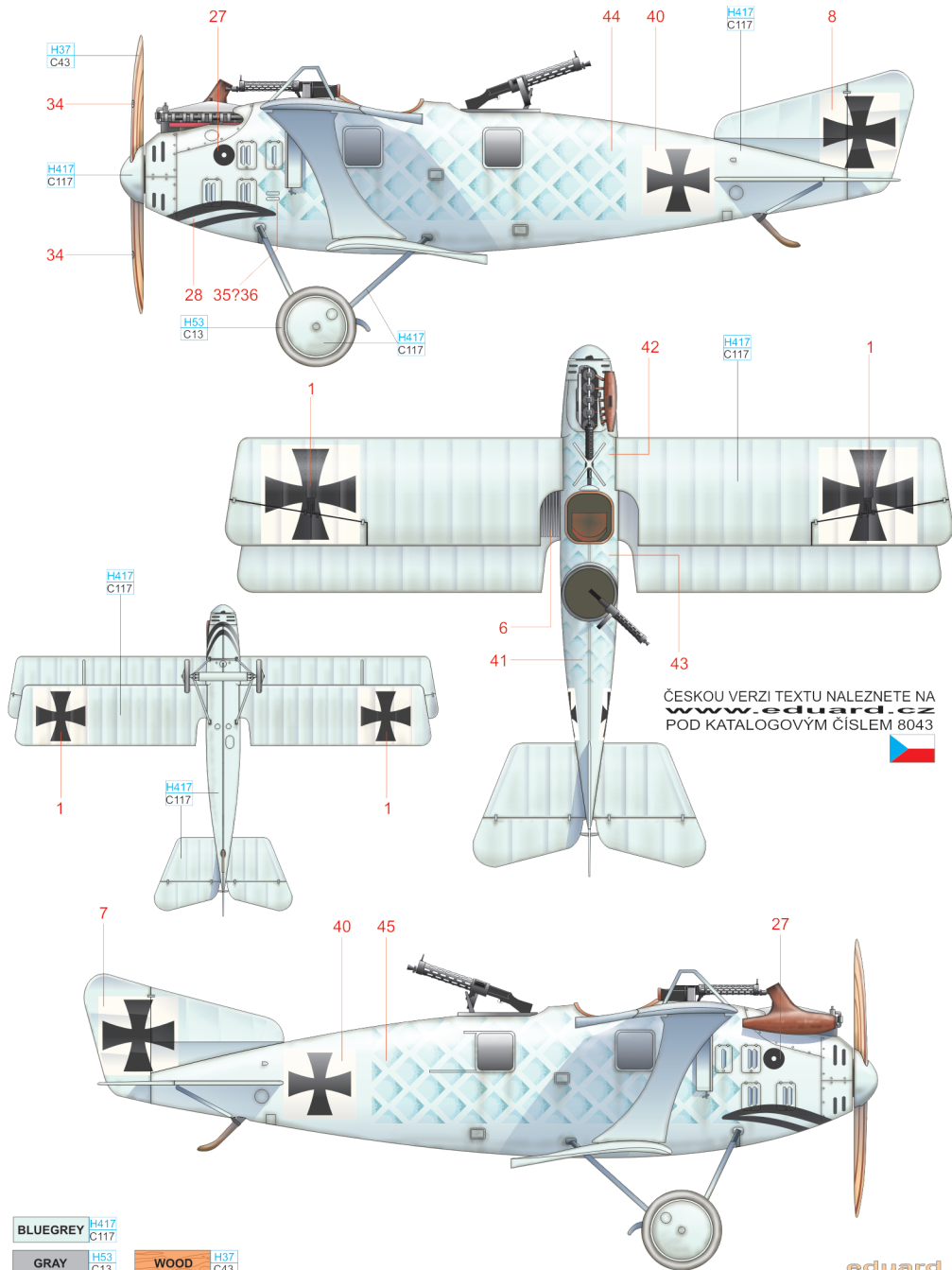

ČESKOU VERZI TEXTU NALEZNETE NA
www.eduard.cz
 POD KATALOGOVÝM ČÍSLEM 8043



B Western Front, Summer 1917

This Roland C.II was flown by a German unit serving on the Western Front. The Roland C.II fulfilled the reconnaissance role in the German Air Force as well as escort fighters when the need arose.

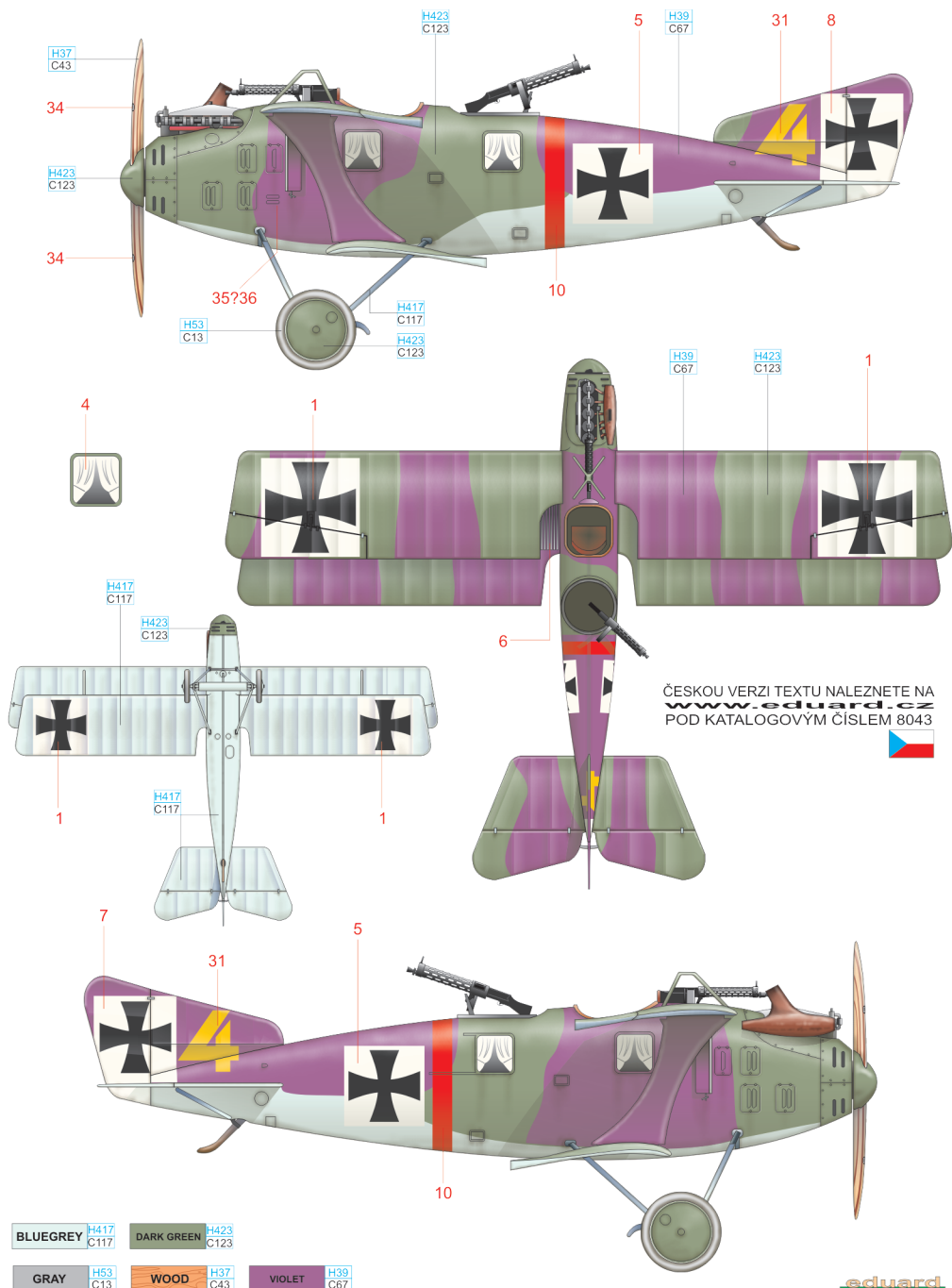

C Kasta 2, Kagohl 1, End of 1916/ Beginning of 1917

This aircraft was used by pilots of Kampfgeschwader der Obersten Heeresleitung 1 - Kagohl 1 on the Western Front. In April 1917, this unit was redesignated as Bombengeschwader der Obersten Heeresleitung 1, abbreviated as Bogohl 1.

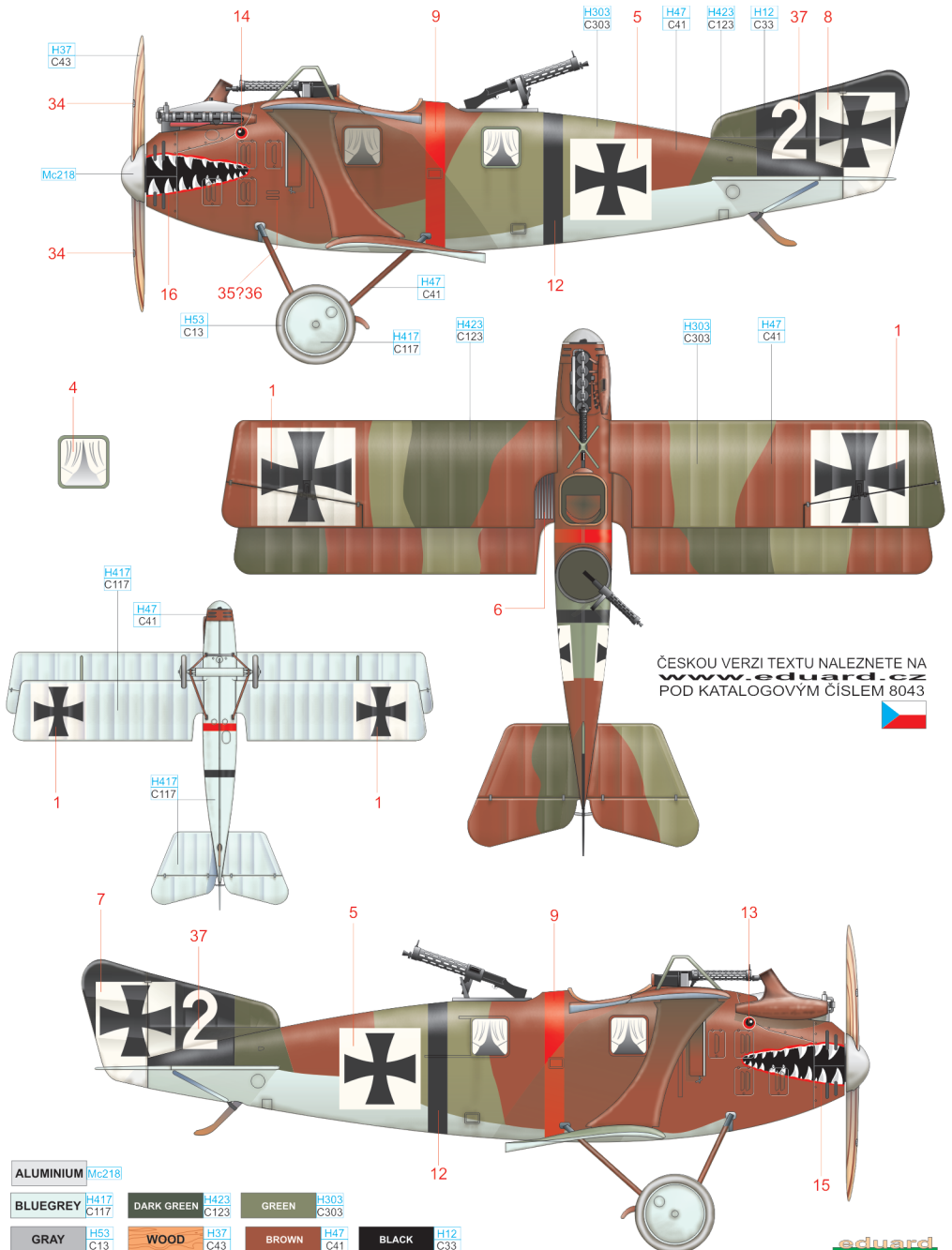

ČESKOU VERZI TEXTU NALEZNETE NA
www.eduard.cz
 POD KATALOGOVÝM ČÍSLEM 8043

ALUMINIUM	Mc218				
BLUEGREY	H417 C117	DARK GREEN	H423 C123	GREEN	H303 C303
GRAY	H53 C13	WOOD	H37 C43	BROWN	H47 C41
				BLACK	H12 G33

D 1859/16, Bayerische Flieger Schule 5, 1917

In 1917, this Roland C.II served with Bayerische Flieger Schule 5, a training unit. Aircraft with this unit had their armament removed along with the associated ring, and sandbags were placed in the rear cockpit for ballast. This was to maintain the centre of gravity.

