

Lysander Mk.III

8290

BRITISH WWII ARMY CO-OPERATION AIRCRAFT

1:48 SCALE PLASTIC KIT



eduard

ProfiPACK



intro

Lysandros, the hero of ancient Greece, stepped into the history books as the commanding officer of the Spartan Army. With his victory over Athens in 404 BC, he was able to end the Peloponnesian war. He had a relatively strong impact on the power structure of Greece at the time, and was elevated to the status of one of the most influential of Spartan chieftains. He lost his life on the battlefield in 395 BC.

The military career of Lysandros was without a doubt the reason behind its use in the naming of the well-known aircraft built by Westland, understandably in its anglicized form, Lysander.

The roots of the machine go back to 1934, when the British air ministry decided to replace their army co-operation aircraft, the Hawker Hector. Three firms responded to Specification A39/34 - Hawker, Avro and Bristol. Initially, Westland was not involved, but also received an invitation.

The Westland aircraft received the factory designation P.8, and its designer, Arthur Davenport under the supervision of Teddy Petter, spent a lot of time in discussions with pilots. In this way, important and very relevant information was derived directly from army co-operation pilots, and what they needed and expected from their aircraft. It was clear that very important was the view from the cockpit, control at low speeds, and the ability to land and take-off from small fields.

The result of their work took to the air for the first time on June 15th, 1936. Because so much emphasis was placed on pilot input, the aircraft had an untraditional look. It was a high wing layout with a greenhouse canopy powered by a Bristol Mercury radial engine. The fixed landing gear was covered by large spats that could mount bomb racks. The unorthodox look of the airplane was accented by the shape of the wing, whose leading edge had an angle that made the wing look as though it was forward swept. The dynamics of the wing and tail surfaces gave the aircraft a minimum speed of 104km/h.

The armament was composed of two fixed 7.7mm machine guns, one in each wheel spat, and two more at the disposal of the second crew member. The Lysander could carry bombs from anti-personnel to 500lb. The two prototypes built quickly won the tender against the only competition from Bristol, and Westland received a contract for series production in September, 1936.

The first series machines, the Lysander Mk.I, reached military units in June, 1938. They served as artillery spotters, and there are also known film clips of them picking up messages during flight.

They entered combat immediately on the invasion of France and the low countries in 1940. In France, they served with four squadrons with the British Expeditionary Force. The flight characteristics also made the Lysander easy prey, indicated by the loss of 118 out of 175 committed machines in May and June, 1940. As a result, the Lysander did not distinguish itself in its intended role under combat conditions - after the fall of Dunkirk, where they dropped supplies to allied troops, they served from British islands in search and rescue operations of shot down aircrews, and as target tugs and the like. Supply drop skills were also honed in the far east combat zones. Here, they flew from bases in India in support of the Chindits, which were British special forces operating with huge losses in Burma, deep in Japanese held territory. The Lysander caught its second wind in support of the French resistance. Flying under the veil of darkness, special forces units flew operations over occupied France. They dropped many supplies and agents, and it was this type of operation that allowed the Lysander to exploit its short take-off and landing ability to its fullest. It was in this role that the Lysander earned its well deserved place in the history of aviation, and showed that the choice of name of the classical hero was a good one.

This kit offers you the opportunity to build not only the Special Duty variant of the Lysander Mk.III that served in the support of the French resistance, but also of the other British Special Forces units. Nations of occupied Europe that stood against the Germans with the British is represented by No.309 (Polish) Squadron, RAF.

ATTENTION



UPOZORNĚNÍ



ACHTUNG



ATTENTION



注意



Carefully read instruction sheet before assembling. When you use glue or paint, do not use near open flame and use in well ventilated room. Keep out of reach of small children. Children must not be allowed to suck any part, or pull vinyl bag over the head.



Před započatím stavby si pečlivě prostudujte stavební návod. Při používání barev a lepidel pracujte v dobře větrané místnosti. Lepidla ani barvy nepoužívejte v blízkosti otevřeného ohně. Model není určen malým dětem, mohlo by dojít k požití drobných dílů.

INSTRUCTION SIGNS ✳ INSTR. SYMBOLS ✳ INSTRUKTION SINNBILDEN ✳ SYMBOLES ✳ 記号の説明

OPTIONAL
VOLBABEND
OHNOUOPEN HOLE
VYVRTAT OTVORSYMETRICAL ASSEMBLY
SYMETRICKÁ MONTÁŽREMOVE
ODRŽINOUTREVERSE SIDE
OTOČITAPPLY EDUARD MASK
AND PAINT
POUŽÍJ EDUARD MASK
NABARVIT

PARTS



DÍLY



TEILE



PIÈCES



部品

PLASTIC PARTS

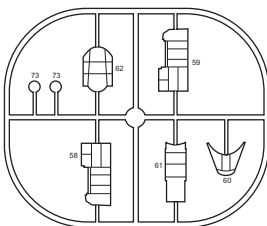
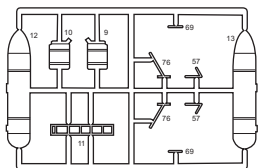
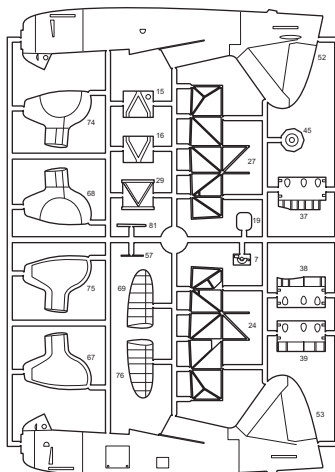
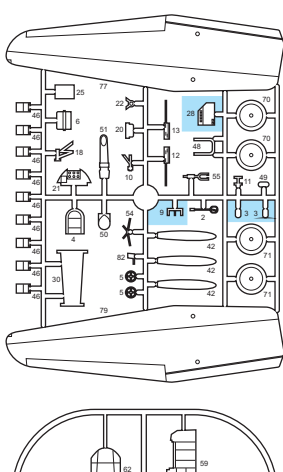
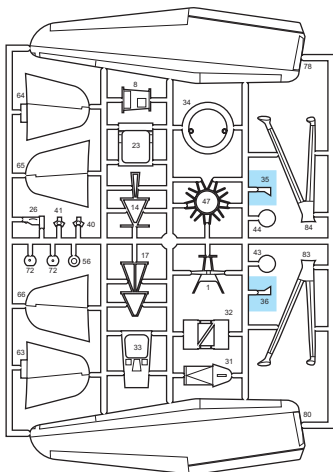
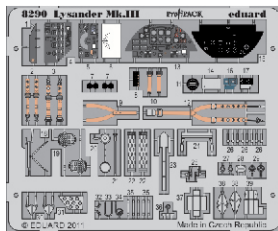
PE - PHOTO ETCHED
DETAIL PARTS

RP - RESIN PARTS

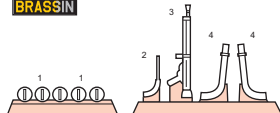

FILM



-Parts not for use. -Teile werden nicht verwendet. -Pièces à ne pas utiliser. -Tyto díly nepoužívejte při stavbě. -使用しない部品

COLOURS



BARVY



FARBEN



PEINTURE



色

GSI Creos (GUNZE)		
AQUEOUS	Mr.COLOR	
[H 4]	[C4]	YELLOW
[H 8]	[C8]	SILVER
[H 11]	[C2]	WHITE
[H 12]	[C33]	FLAT BLACK
[H 33]	[C81]	RUSSET
[H 38]	[C15]	DARK GREEN
[H 37]	[C43]	WOOD BROWN
[H 47]	[C41]	RED BROWN
[H 58]	[C27]	INTERIOR GREEN

AQUEOUS	Mr.COLOR	
[H 2]	[C22]	DARK EARTH
[H 4]	[C26]	SKY
[H 35]	[C35]	MEDIUM SEAGRAY
Mr.METAL COLOR		
[M 214]		DARK IRON
[M 16]		BRONZE
[M 18]		ALUMINIUM
[M 218]		BRASS
Mr.COLOR SUPER METALLIC		
[SM 1]		SUPER CHROME

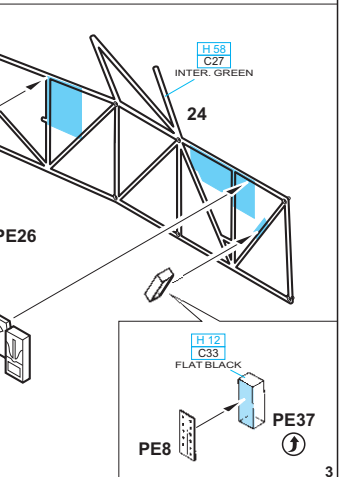
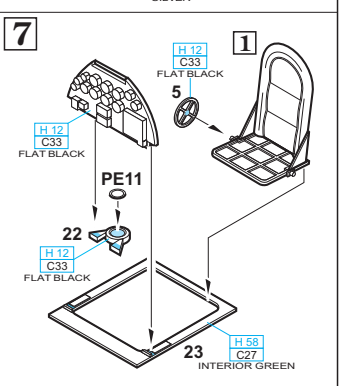
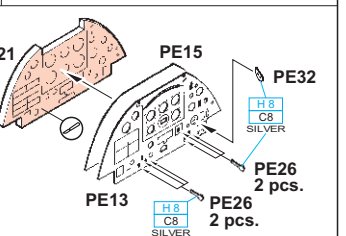
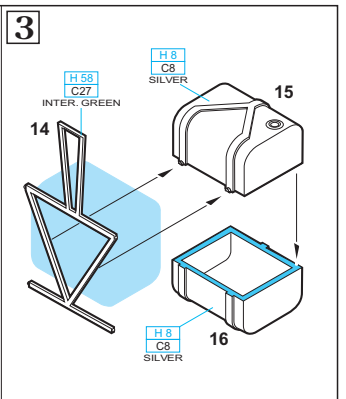
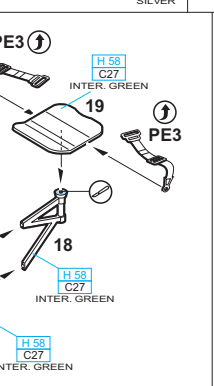
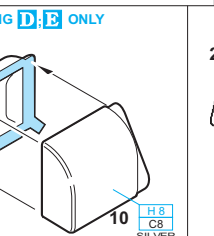
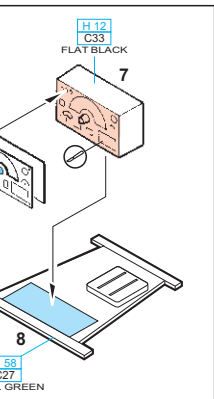
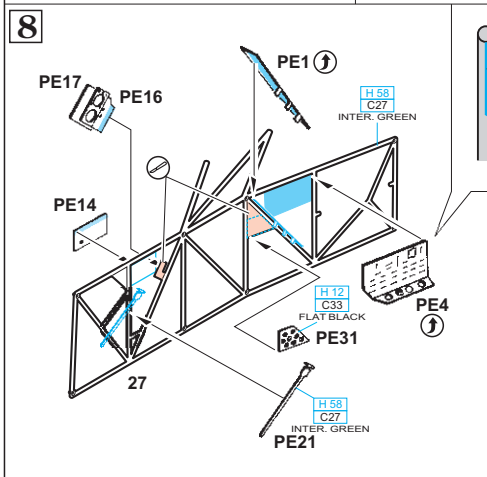
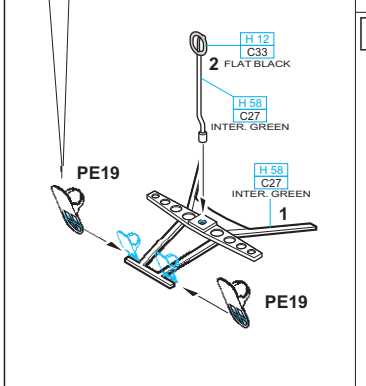
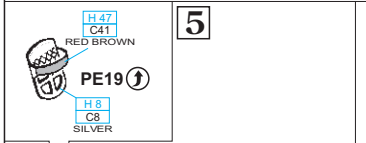
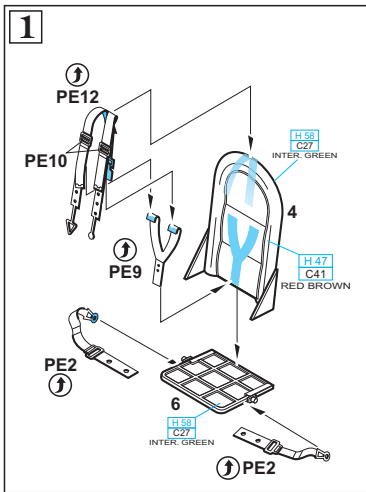

10

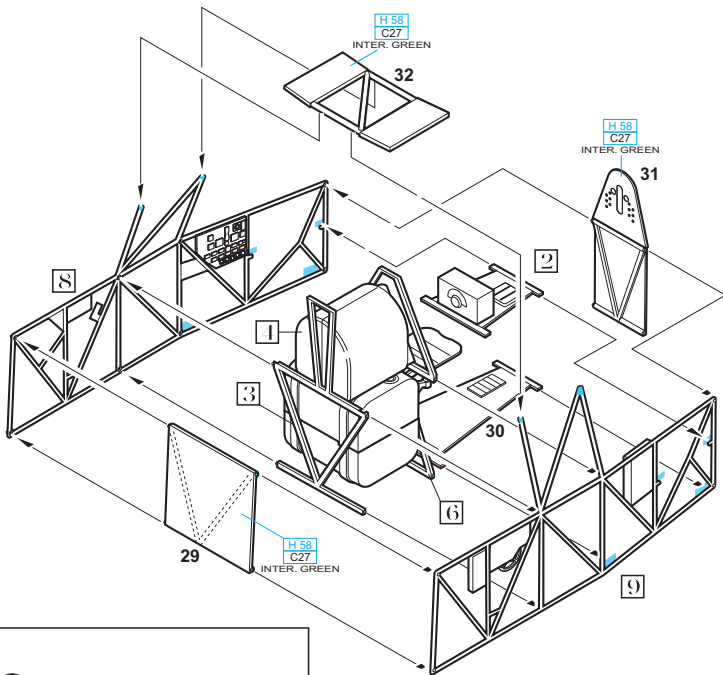

11

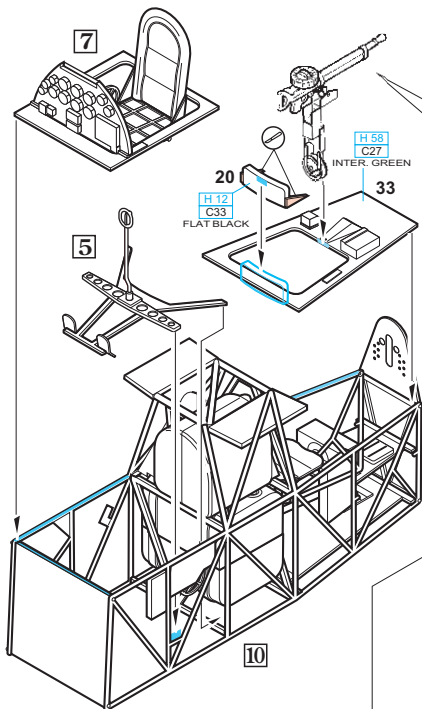

MARKING C ONLY

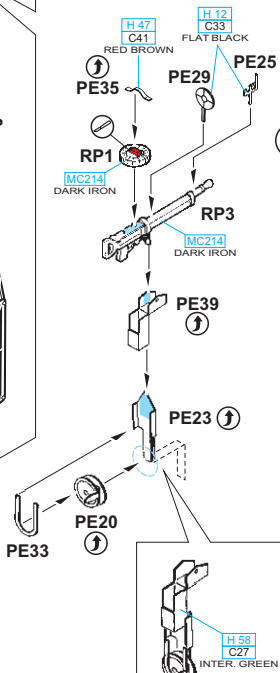

PE24



MARKING A/B ONLY

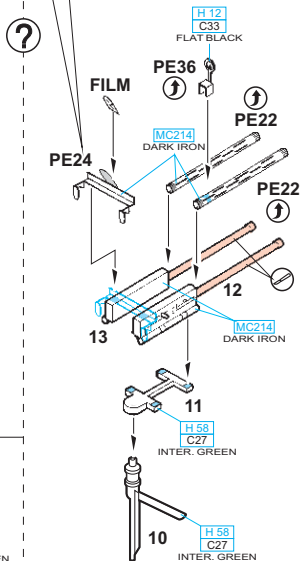

14

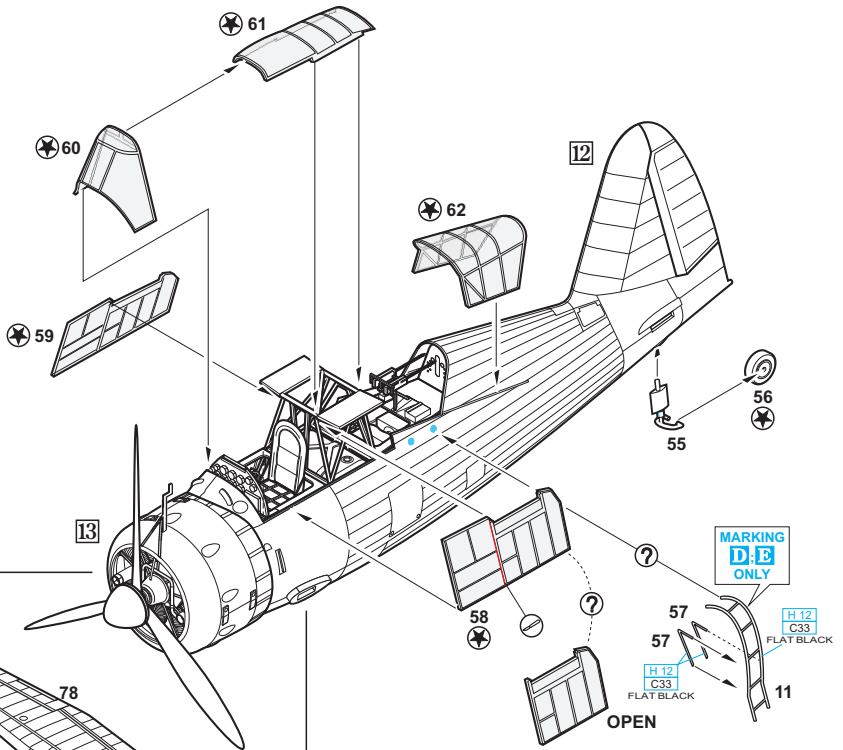

15

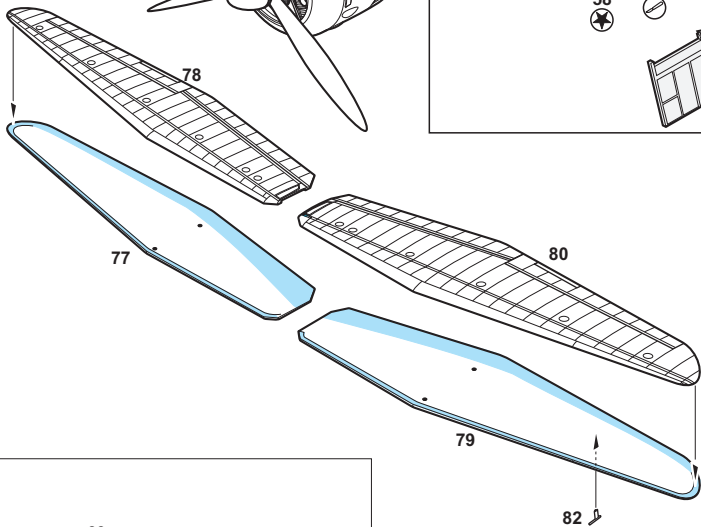

16

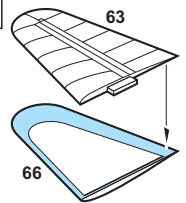

17

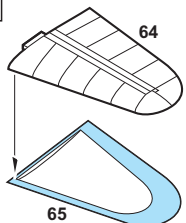

18

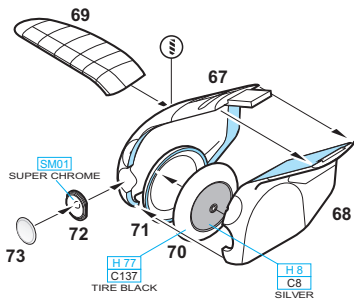

19

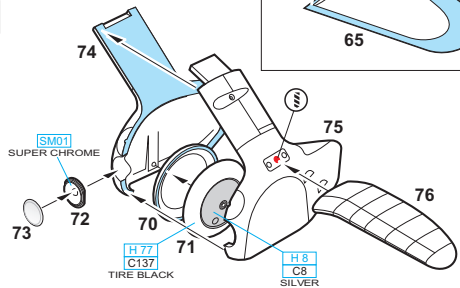

20

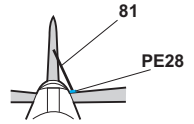
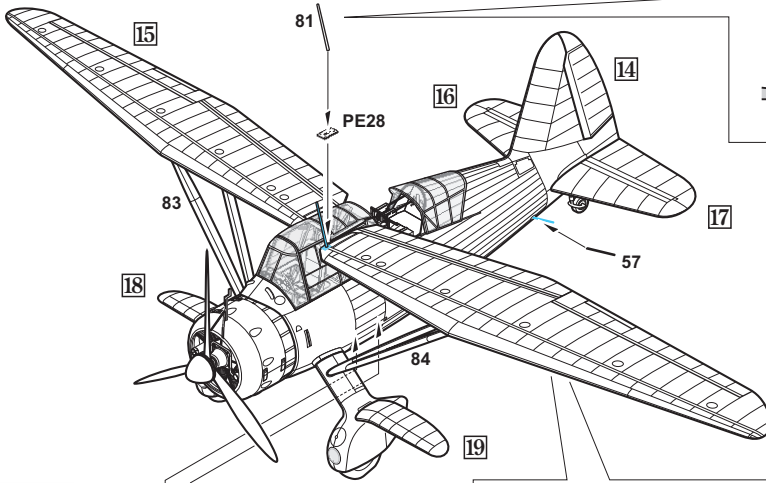

MARKING
D-E
ONLY

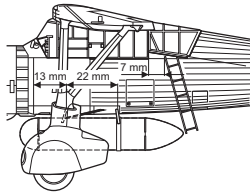
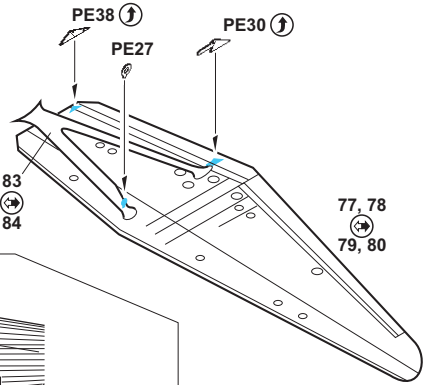
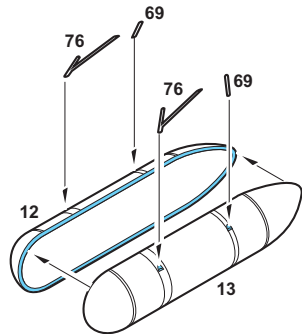
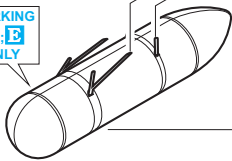

eduard
MASK

8290

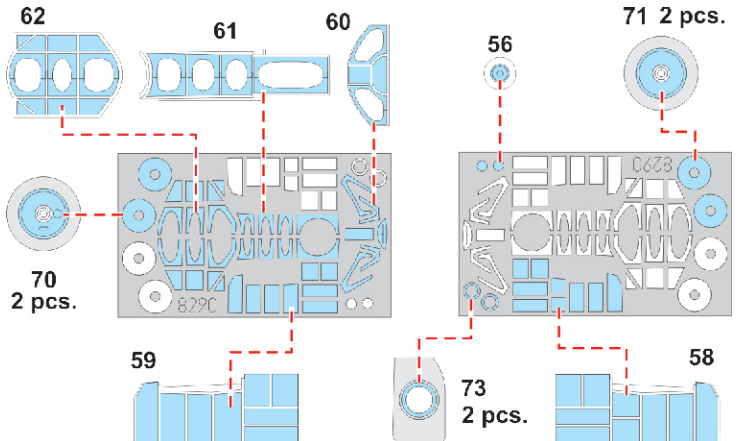

A Lysander Mk.IIIA, V9437, No. 309 Squadron RAF, Dunino Airfield, Scotland, 1942

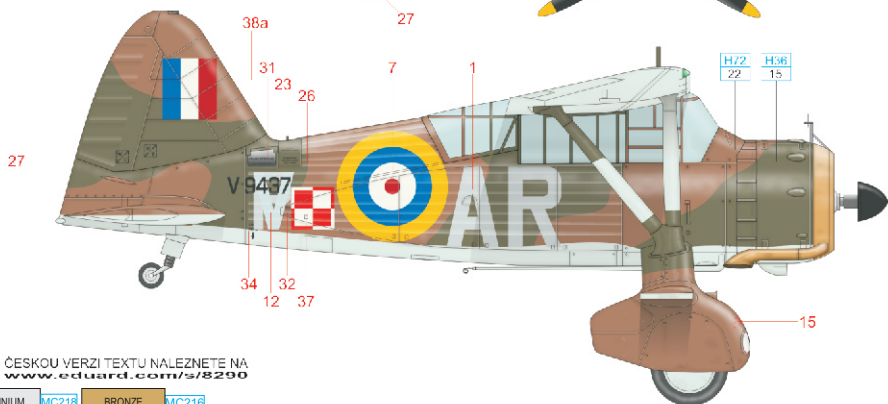
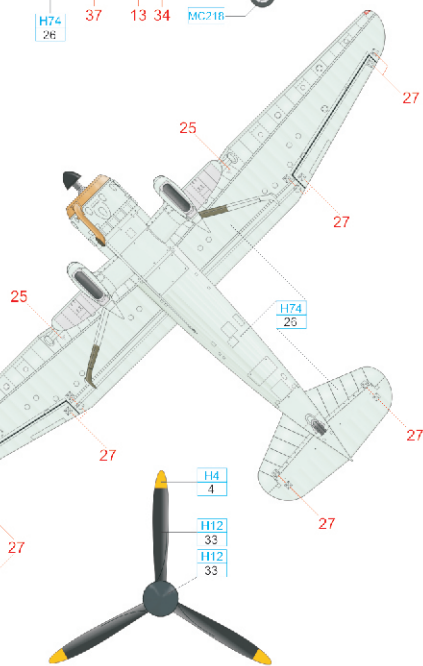
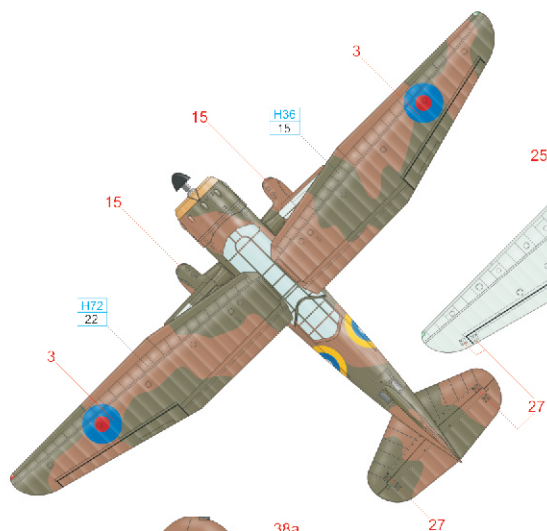
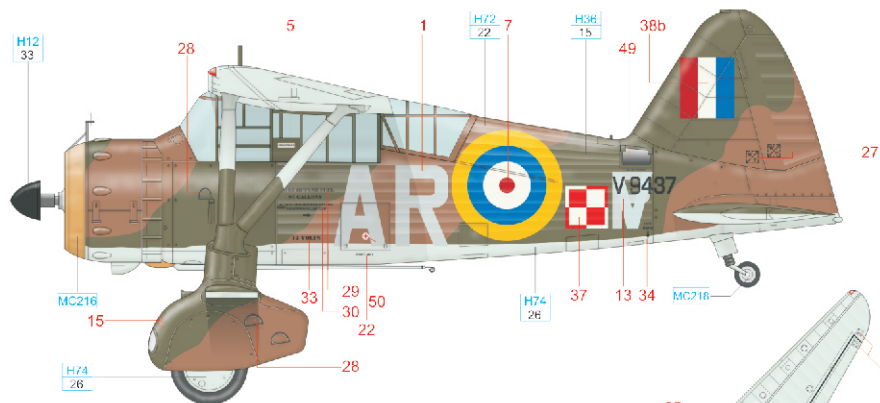

ČESKOU VERZI TEXTU NALEZNETE NA www.eduard.com/s/8290

ALUMINIUM MC216 BRONZE MC216

YELLOW H4 4 SKY H74 26 GREEN H36 15 DARK EARTH H72 22 BLACK H12 33

eduard

B Lysander Mk.IIIA, V9374, No. 613 Squadron RAF, Great Britain, 1941



ČESKOU VERZI TEXTU NALEZNETE NA www.eduard.com/s/8290

ALUMINIUM MC216 BRONZE MC216

YELLOW H4 4 SKY H74 26 GREEN H36 15 DARK EARTH H72 22 BLACK H12 33

C Lysander Mk.III, T1429, No. 26 Squadron RAF, Gatwick AB, 1940/41



ČESKOU VERZI TEXTU NALEZNETE NA
www.eduard.com/s/8290

ALUMINIUM MC218 BRONZE MC216

YELLOW H4 4 SKY H74 26 GREEN H36 15 DARK EARTH H72 22 BLACK H12 33

eduard

D Lysander Mk.III SCW, V9287, No. 161 (SD) Squadron RAF, Tempsford AB, 1942

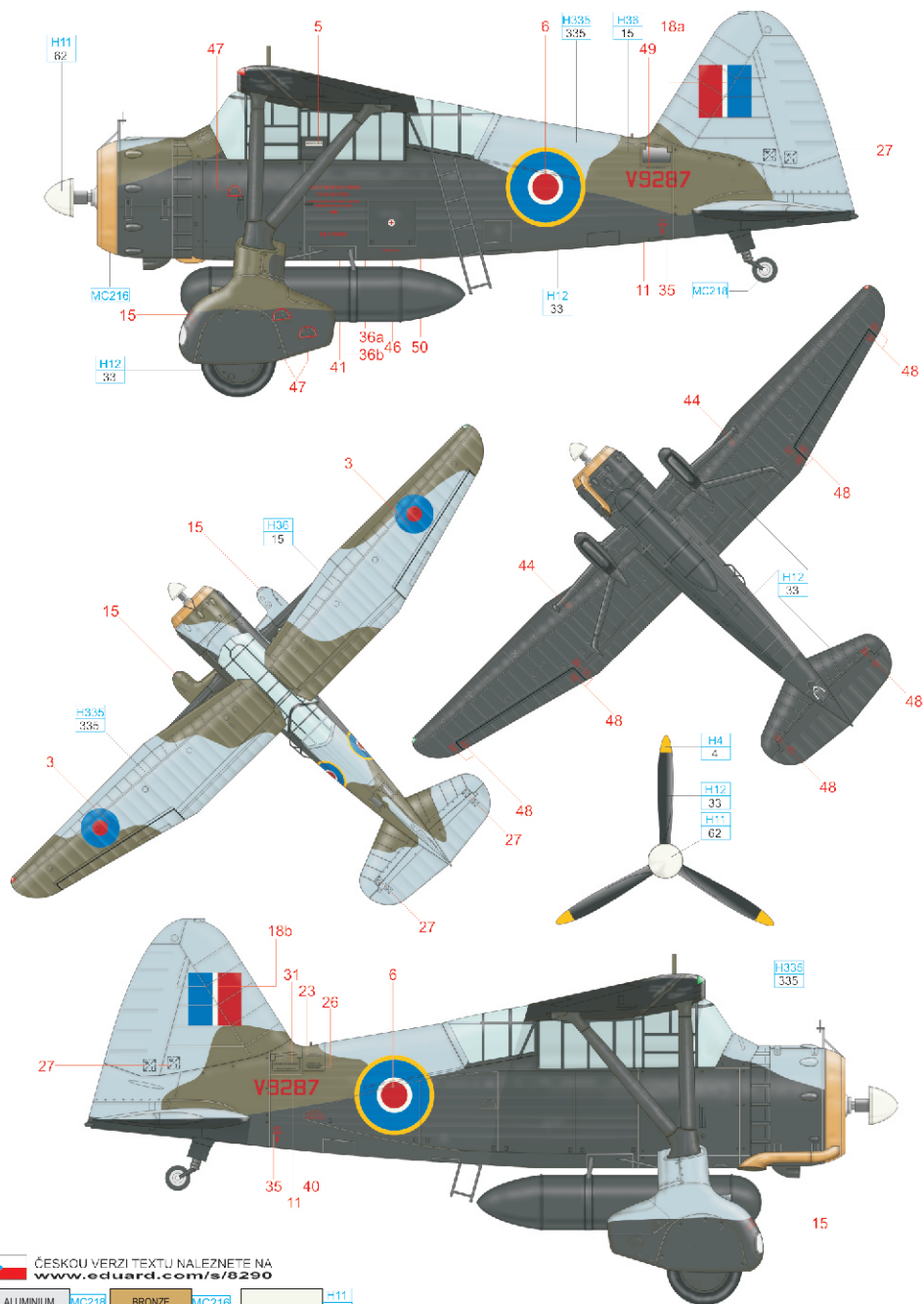

ČESKOU VERZI TEXTU NALEZNETE NA
www.eduard.com/s/6290

ALUMINIUM	MC218	BRONZE	MC218	WHITE	H11 62
YELLOW	H4 4	MEDIUM SEA GREY	H335 335	GREEN	H36 15
				BLACK	H12 33

E Lysander Mk.III SCW, V9367, No. 161 (SD) Squadron RAF, Tempsford AB, 1944



ČESKOU VERZI TEXTU NALEZNETE NA
www.eduard.com/s/8290

ALUMINIUM MC216

YELLOW H4 4

BRONZE MC216

BLACK H12 33

eduard