

eduard
MASK

EX 511

Bf 109G camo scheme - WNF

The die-cut mask for accurate camouflage painting of the
Eduard
scale 1/48 KIT

STEP 1

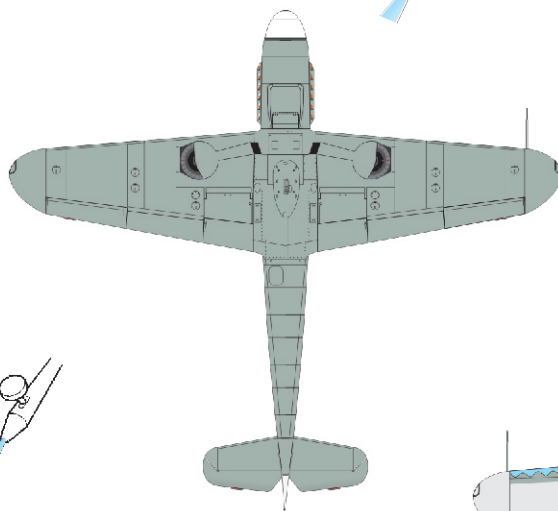

NOTE:
INSTAL EXHAUST ON PAINTED KIT

STEP 2

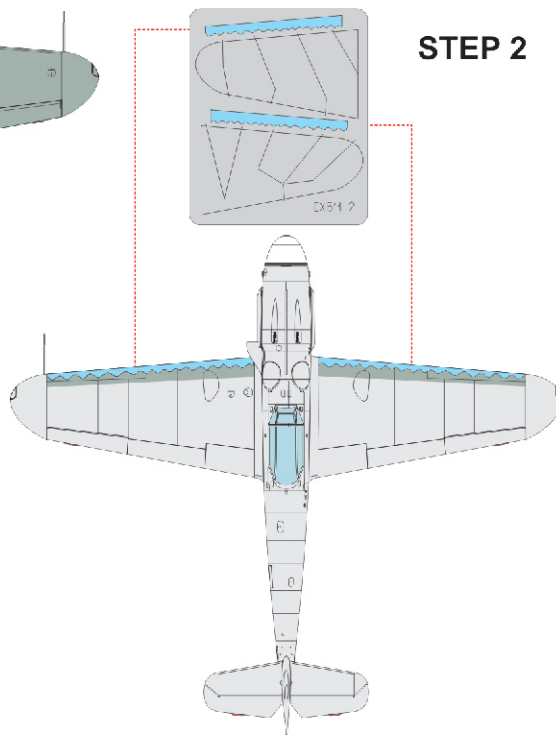

STEP 3

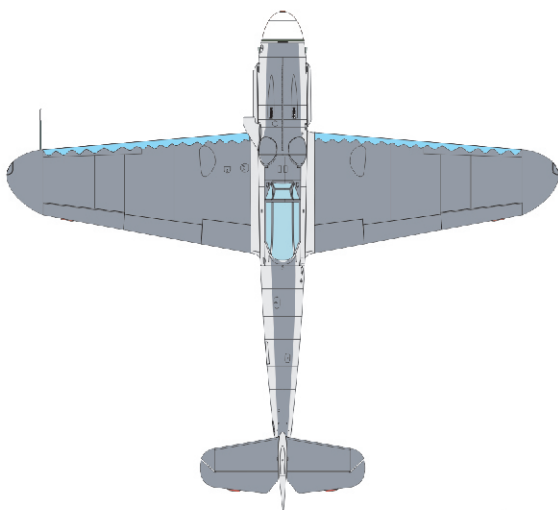

STEP 4

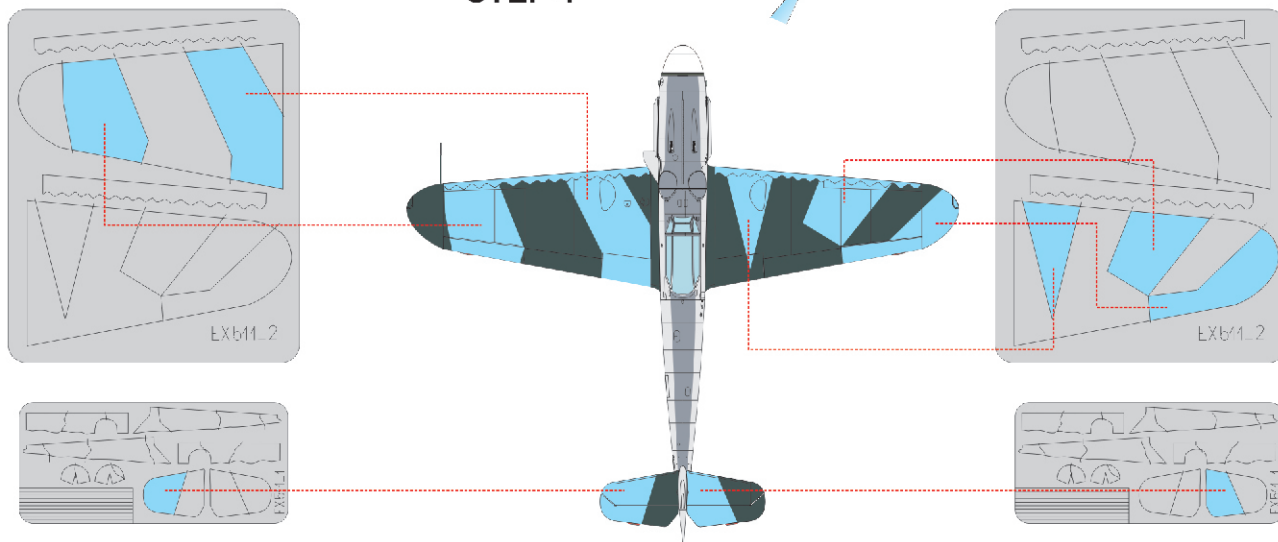

STEP 5

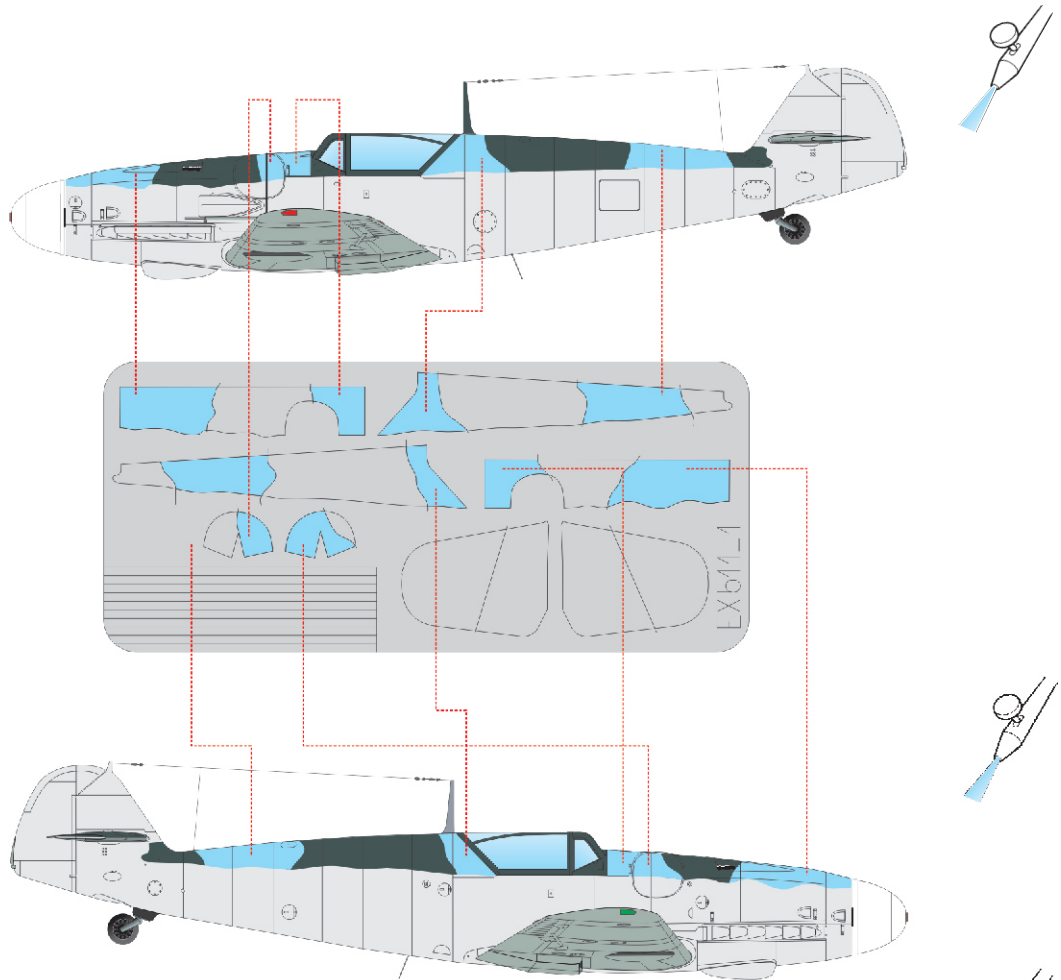

STEP 6

